

▼
ENGINEERING AND MANUFACTURING
OF INDUCTIVE COMPONENTS



ENCAPSULATED TRANSFORMERS
CATALOGUE

www.efiter.com

*C/ Taga - P.I. Talamanca (Vinyoles)
Les Masies de Voltregà (Barcelona) (Spain)*

Tel. (+34) 93 850 42 78

*Email: **comercial@efiter.com***



ENCAPSULATED TRANSFORMERS CATALOGUE

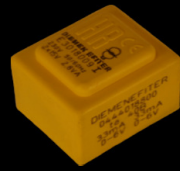

www.efiter.com

Series Index

MINI SERIES.

Designed for low power and miniature products.

- **E20 SERIES. 0.35-0.6VA**

E SERIES. Standard series.

Designed for wide range of power and limited space. E series with fixing holes when they are necessaries.

- **E30 SERIES. 0.5-3.2VA**
- **E38 SERIES. 1.8-6VA**
- **E42 SERIES. 2.7-7.5VA**
- **E48 SERIES. 8-12VA**
- **E54 SERIES 13-16VA**
- **E60 SERIES. 20-35VA**

U SERIES. Ultra flat series.

Designed for wide range of power and limited height.

- **U30 SERIES. 2.4-10VA**
- **U39 SERIES. 8-30VA**

According to EN 61558, EN 60950, EN 60065, Directive 2002/95/CE(RoHS), EN60472, U.L.506, UL5085, UL1585. UL/VDE/ENEC certifications available for most of these series

Non-standard transformers on request.

TECHNICAL SPECIFICATIONS

Plastic material : Self-extinguishing UL94V0, two compartments bobbins

Impregnation: Epoxi resin class B self-extinguishing UL 94-V0

Encapsulated process resin: Vacuum

Copper Wire: Grade 2 isolation type

Thermal class materials: B130°C/266°F – F155°C/311°F (optional)

Dielectric stenght Pri/Sec \geq 5KV/1 min

Creepage lines and clearances: According to regulation IEC EN60950, EN 61558, EN 60335

Connection pins: Lead free



E2006 (EI 20/6,1)

0,4VA - Ta40°B

weight - 25gr.

www.efiter.com



ENCAPSULATED TRANSFORMERS

According EN61558, EN60590, EN60472, UL506, UL1585, UL5085 · Short circuit proof

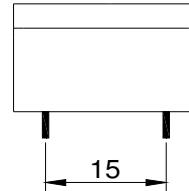
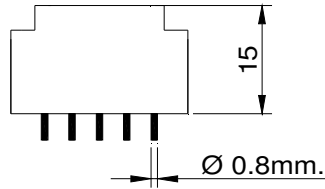

SINGLE SECONDARY, 0,4VA. Ta°40B

| HR REFERENCE | | Vo/Vsec=1,7 Vo --> Is=0 Vsec --> Isec=In | | Protection |
|--------------|------------|---|------|---------------------|
| Prim. 230V | Prim. 115V | Vsec | Isec | |
| E2006014 | E2006114 | 4,5V | 88mA | Short circuit proof |
| E2006000 | E2006100 | 6V | 66mA | |
| E2006002 | E2006102 | 7,5V | 53mA | |
| E2006004 | E2006104 | 9V | 44mA | |
| E2006006 | E2006106 | 12V | 33mA | |
| E2006008 | E2006108 | 15V | 26mA | |
| E2006010 | E2006110 | 18V | 22mA | |
| E2006012 | E2006112 | 24V | 16mA | |

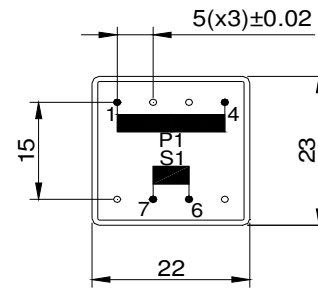

DUAL SECONDARY, 0,4VA. Ta°40B

| HR REFERENCE | | Vo/Vsec=1,7 Vo --> Is=0 Vsec --> Isec=In | | Protection |
|--------------|------------|---|--------|---------------------|
| Prim. 230V | Prim. 115V | Vsec | Isec | |
| E2006015 | E2006115 | 2x4,5V | 2x44mA | Short circuit proof |
| E2006001 | E2006101 | 2x6V | 2x33mA | |
| E2006003 | E2006103 | 2x7,5V | 2x26mA | |
| E2006005 | E2006105 | 2x9V | 2x22mA | |
| E2006007 | E2006107 | 2x12V | 2x16mA | |
| E2006009 | E2006109 | 2x15V | 2x13mA | |
| E2006011 | E2006111 | 2x18V | 2x11mA | |
| E2006013 | E2006113 | 2x24V | 2x8mA | |

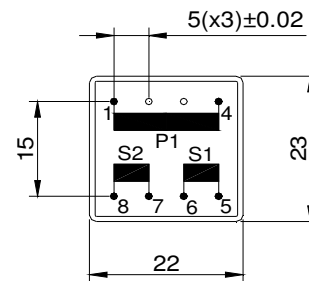

These models are non VDE approved. Even so, they meet all requirements of EN61558-2-4, EN61558-2-6



E2006 (EI 20/6,1)

0,35VA - Ta70°B

weight - 25gr.



www.efiter.com

ENCAPSULATED TRANSFORMERS

According EN61558, EN60590, EN60472, UL506, UL1585, UL5085 · Short circuit proof

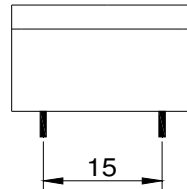
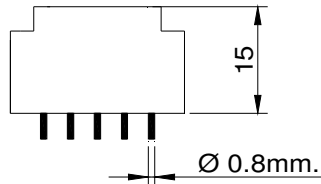

SINGLE SECONDARY, 0,35VA. Ta°70B

| HR REFERENCE | | Vo/Vsec=1,7 Vo --> Is=0 Vsec --> Isec=In | | Protection |
|--------------|------------|---|------|---------------------|
| Prim. 230V | Prim. 115V | Vsec | Isec | |
| E2006064 | E2006164 | 4,5V | 77mA | Short circuit proof |
| E2006050 | E2006150 | 6V | 58mA | |
| E2006052 | E2006152 | 7,5V | 46mA | |
| E2006054 | E2006154 | 9V | 38mA | |
| E2006056 | E2006156 | 12V | 29mA | |
| E2006058 | E2006158 | 15V | 23mA | |
| E2006060 | E2006160 | 18V | 19mA | |
| E2006062 | E2006162 | 24V | 14mA | |

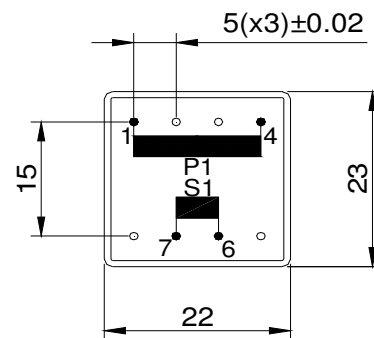

DUAL SECONDARY, 0,35VA. Ta°70B

| HR REFERENCE | | Vo/Vsec=1,7 Vo --> Is=0 Vsec --> Isec=In | | Protection |
|--------------|------------|---|--------|---------------------|
| Prim. 230V | Prim. 115V | Vsec | Isec | |
| E2006065 | E2006165 | 2x4,5V | 2x38mA | Short circuit proof |
| E2006051 | E2006151 | 2x6V | 2x29mA | |
| E2006053 | E2006153 | 2x7,5V | 2x23mA | |
| E2006055 | E2006155 | 2x9V | 2x19mA | |
| E2006057 | E2006159 | 2x12V | 2x14mA | |
| E2006059 | E2006159 | 2x15V | 2x11mA | |
| E2006061 | E2006161 | 2x18V | 2x9mA | |
| E2006063 | E2006163 | 2x24V | 2x7mA | |

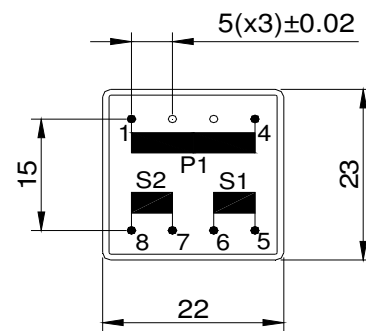

These models are non VDE approved. Even so, they meet all requirements of EN61558-2-4, EN61558-2-6



E2010 (EI 20/10,5)

0,6VA - Ta40°C

weight - 40gr.

www.efiter.com



ENCAPSULATED TRANSFORMERS

According EN61558, EN60590, EN60472, UL506, UL1585, UL5085 · Short circuit proof

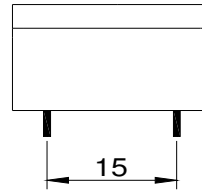
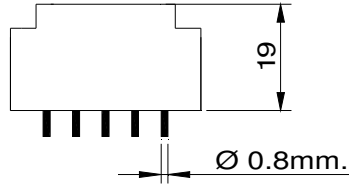

SINGLE SECONDARY, 0,6VA. Ta40°C

| HR REFERENCE | | Vo/Vsec=1,7 Vo --> Is=0 Vsec --> Isec=In | | Protection |
|--------------|------------|---|-------|---------------------|
| Prim. 230V | Prim. 115V | Vsec | Isec | |
| E2010014 | E2010114 | 4,5V | 133mA | Short circuit proof |
| E2010000 | E2010100 | 6V | 100mA | |
| E2010002 | E2010102 | 7,5V | 80mA | |
| E2010004 | E2010104 | 9V | 66mA | |
| E2010006 | E2010106 | 12V | 50mA | |
| E2010008 | E2010108 | 15V | 40mA | |
| E2010010 | E2010110 | 18V | 33mA | |
| E2010012 | E2010112 | 24V | 25mA | |

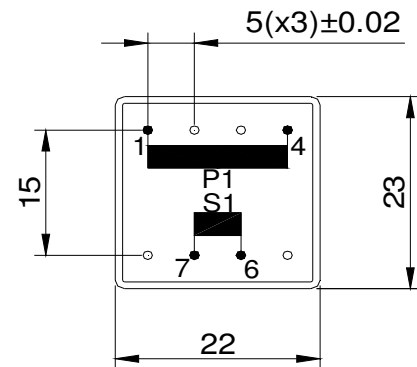

DUAL SECONDARY, 0,6VA. Ta40°C

| HR REFERENCE | | Vo/Vsec=1,7 Vo --> Is=0 Vsec --> Isec=In | | Protection |
|--------------|------------|---|--------|---------------------|
| Prim. 230V | Prim. 115V | Vsec | Isec | |
| E2010015 | E2010115 | 2x4,5V | 2x66mA | Short circuit proof |
| E2010001 | E2010101 | 2x6V | 2x50mA | |
| E2010003 | E2010103 | 2x7,5V | 2x40mA | |
| E2010005 | E2010105 | 2x9V | 2x33mA | |
| E2010007 | E2010107 | 2x12V | 2x25mA | |
| E2010009 | E2010109 | 2x15V | 2x20mA | |
| E2010011 | E2010111 | 2x18V | 2x16mA | |
| E2010013 | E2010113 | 2x24V | 2x12mA | |

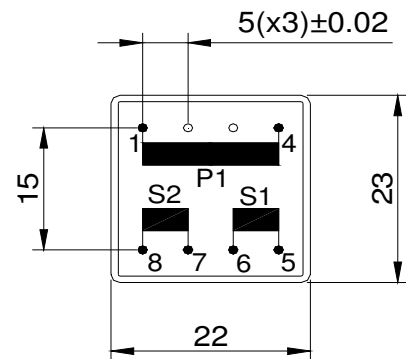

These models are non VDE approved. Even so, they meet all requirements of EN61558-2-4, EN61558-2-6



E2010 (EI 20/10,5)

0,5VA - Ta70°B

weight - 40gr.

www.efiter.com



ENCAPSULATED TRANSFORMERS

According EN61558, EN60590, EN60472, UL506, UL1585, UL5085 · Short circuit proof

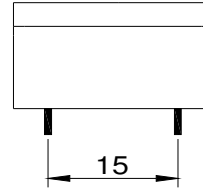
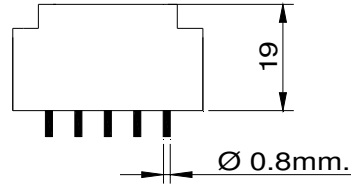

SINGLE SECONDARY, 0,5VA. Ta°70B

| HR REFERENCE | | Vo/Vsec=1,7 Vo --> Is=0 Vsec --> Isec=In | | Protection |
|--------------|------------|---|-------|---------------------|
| Prim. 230V | Prim. 115V | Vsec | Isec | |
| E2010064 | E2010164* | 4,5V | 111mA | Short circuit proof |
| E2010050 | E2010150* | 6V | 83mA | |
| E2010052 | E2010152* | 7,5V | 66mA | |
| E2010054 | E2010154* | 9V | 55mA | |
| E2010056 | E2010156* | 12V | 41mA | |
| E2010058 | E2010158* | 15V | 33mA | |
| E2010060 | E2010160* | 18V | 27mA | |
| E2010062 | E2010162* | 24V | 20mA | |

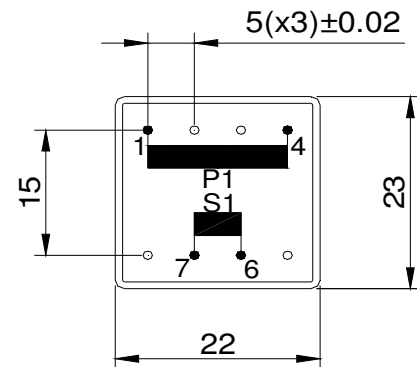

DUAL SECONDARY, 0,5VA. Ta°70B

| HR REFERENCE | | Vo/Vsec=1,7 Vo --> Is=0 Vsec --> Isec=In | | Protection |
|--------------|------------|---|--------|---------------------|
| Prim. 230V | Prim. 115V | Vsec | Isec | |
| E2010065 | E2010165* | 2x4,5V | 2x55mA | Short circuit proof |
| E2010051 | E2010151* | 2x6V | 2x41mA | |
| E2010053 | E2010153* | 2x7,5V | 2x33mA | |
| E2010055 | E2010155* | 2x9V | 2x27mA | |
| E2010057 | E2010157* | 2x12V | 2x20mA | |
| E2010059 | E2010159* | 2x15V | 2x16mA | |
| E2010061* | E2010161* | 2x18V | 2x13mA | |
| E2010063* | E2010163* | 2x24V | 2x10mA | |



* these models are non VDE approved. Even so, they meet all requirements of EN61558-2-4, EN61558-2-6



E3005 (EI 30/5)

0,6VA - Ta40°C

weight - 45gr.

www.efiter.com



ENCAPSULATED TRANSFORMERS

According EN61558, EN60590, EN60472, UL506, UL1585, UL5085 · Short circuit proof

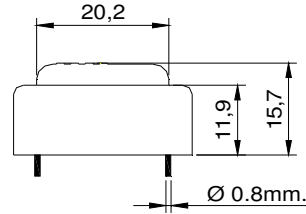
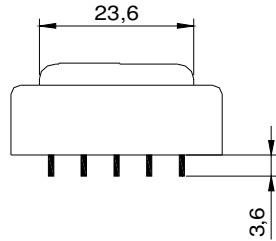

SINGLE SECONDARY, 0,6VA. Ta40°C

| HR REFERENCE | | Vo/Vsec=1,7 Vo --> Is=0 Vsec --> Isec=In | | Protection |
|--------------|------------|---|-------|---------------------|
| Prim. 230V | Prim. 115V | Vsec | Isec | |
| E3005014 | E3005114 | 4,5V | 133mA | Short circuit proof |
| E3005000 | E3005100 | 6V | 100mA | |
| E3005002 | E3005102 | 7,5V | 80mA | |
| E3005004 | E3005104 | 9V | 66mA | |
| E3005006 | E3005106 | 12V | 50mA | |
| E3005008 | E3005108 | 15V | 40mA | |
| E3005010 | E3005110 | 18V | 33mA | |
| E3005012 | E3005112 | 24V | 25mA | |

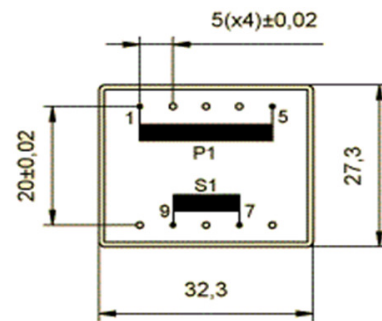

DUAL SECONDARY, 0,6VA. Ta40°C

| HR REFERENCE | | Vo/Vsec=1,7 Vo --> Is=0 Vsec --> Isec=In | | Protection |
|--------------|------------|---|--------|---------------------|
| Prim. 230V | Prim. 115V | Vsec | Isec | |
| E3005015 | E3005115 | 2x4,5V | 2x66mA | Short circuit proof |
| E3005001 | E3005101 | 2x6V | 2x50mA | |
| E3005003 | E3005103 | 2x7,5V | 2x40mA | |
| E3005005 | E3005105 | 2x9V | 2x33mA | |
| E3005007 | E3005107 | 2x12V | 2x25mA | |
| E3005009 | E3005109 | 2x15V | 2x20mA | |
| E3005011 | E3005111 | 2x18V | 2x16mA | |
| E3005013 | E3005113 | 2x24V | 2x12mA | |

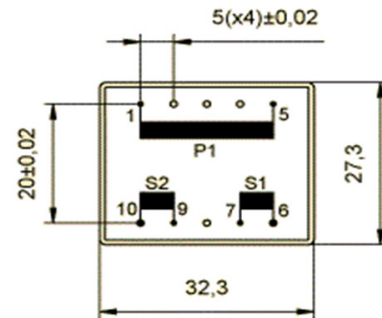

CENTER TAPPED, 0,6VA. Ta40°C

| HR REFERENCE | | Vo/Vsec=1,7 Vo --> Is=0 Vsec --> Isec=In | | Protection |
|--------------|------------|---|--------|---------------------|
| Prim. 230V | Prim. 115V | Vsec | Isec | |
| E3005035 | E3005135 | 2x4,5V | 2x66mA | Short circuit proof |
| E3005021 | E3005121 | 2x6V | 2x50mA | |
| E3005023 | E3005123 | 2x7,5V | 2x40mA | |
| E3005025 | E3005125 | 2x9V | 2x33mA | |
| E3005027 | E3005127 | 2x12V | 2x25mA | |
| E3005029 | E3005129 | 2x15V | 2x20mA | |
| E3005031 | E3005131 | 2x18V | 2x16mA | |
| E3005033 | E3005133 | 2x24V | 2x12mA | |

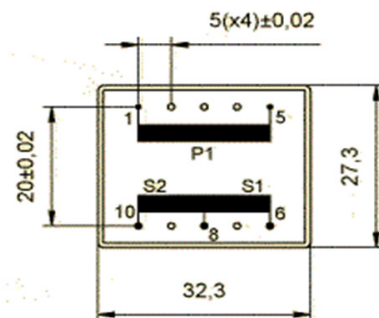

These models are non VDE approved. Even so, they meet all requirements of EN61558-2-4, EN61558-2-6



E3005 (EI 30/5)

0,5VA - Ta70°B

weight - 45gr.

www.efiter.com



ENCAPSULATED TRANSFORMERS

According EN61558, EN60590, EN60472, UL506, UL1585, UL5085 · Short circuit proof

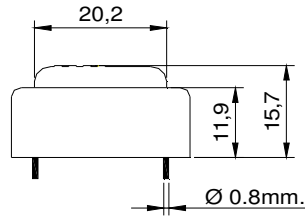
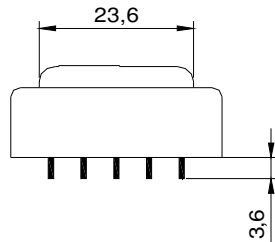

SINGLE SECONDARY, 0,5VA. Ta°70B

| HR REFERENCE | | Vo/Vsec=1,7 Vo --> Is=0 Vsec --> Isec=In | | Protection |
|--------------|------------|---|-------|---------------------|
| Prim. 230V | Prim. 115V | Vsec | Isec | |
| E3005064 | E3005164 | 4,5V | 111mA | Short circuit proof |
| E3005050 | E3005150 | 6V | 83mA | |
| E3005052 | E3005152 | 7,5V | 66mA | |
| E3005054 | E3005154 | 9V | 55mA | |
| E3005056 | E3005156 | 12V | 41mA | |
| E3005058 | E3005158 | 15V | 33mA | |
| E3005060 | E3005160 | 18V | 27mA | |
| E3005062 | E3005162 | 24V | 20mA | |

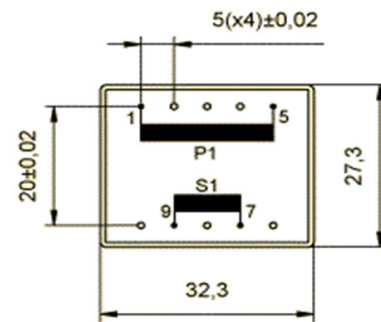

DUAL SECONDARY, 0,5VA. Ta°70B

| HR REFERENCE | | Vo/Vsec=1,7 Vo --> Is=0 Vsec --> Isec=In | | Protection |
|--------------|------------|---|--------|---------------------|
| Prim. 230V | Prim. 115V | Vsec | Isec | |
| E3005065 | E3005165 | 2x4,5V | 2x55mA | Short circuit proof |
| E3005051 | E3005151 | 2x6V | 2x41mA | |
| E3005053 | E3005153 | 2x7,5V | 2x33mA | |
| E3005055 | E3005155 | 2x9V | 2x27mA | |
| E3005057 | E3005157 | 2x12V | 2x20mA | |
| E3005059 | E3005159 | 2x15V | 2x16mA | |
| E3005061 | E3005161 | 2x18V | 2x13mA | |
| E3005063 | E3005163 | 2x24V | 2x10mA | |

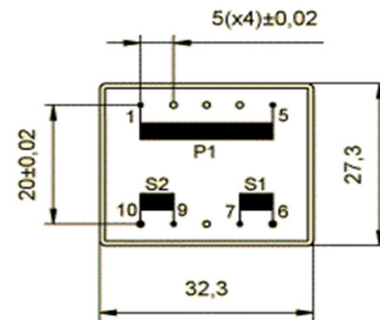

CENTER TAPPED, 0,5VA. Ta°70B

| HR REFERENCE | | Vo/Vsec=1,7 Vo --> Is=0 Vsec --> Isec=In | | Protection |
|--------------|------------|---|--------|---------------------|
| Prim. 230V | Prim. 115V | Vsec | Isec | |
| E3005085 | E3005185 | 2x4,5V | 2x55mA | Short circuit proof |
| E3005071 | E3005171 | 2x6V | 2x41mA | |
| E3005073 | E3005173 | 2x7,5V | 2x33mA | |
| E3005075 | E3005175 | 2x9V | 2x27mA | |
| E3005077 | E3005177 | 2x12V | 2x20mA | |
| E3005079 | E3005179 | 2x15V | 2x16mA | |
| E3005081 | E3005181 | 2x18V | 2x13mA | |
| E3005083 | E3005183 | 2x24V | 2x10mA | |

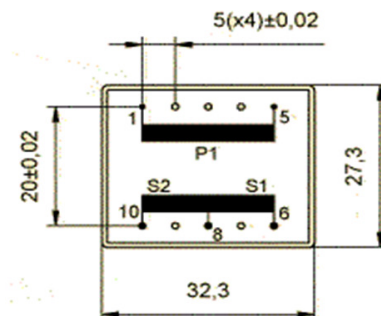

These models are non VDE approved. Even so, they meet all requirements of EN61558-2-4, EN61558-2-6



E3011 (EI 30/10,5)

1,5VA - Ta40°B

weight - 75gr.

www.efiter.com



ENCAPSULATED TRANSFORMERS

According EN61558, EN60590, EN60472, UL506, UL1585, UL5085 · Short circuit proof

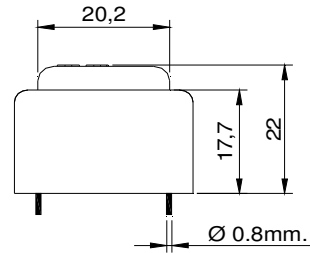
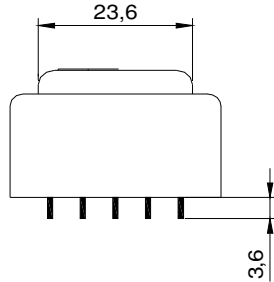

SINGLE SECONDARY, 1,5VA. Ta°40B

| HR REFERENCE | | Vo/Vsec=1,7 Vo --> Is=0 Vsec --> Isec=In | | Protection |
|--------------|------------|---|-------|---------------------|
| Prim. 230V | Prim. 115V | Vsec | Isec | |
| E3011014 | E3011114 | 4,5V | 333mA | Short circuit proof |
| E3011000 | E3011100 | 6V | 250mA | |
| E3011002 | E3011102 | 7,5V | 200mA | |
| E3011004 | E3011104 | 9V | 166mA | |
| E3011006 | E3011106 | 12V | 125mA | |
| E3011008 | E3011108 | 15V | 100mA | |
| E3011010 | E3011110 | 18V | 83mA | |
| E3011012 | E3011112 | 24V | 62mA | |

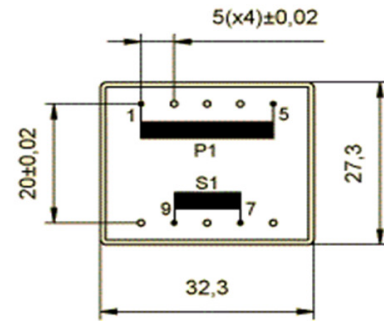

DUAL SECONDARY, 1,5VA. Ta°40B

| HR REFERENCE | | Vo/Vsec=1,7 Vo --> Is=0 Vsec --> Isec=In | | Protection |
|--------------|------------|---|---------|---------------------|
| Prim. 230V | Prim. 115V | Vsec | Isec | |
| E3011015 | E3011115 | 2x4,5V | 2x166mA | Short circuit proof |
| E3011001 | E3011101 | 2x6V | 2x125mA | |
| E3011003 | E3011103 | 2x7,5V | 2x100mA | |
| E3011005 | E3011105 | 2x9V | 2x83mA | |
| E3011007 | E3011107 | 2x12V | 2x62mA | |
| E3011009 | E3011109 | 2x15V | 2x50mA | |
| E3011011 | E3011111 | 2x18V | 2x41mA | |
| E3011013 | E3011113 | 2x24V | 2x31mA | |

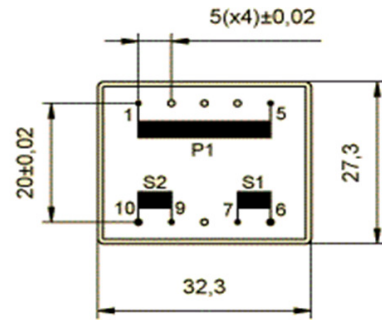

CENTER TAPPED, 1,5VA. Ta°40B

| HR REFERENCE | | Vo/Vsec=1,7 Vo --> Is=0 Vsec --> Isec=In | | Protection |
|--------------|------------|---|---------|---------------------|
| Prim. 230V | Prim. 115V | Vsec | Isec | |
| E3011035 | E3011135 | 2x4,5V | 2x166mA | Short circuit proof |
| E3011021 | E3011121 | 2x6V | 2x125mA | |
| E3011023 | E3011123 | 2x7,5V | 2x100mA | |
| E3011025 | E3011125 | 2x9V | 2x83mA | |
| E3011027 | E3011127 | 2x12V | 2x62mA | |
| E3011029 | E3011129 | 2x15V | 2x50mA | |
| E3011031 | E3011131 | 2x18V | 2x41mA | |
| E3011033 | E3011133 | 2x24V | 2x31mA | |

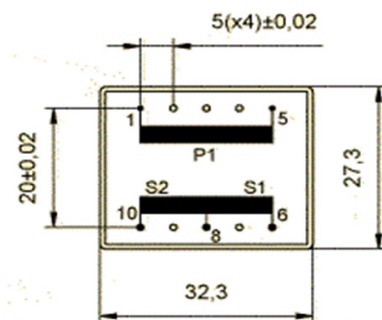

These models are non VDE approved. Even so, they meet all requirements of EN61558-2-4, EN61558-2-6



E3011 (EI 30/10,5)

1,2VA - Ta70°B

weight - 75gr.

www.efiter.com



ENCAPSULATED TRANSFORMERS

According EN61558, EN60590, EN60472, UL506, UL1585, UL5085 · Short circuit proof

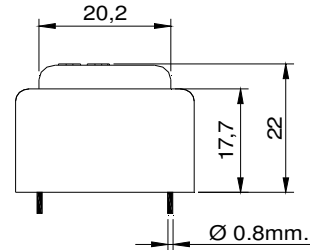
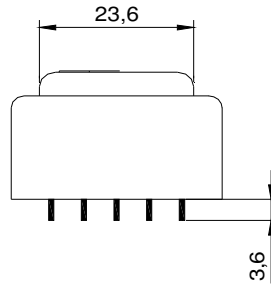

SINGLE SECONDARY, 1,2VA. Ta°70B

| HR REFERENCE | | Vo/Vsec=1,7 Vo --> Is=0 Vsec --> Isec=In | | Protection |
|--------------|------------|---|-------|---------------------|
| Prim. 230V | Prim. 115V | Vsec | Isec | |
| E3011064 | E3011164* | 4,5V | 266mA | Short circuit proof |
| E3011050 | E3011150* | 6V | 200mA | |
| E3011052 | E3011152* | 7,5V | 160mA | |
| E3011054 | E3011154* | 9V | 133mA | |
| E3011056 | E3011156* | 12V | 100mA | |
| E3011058 | E3011158* | 15V | 80mA | |
| E3011060 | E3011160* | 18V | 66mA | |
| E3011062 | E3011162* | 24V | 50mA | |

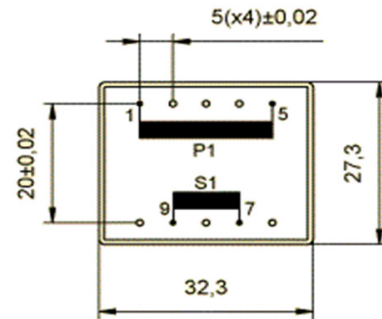

DUAL SECONDARY, 1,2VA. Ta°70B

| HR REFERENCE | | Vo/Vsec=1,7 Vo --> Is=0 Vsec --> Isec=In | | Protection |
|--------------|------------|---|---------|---------------------|
| Prim. 230V | Prim. 115V | Vsec | Isec | |
| E3011065 | E3011165* | 2x4,5V | 2x133mA | Short circuit proof |
| E3011051 | E3011151* | 2x6V | 2x100mA | |
| E3011053 | E3011153* | 2x7,5V | 2x80mA | |
| E3011055 | E3011155* | 2x9V | 2x66mA | |
| E3011057 | E3011157* | 2x12V | 2x50mA | |
| E3011059 | E3011159* | 2x15V | 2x40mA | |
| E3011061* | E3011161* | 2x18V | 2x33mA | |
| E3011063* | E3011163* | 2x24V | 2x25mA | |

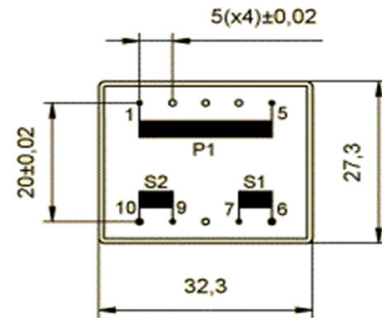

CENTER TAPPED, 1,2VA. Ta°70B

| HR REFERENCE | | Vo/Vsec=1,7 Vo --> Is=0 Vsec --> Isec=In | | Protection |
|--------------|------------|---|---------|---------------------|
| Prim. 230V | Prim. 115V | Vsec | Isec | |
| E3011085 | E3011185* | 2x4,5V | 2x133mA | Short circuit proof |
| E3011071 | E3011171* | 2x6V | 2x100mA | |
| E3011073 | E3011173* | 2x7,5V | 2x80mA | |
| E3011075 | E3011175* | 2x9V | 2x66mA | |
| E3011077 | E3011177* | 2x12V | 2x50mA | |
| E3011079 | E3011179* | 2x15V | 2x40mA | |
| E3011081* | E3011181* | 2x18V | 2x33mA | |
| E3011083* | E3011183* | 2x24V | 2x25mA | |

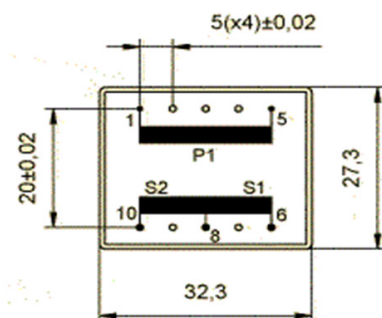

* these models are non VDE approved. Even so, they meet all requirements of EN61558-2-4, EN61558-2-6



E3011 (EI 30/10,5)

1,5VA - Ta70°B

weight - 75gr.

www.efiter.com



ENCAPSULATED TRANSFORMERS

According EN61558, EN60590, EN60472, UL506, UL1585, UL5085 · Short circuit proof

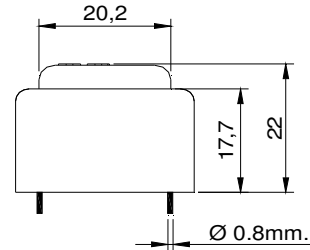
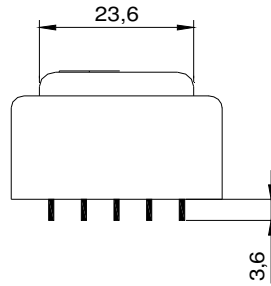

SINGLE SECONDARY, 1,5VA. Ta°70B

| HR REFERENCE | | Vo/Vsec=1,7 Vo --> Is=0 Vsec --> Isec=In | | Protection |
|--------------|------------|---|-------|---------------------|
| Prim. 230V | Prim. 115V | Vsec | Isec | |
| E3011464 | E3011564* | 4,5V | 333mA | Short circuit proof |
| E3011450 | E3011550* | 6V | 250mA | |
| E3011452 | E3011552* | 7,5V | 200mA | |
| E3011454 | E3011554* | 9V | 166mA | |
| E3011456 | E3011556* | 12V | 125mA | |
| E3011458 | E3011558* | 15V | 100mA | |
| E3011460 | E3011560* | 18V | 83mA | |
| E3011462 | E3011562* | 24V | 62mA | |

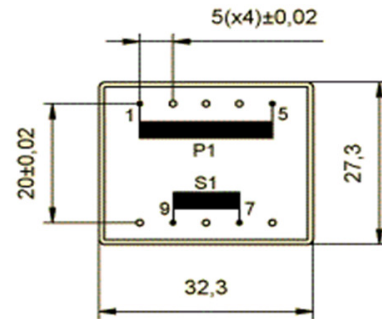

DUAL SECONDARY, 1,5VA. Ta°70B

| HR REFERENCE | | Vo/Vsec=1,7 Vo --> Is=0 Vsec --> Isec=In | | Protection |
|--------------|------------|---|---------|---------------------|
| Prim. 230V | Prim. 115V | Vsec | Isec | |
| E3011465 | E3011565* | 2x4,5V | 2x166mA | Short circuit proof |
| E3011451 | E3011551* | 2x6V | 2x125mA | |
| E3011453 | E3011553* | 2x7,5V | 2x100mA | |
| E3011455 | E3011555* | 2x9V | 2x83mA | |
| E3011457 | E3011557* | 2x12V | 2x62mA | |
| E3011459 | E3011559* | 2x15V | 2x50mA | |
| E3011461* | E3011561* | 2x18V | 2x41mA | |
| E3011463* | E3011563* | 2x24V | 2x31mA | |

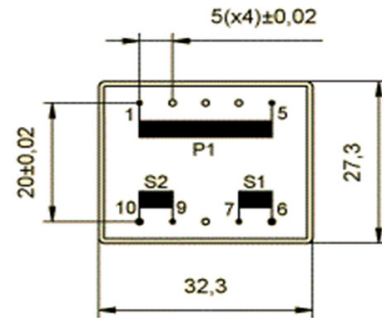

CENTER TAPPED, 1,5VA. Ta°70B

| HR REFERENCE | | Vo/Vsec=1,7 Vo --> Is=0 Vsec --> Isec=In | | Protection |
|--------------|------------|---|---------|---------------------|
| Prim. 230V | Prim. 115V | Vsec | Isec | |
| E3011485 | E3011585* | 2x4,5V | 2x166mA | Short circuit proof |
| E3011471 | E3011571* | 2x6V | 2x125mA | |
| E3011473 | E3011573* | 2x7,5V | 2x100mA | |
| E3011475 | E3011575* | 2x9V | 2x83mA | |
| E3011477 | E3011577* | 2x12V | 2x62mA | |
| E3011479 | E3011579* | 2x15V | 2x50mA | |
| E3011481* | E3011581* | 2x18V | 2x41mA | |
| E3011483* | E3011583* | 2x24V | 2x31mA | |

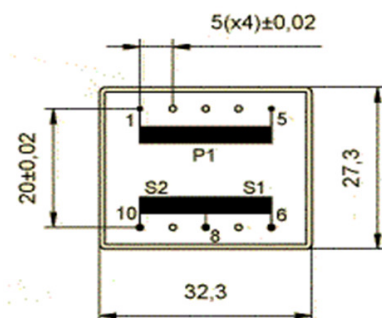

* these models are non VDE approved. Even so, they meet all requirements of EN61558-2-4, EN61558-2-6



E3013 (EI 30/12,5)

1,8VA - Ta40°B

weight - 85gr.

www.efiter.com



ENCAPSULATED TRANSFORMERS

According EN61558, EN60590, EN60472, UL506, UL1585, UL5085 · Short circuit proof

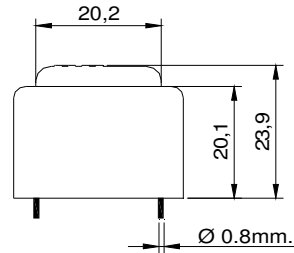
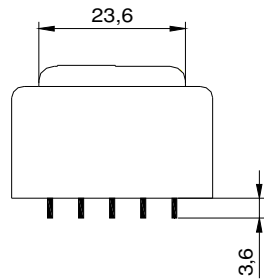

SINGLE SECONDARY, 1,8VA. Ta°40B

| HR REFERENCE | | Vo/Vsec=1,7 Vo --> Is=0 Vsec --> Isec=In | | Protection |
|--------------|------------|---|-------|---------------------|
| Prim. 230V | Prim. 115V | Vsec | Isec | |
| E3013014 | E3013114* | 4,5V | 400mA | Short circuit proof |
| E3013000 | E3013100* | 6V | 300mA | |
| E3013002 | E3013102* | 7,5V | 240mA | |
| E3013004 | E3013104* | 9V | 200mA | |
| E3013006 | E3013106* | 12V | 150mA | |
| E3013008 | E3013108* | 15V | 120mA | |
| E3013010 | E3013110* | 18V | 100mA | |
| E3013012 | E3013112* | 24V | 75mA | |

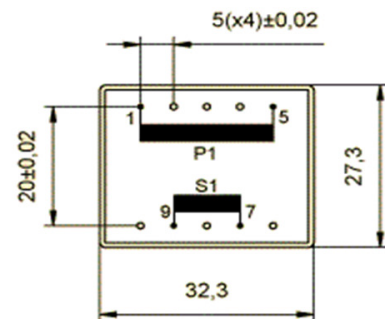

DUAL SECONDARY, 1,8VA. Ta°40B

| HR REFERENCE | | Vo/Vsec=1,7 Vo --> Is=0 Vsec --> Isec=In | | Protection |
|--------------|------------|---|---------|---------------------|
| Prim. 230V | Prim. 115V | Vsec | Isec | |
| E3013015 | E3013115* | 2x4,5V | 2x200mA | Short circuit proof |
| E3013001 | E3013101* | 2x6V | 2x150mA | |
| E3013003 | E3013103* | 2x7,5V | 2x120mA | |
| E3013005 | E3013105* | 2x9V | 2x100mA | |
| E3013007 | E3013107* | 2x12V | 2x75mA | |
| E3013009 | E3013109* | 2x15V | 2x60mA | |
| E3013011* | E3013111* | 2x18V | 2x50mA | |
| E3013013* | E3013113* | 2x24V | 2x37mA | |

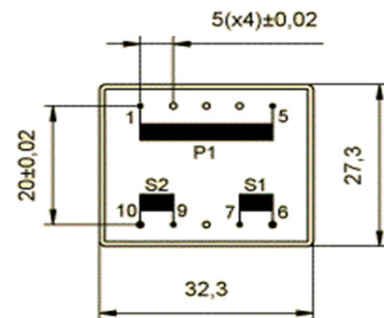

CENTER TAPPED, 1,8VA. Ta°40B

| HR REFERENCE | | Vo/Vsec=1,7 Vo --> Is=0 Vsec --> Isec=In | | Protection |
|--------------|------------|---|---------|---------------------|
| Prim. 230V | Prim. 115V | Vsec | Isec | |
| E3013035 | E3013135* | 2x4,5V | 2x200mA | Short circuit proof |
| E3013021 | E3013121* | 2x6V | 2x150mA | |
| E3013023 | E3013123* | 2x7,5V | 2x120mA | |
| E3013025 | E3013125* | 2x9V | 2x100mA | |
| E3013027 | E3013127* | 2x12V | 2x75mA | |
| E3013029 | E3013129* | 2x15V | 2x60mA | |
| E3013031* | E3013131* | 2x18V | 2x50mA | |
| E3013033* | E3013133* | 2x24V | 2x37mA | |

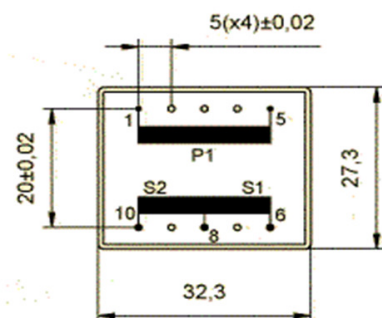

* these models are non VDE approved. Even so, they meet all requirements of EN61558-2-4, EN61558-2-6



E3013 (EI 30/12,5)

1,5VA - Ta70°B

weight - 85gr.

www.efiter.com



ENCAPSULATED TRANSFORMERS

According EN61558, EN60590, EN60472, UL506, UL1585, UL5085 · Short circuit proof

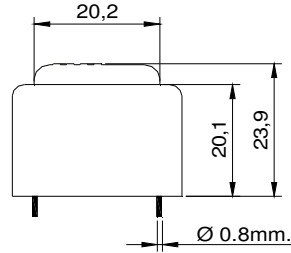
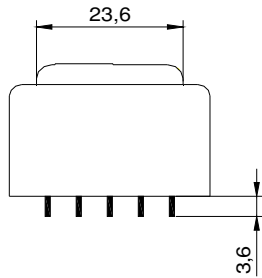

SINGLE SECONDARY, 1,5VA. Ta°70B

| HR REFERENCE | | Vo/Vsec=1,7 Vo --> Is=0 Vsec --> Isec=In | | Protection |
|--------------|------------|---|-------|---------------------|
| Prim. 230V | Prim. 115V | Vsec | Isec | |
| E3013064 | E3013164* | 4,5V | 333mA | Short circuit proof |
| E3013050 | E3013150* | 6V | 250mA | |
| E3013052 | E3013152* | 7,5V | 200mA | |
| E3013054 | E3013154* | 9V | 166mA | |
| E3013056 | E3013156* | 12V | 125mA | |
| E3013058 | E3013158* | 15V | 100mA | |
| E3013060 | E3013160* | 18V | 83mA | |
| E3013062 | E3013162* | 24V | 62mA | |

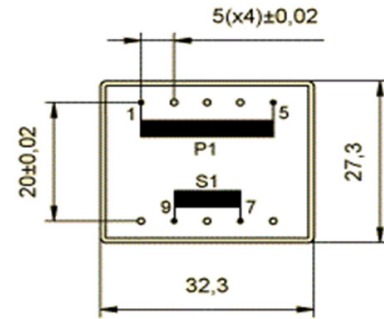

DUAL SECONDARY, 1,5VA. Ta°70B

| HR REFERENCE | | Vo/Vsec=1,7 Vo --> Is=0 Vsec --> Isec=In | | Protection |
|--------------|------------|---|---------|---------------------|
| Prim. 230V | Prim. 115V | Vsec | Isec | |
| E3013065 | E3013165* | 2x4,5V | 2x166mA | Short circuit proof |
| E3013051 | E3013151* | 2x6V | 2x125mA | |
| E3013053 | E3013153* | 2x7,5V | 2x100mA | |
| E3013055 | E3013155* | 2x9V | 2x83mA | |
| E3013057 | E3013157* | 2x12V | 2x62mA | |
| E3013059 | E3013159* | 2x15V | 2x50mA | |
| E3013061* | E3013161* | 2x18V | 2x41mA | |
| E3013063* | E3013163* | 2x24V | 2x31mA | |

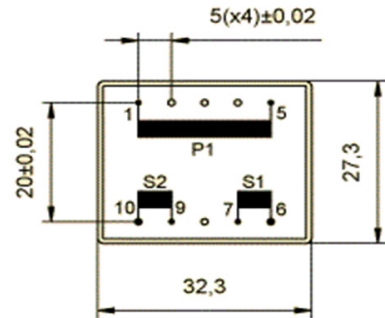

CENTER TAPPED, 1,5VA. Ta°70B

| HR REFERENCE | | Vo/Vsec=1,7 Vo --> Is=0 Vsec --> Isec=In | | Protection |
|--------------|------------|---|---------|---------------------|
| Prim. 230V | Prim. 115V | Vsec | Isec | |
| E3013085 | E3013185* | 2x4,5V | 2x166mA | Short circuit proof |
| E3013071 | E3013171* | 2x6V | 2x125mA | |
| E3013073 | E3013173* | 2x7,5V | 2x100mA | |
| E3013075 | E3013175* | 2x9V | 2x83mA | |
| E3013077 | E3013177* | 2x12V | 2x62mA | |
| E3013079 | E3013179* | 2x15V | 2x50mA | |
| E3013081* | E3013181* | 2x18V | 2x41mA | |
| E3013083* | E3013183* | 2x24V | 2x31mA | |

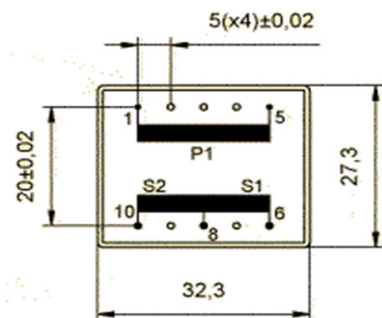

* these models are non VDE approved. Even so, they meet all requirements of EN61558-2-4, EN61558-2-6



E3016 (EI 30/16,5)

2,4VA - Ta40°C

weight - 100gr.

www.efiter.com



ENCAPSULATED TRANSFORMERS

According EN61558, EN60590, EN60472, UL506, UL1585, UL5085 · Short circuit proof

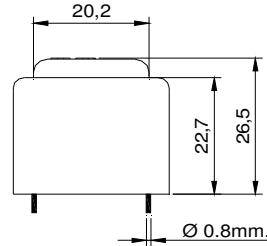
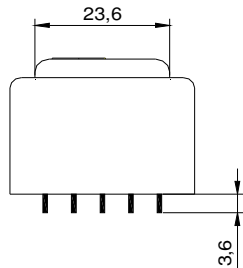

SINGLE SECONDARY, 2,4VA. Ta^o40B

| HR REFERENCE | | Vo/Vsec=1,7 Vo --> Is=0 Vsec --> Isec=In | | Protection |
|--------------|------------|---|-------|---------------------|
| Prim. 230V | Prim. 115V | Vsec | Isec | |
| E3016014 | E3016114 | 4,5V | 533mA | Short circuit proof |
| E3016000 | E3016100 | 6V | 400mA | |
| E3016002 | E3016102 | 7,5V | 320mA | |
| E3016004 | E3016104 | 9V | 266mA | |
| E3016006 | E3016106 | 12V | 200mA | |
| E3016008 | E3016108 | 15V | 160mA | |
| E3016010 | E3016110 | 18V | 133mA | |
| E3016012 | E3016112 | 24V | 100mA | |

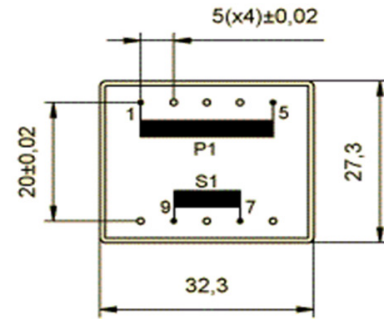

DUAL SECONDARY, 2,4VA. Ta^o40B

| HR REFERENCE | | Vo/Vsec=1,7 Vo --> Is=0 Vsec --> Isec=In | | Protection |
|--------------|------------|---|---------|---------------------|
| Prim. 230V | Prim. 115V | Vsec | Isec | |
| E3016015 | E3016115 | 2x4,5V | 2x266mA | Short circuit proof |
| E3016001 | E3016101 | 2x6V | 2x200mA | |
| E3016003 | E3016103 | 2x7,5V | 2x160mA | |
| E3016005 | E3016105 | 2x9V | 2x133mA | |
| E3016007 | E3016107 | 2x12V | 2x100mA | |
| E3016009 | E3016109 | 2x15V | 2x80mA | |
| E3016011 | E3016111 | 2x18V | 2x66mA | |
| E3016013 | E3016113 | 2x24V | 2x50mA | |

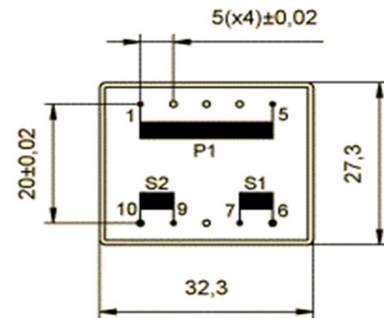

CENTER TAPPED, 2,4VA. Ta^o40B

| HR REFERENCE | | Vo/Vsec=1,7 Vo --> Is=0 Vsec --> Isec=In | | Protection |
|--------------|------------|---|---------|---------------------|
| Prim. 230V | Prim. 115V | Vsec | Isec | |
| E3016035 | E3016135 | 2x4,5V | 2x266mA | Short circuit proof |
| E3016021 | E3016121 | 2x6V | 2x200mA | |
| E3016023 | E3016123 | 2x7,5V | 2x160mA | |
| E3016025 | E3016125 | 2x9V | 2x133mA | |
| E3016027 | E3016127 | 2x12V | 2x100mA | |
| E3016029 | E3016129 | 2x15V | 2x80mA | |
| E3016031 | E3016131 | 2x18V | 2x66mA | |
| E3016033 | E3016133 | 2x24V | 2x50mA | |

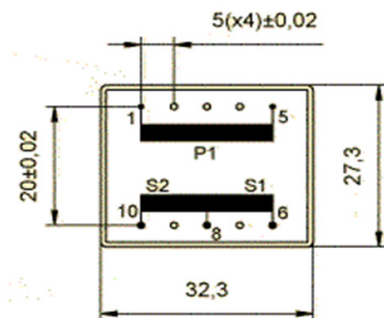

These models are non VDE approved. Even so, they meet all requirements of EN61558-2-4, EN61558-2-6



E3016 (EI 30/16,5)

2VA - Ta70°B

weight - 100gr.

www.efiter.com



ENCAPSULATED TRANSFORMERS

According EN61558, EN60590, EN60472, UL506, UL1585, UL5085 · Short circuit proof

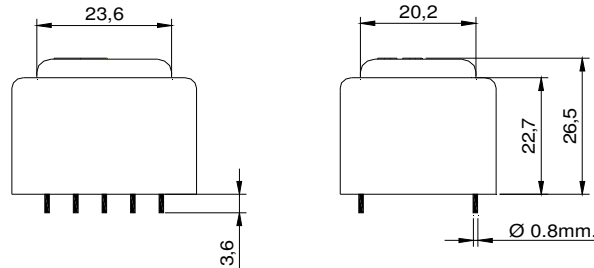

SINGLE SECONDARY, 2VA. Ta°70B

| HR REFERENCE | | Vo/Vsec=1,7 Vo --> Is=0 Vsec --> Isec=In | | Protection |
|--------------|------------|---|-------|---------------------|
| Prim. 230V | Prim. 115V | Vsec | Isec | |
| E3016014 | E3016114* | 4,5V | 444mA | Short circuit proof |
| E3016000 | E3016100* | 6V | 333mA | |
| E3016002 | E3016102* | 7,5V | 266mA | |
| E3016004 | E3016104* | 9V | 222mA | |
| E3016006 | E3016106* | 12V | 166mA | |
| E3016008 | E3016108* | 15V | 133mA | |
| E3016010 | E3016110* | 18V | 111mA | |
| E3016012 | E3016112* | 24V | 83mA | |

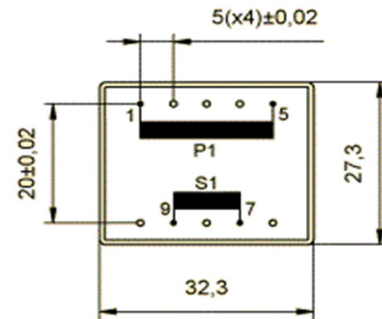

DUAL SECONDARY, 2VA. Ta°70B

| HR REFERENCE | | Vo/Vsec=1,7 Vo --> Is=0 Vsec --> Isec=In | | Protection |
|--------------|------------|---|---------|---------------------|
| Prim. 230V | Prim. 115V | Vsec | Isec | |
| E3016015 | E3016115* | 2x4,5V | 2x222mA | Short circuit proof |
| E3016001 | E3016101* | 2x6V | 2x166mA | |
| E3016003 | E3016103* | 2x7,5V | 2x133mA | |
| E3016005 | E3016105* | 2x9V | 2x111mA | |
| E3016007 | E3016107* | 2x12V | 2x83mA | |
| E3016009 | E3016109* | 2x15V | 2x66mA | |
| E3016011* | E3016111* | 2x18V | 2x55mA | |
| E3016013* | E3016113* | 2x24V | 2x41mA | |

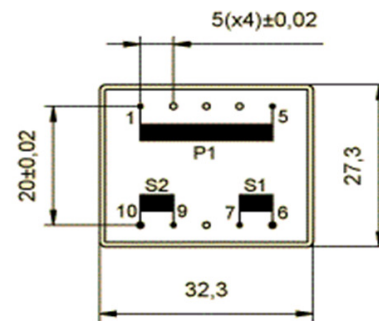

CENTER TAPPED, 2VA. Ta°70B

| HR REFERENCE | | Vo/Vsec=1,7 Vo --> Is=0 Vsec --> Isec=In | | Protection |
|--------------|------------|---|---------|---------------------|
| Prim. 230V | Prim. 115V | Vsec | Isec | |
| E3016035 | E3016135* | 2x4,5V | 2x222mA | Short circuit proof |
| E3016021 | E3016121* | 2x6V | 2x166mA | |
| E3016023 | E3016123* | 2x7,5V | 2x133mA | |
| E3016025 | E3016125* | 2x9V | 2x111mA | |
| E3016027 | E3016127* | 2x12V | 2x83mA | |
| E3016029 | E3016129* | 2x15V | 2x66mA | |
| E3016031* | E3016131* | 2x18V | 2x55mA | |
| E3016033* | E3016133* | 2x24V | 2x41mA | |

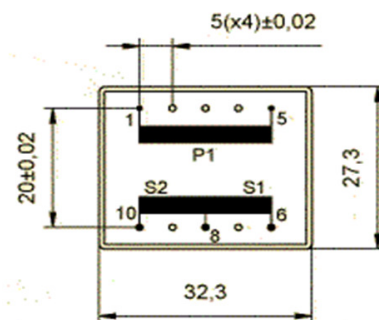

* these models are non VDE approved. Even so, they meet all requirements of EN61558-2-4, EN61558-2-6



E3018 (EI 30/18)

2,8VA - Ta40°C

weight - 115gr.

www.efiter.com



ENCAPSULATED TRANSFORMERS

According EN61558, EN60590, EN60472, UL506, UL1585, UL5085 · Short circuit proof

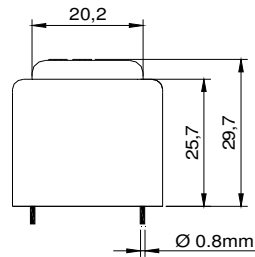
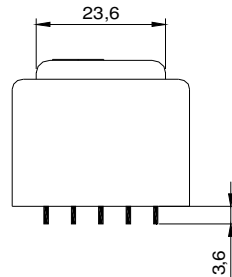

SINGLE SECONDARY, 2,8VA. Ta40°C

| HR REFERENCE | | Vo/Vsec=1,7 Vo --> Is=0 Vsec --> Isec=In | | Protection |
|--------------|------------|---|-------|---------------------|
| Prim. 230V | Prim. 115V | Vsec | Isec | |
| E3018014 | E3018114* | 4,5V | 622mA | Short circuit proof |
| E3018000 | E3018100* | 6V | 466mA | |
| E3018002 | E3018102* | 7,5V | 373mA | |
| E3018004 | E3018104* | 9V | 311mA | |
| E3018006 | E3018106* | 12V | 233mA | |
| E3018008 | E3018108* | 15V | 186mA | |
| E3018010 | E3018110* | 18V | 155mA | |
| E3018012 | E3018112* | 24V | 116mA | |

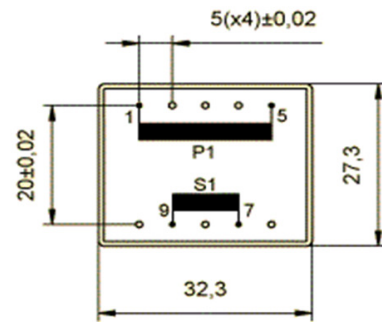

DUAL SECONDARY, 2,8VA. Ta40°C

| HR REFERENCE | | Vo/Vsec=1,7 Vo --> Is=0 Vsec --> Isec=In | | Protection |
|--------------|------------|---|---------|---------------------|
| Prim. 230V | Prim. 115V | Vsec | Isec | |
| E3018015 | E3018115* | 2x4,5V | 2x311mA | Short circuit proof |
| E3018001 | E3018101* | 2x6V | 2x233mA | |
| E3018003 | E3018103* | 2x7,5V | 2x186mA | |
| E3018005 | E3018105* | 2x9V | 2x155mA | |
| E3018007 | E3018107* | 2x12V | 2x116mA | |
| E3018009* | E3018109* | 2x15V | 2x93mA | |
| E3018011* | E3018111* | 2x18V | 2x77mA | |
| E3018013* | E3018113* | 2x24V | 2x58mA | |

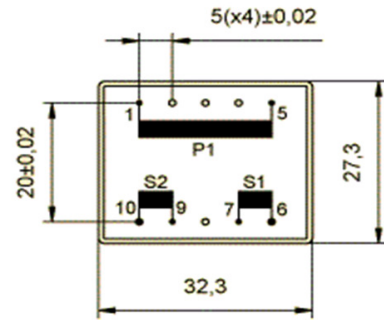

CENTER TAPPED, 2,8VA. Ta40°C

| HR REFERENCE | | Vo/Vsec=1,7 Vo --> Is=0 Vsec --> Isec=In | | Protection |
|--------------|------------|---|---------|---------------------|
| Prim. 230V | Prim. 115V | Vsec | Isec | |
| E3018035 | E3018135* | 2x4,5V | 2x311mA | Short circuit proof |
| E3018021 | E3018121* | 2x6V | 2x233mA | |
| E3018023 | E3018123* | 2x7,5V | 2x186mA | |
| E3018025 | E3018125* | 2x9V | 2x155mA | |
| E3018027 | E3018127* | 2x12V | 2x116mA | |
| E3018029* | E3018129* | 2x15V | 2x93mA | |
| E3018031* | E3018131* | 2x18V | 2x77mA | |
| E3018033* | E3018133* | 2x24V | 2x58mA | |

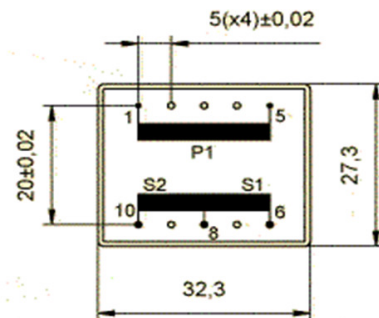

* these models are non VDE approved. Even so, they meet all requirements of EN61558-2-4, EN61558-2-6



E3018 (EI 30/18)

2,3VA - Ta70°B

weight - 115gr.

www.efiter.com



ENCAPSULATED TRANSFORMERS

According EN61558, EN60590, EN60472, UL506, UL1585, UL5085 · Short circuit proof

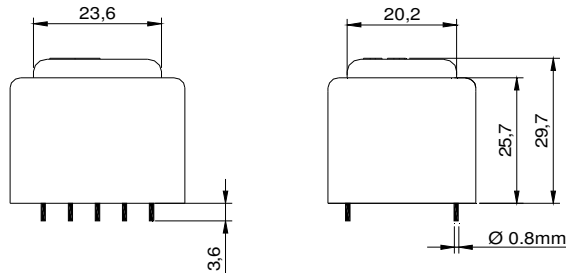

SINGLE SECONDARY, 2,3VA. Ta°70B

| HR REFERENCE | | Vo/Vsec=1,7 Vo --> Is=0 Vsec --> Isec=In | | Protection |
|--------------|------------|---|-------|---------------------|
| Prim. 230V | Prim. 115V | Vsec | Isec | |
| E3018064 | E3018164* | 4,5V | 511mA | Short circuit proof |
| E3018050 | E3018150* | 6V | 383mA | |
| E3018052 | E3018152* | 7,5V | 306mA | |
| E3018054 | E3018154* | 9V | 255mA | |
| E3018056 | E3018156* | 12V | 191mA | |
| E3018058 | E3018158* | 15V | 153mA | |
| E3018060 | E3018160* | 18V | 127mA | |
| E3018062 | E3018162* | 24V | 95mA | |

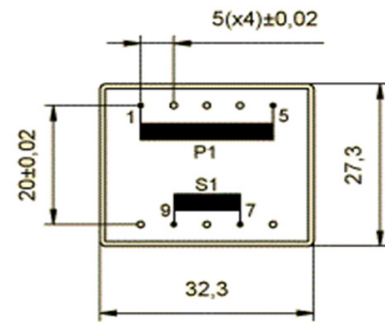

DUAL SECONDARY, 2,3VA. Ta°70B

| HR REFERENCE | | Vo/Vsec=1,7 Vo --> Is=0 Vsec --> Isec=In | | Protection |
|--------------|------------|---|---------|---------------------|
| Prim. 230V | Prim. 115V | Vsec | Isec | |
| E3018065 | E3018165* | 2x4,5V | 2x255mA | Short circuit proof |
| E3018051 | E3018151* | 2x6V | 2x191mA | |
| E3018053 | E3018153* | 2x7,5V | 2x153mA | |
| E3018055 | E3018155* | 2x9V | 2x127mA | |
| E3018057 | E3018157* | 2x12V | 2x95mA | |
| E3018059* | E3018159* | 2x15V | 2x76mA | |
| E3018061* | E3018161* | 2x18V | 2x63mA | |
| E3018063* | E3018163* | 2x24V | 2x47mA | |

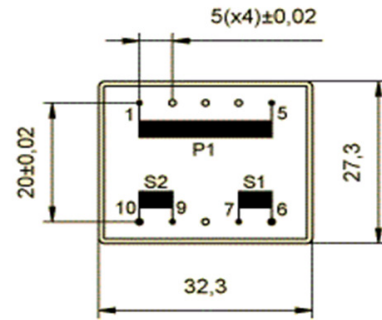

CENTER TAPPED, 2,3VA. Ta°70B

| HR REFERENCE | | Vo/Vsec=1,7 Vo --> Is=0 Vsec --> Isec=In | | Protection |
|--------------|------------|---|---------|---------------------|
| Prim. 230V | Prim. 115V | Vsec | Isec | |
| E3018085 | E3018185* | 2x4,5V | 2x255mA | Short circuit proof |
| E3018071 | E3018171* | 2x6V | 2x191mA | |
| E3018073 | E3018173* | 2x7,5V | 2x153mA | |
| E3018075 | E3018175* | 2x9V | 2x127mA | |
| E3018077 | E3018177* | 2x12V | 2x95mA | |
| E3018079* | E3018179* | 2x15V | 2x76mA | |
| E3018081* | E3018181* | 2x18V | 2x63mA | |
| E3018083* | E3018183* | 2x24V | 2x47mA | |

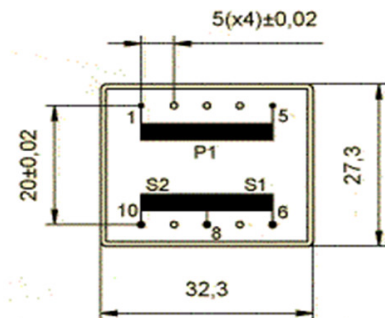

* these models are non VDE approved. Even so, they meet all requirements of EN61558-2-4, EN61558-2-6



E3023 (EI 30/23)

3,2VA - Ta40°C

weight - 140gr.

www.efiter.com



ENCAPSULATED TRANSFORMERS

According EN61558, EN60590, EN60472, UL506, UL1585, UL5085 · Short circuit proof

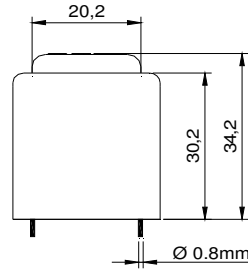
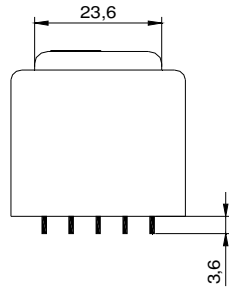

SINGLE SECONDARY, 3,2VA. Ta^o40B

| HR REFERENCE | | Vo/Vsec=1,7 Vo --> Is=0 Vsec --> Isec=In | | Protection |
|--------------|------------|---|-------|---------------------|
| Prim. 230V | Prim. 115V | Vsec | Isec | |
| E3023014 | E3023114 | 4,5V | 711mA | Short circuit proof |
| E3023000 | E3023100 | 6V | 533mA | |
| E3023002 | E3023102 | 7,5V | 426mA | |
| E3023004 | E3023104 | 9V | 355mA | |
| E3023006 | E3023106 | 12V | 266mA | |
| E3023008 | E3023108 | 15V | 213mA | |
| E3023010 | E3023110 | 18V | 177mA | |
| E3023012 | E3023112 | 24V | 133mA | |

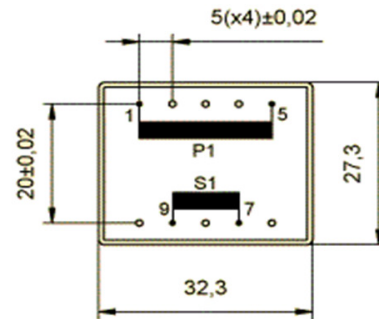

DUAL SECONDARY, 3,2VA. Ta^o40B

| HR REFERENCE | | Vo/Vsec=1,7 Vo --> Is=0 Vsec --> Isec=In | | Protection |
|--------------|------------|---|---------|---------------------|
| Prim. 230V | Prim. 115V | Vsec | Isec | |
| E3023015 | E3023115 | 2x4,5V | 2x355mA | Short circuit proof |
| E3023001 | E3023101 | 2x6V | 2x266mA | |
| E3023003 | E3023103 | 2x7,5V | 2x213mA | |
| E3023005 | E3023105 | 2x9V | 2x177mA | |
| E3023007 | E3023107 | 2x12V | 2x133mA | |
| E3023009 | E3023109 | 2x15V | 2x106mA | |
| E3023011 | E3023111 | 2x18V | 2x88mA | |
| E3023013 | E3023113 | 2x24V | 2x66mA | |

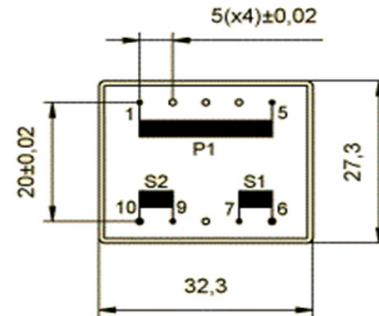

CENTER TAPPED, 3,2VA. Ta^o40B

| HR REFERENCE | | Vo/Vsec=1,7 Vo --> Is=0 Vsec --> Isec=In | | Protection |
|--------------|------------|---|---------|---------------------|
| Prim. 230V | Prim. 115V | Vsec | Isec | |
| E3023035 | E3023135 | 2x4,5V | 2x355mA | Short circuit proof |
| E3023021 | E3023121 | 2x6V | 2x266mA | |
| E3023023 | E3023123 | 2x7,5V | 2x213mA | |
| E3023025 | E3023125 | 2x9V | 2x177mA | |
| E3023027 | E3023127 | 2x12V | 2x133mA | |
| E3023029 | E3023129 | 2x15V | 2x106mA | |
| E3023031 | E3023131 | 2x18V | 2x88mA | |
| E3023033 | E3023133 | 2x24V | 2x66mA | |

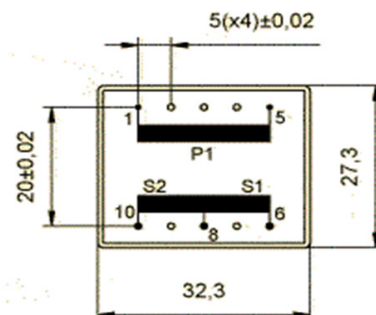

These models are non VDE approved. Even so, they meet all requirements of EN61558-2-4, EN61558-2-6



E3023 (EI 30/23)

2,8VA - Ta70°B

weight - 140gr.

www.efiter.com



ENCAPSULATED TRANSFORMERS

According EN61558, EN60590, EN60472, UL506, UL1585, UL5085 · Short circuit proof

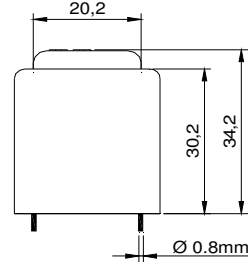
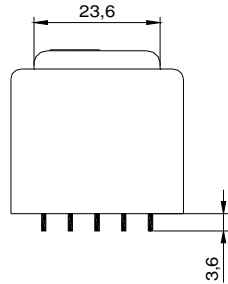

SINGLE SECONDARY, 2,8VA. Ta70B

| HR REFERENCE | | Vo/Vsec=1,7 Vo --> Is=0 Vsec --> Isec=In | | Protection |
|--------------|------------|---|-------|---------------------|
| Prim. 230V | Prim. 115V | Vsec | Isec | |
| E3023064 | E3023164 | 4,5V | 622mA | Short circuit proof |
| E3023050 | E3023150 | 6V | 466mA | |
| E3023052 | E3023152 | 7,5V | 373mA | |
| E3023054 | E3023154 | 9V | 311mA | |
| E3023056 | E3023156 | 12V | 233mA | |
| E3023058 | E3023158 | 15V | 186mA | |
| E3023060 | E3023160 | 18V | 155mA | |
| E3023062 | E3023162 | 24V | 116mA | |

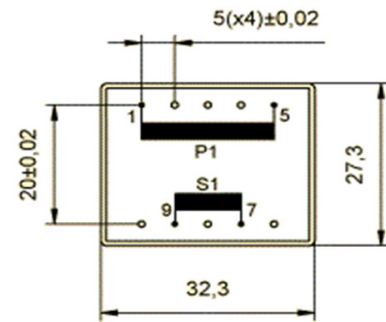

DUAL SECONDARY, 2,8VA. Ta70B

| HR REFERENCE | | Vo/Vsec=1,7 Vo --> Is=0 Vsec --> Isec=In | | Protection |
|--------------|------------|---|---------|---------------------|
| Prim. 230V | Prim. 115V | Vsec | Isec | |
| E3023065 | E3023165 | 2x4,5V | 2x311mA | Short circuit proof |
| E3023051 | E3023151 | 2x6V | 2x233mA | |
| E3023053 | E3023153 | 2x7,5V | 2x186mA | |
| E3023055 | E3023155 | 2x9V | 2x155mA | |
| E3023057 | E3023157 | 2x12V | 2x116mA | |
| E3023059 | E3023159 | 2x15V | 2x93mA | |
| E3023061 | E3023161 | 2x18V | 2x77mA | |
| E3023063 | E3023163 | 2x24V | 2x58mA | |

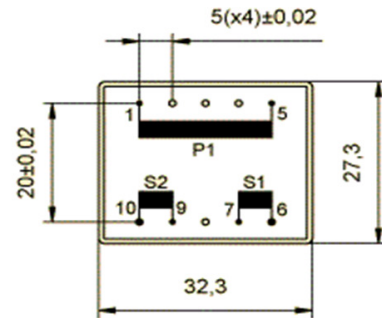

CENTER TAPPED, 2,8VA. Ta70B

| HR REFERENCE | | Vo/Vsec=1,7 Vo --> Is=0 Vsec --> Isec=In | | Protection |
|--------------|------------|---|---------|---------------------|
| Prim. 230V | Prim. 115V | Vsec | Isec | |
| E3023085 | E3023185 | 2x4,5V | 2x311mA | Short circuit proof |
| E3023071 | E3023171 | 2x6V | 2x233mA | |
| E3023073 | E3023173 | 2x7,5V | 2x186mA | |
| E3023075 | E3023175 | 2x9V | 2x155mA | |
| E3023077 | E3023177 | 2x12V | 2x116mA | |
| E3023079 | E3023179 | 2x15V | 2x93mA | |
| E3023081 | E3023181 | 2x18V | 2x77mA | |
| E3023083 | E3023183 | 2x24V | 2x58mA | |

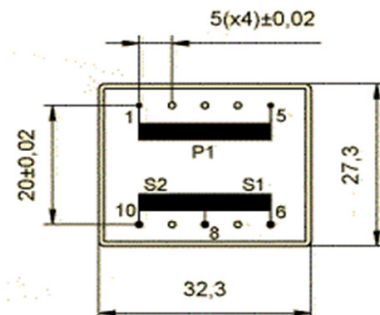

These models are non VDE approved. Even so, they meet all requirements of EN61558-2-4, EN61558-2-6



E3814 (EI 38/13,6)

4VA - Ta40°C

weight - 150gr.

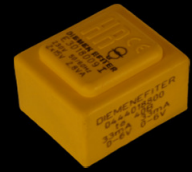

www.efiter.com

ENCAPSULATED TRANSFORMERS

According EN61558, EN60590, EN60472, UL506, UL1585, UL5085 · External protection

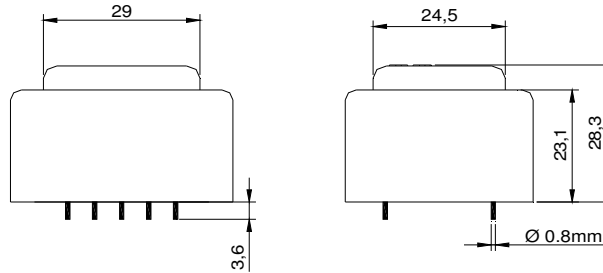

SINGLE SECONDARY, 4VA. Ta⁴⁰B

| HR REFERENCE | | Vo/Vsec=1,4 Vo --> Is=0 Vsec --> Isec=In | | Prot. Prim. 230V: 32mA/T 115V: 64mA/T |
|--------------|------------|---|-------|---|
| Prim. 230V | Prim. 115V | Vsec | Isec | Prot. Sec. mA/F |
| E3814014 | E3814114 | 4,5V | 888mA | 1000mA |
| E3814000 | E3814100 | 6V | 666mA | 800mA |
| E3814002 | E3814102 | 7,5V | 533mA | 630mA |
| E3814004 | E3814104 | 9V | 444mA | 500mA |
| E3814006 | E3814106 | 12V | 333mA | 400mA |
| E3814008 | E3814108 | 15V | 266mA | 315mA |
| E3814010 | E3814110 | 18V | 222mA | 250mA |
| E3814012 | E3814112 | 24V | 166mA | 200mA |

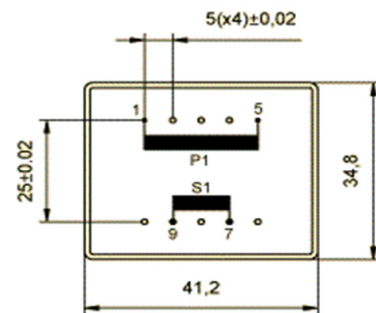

DUAL SECONDARY, 4VA. Ta⁴⁰B

| HR REFERENCE | | Vo/Vsec=1,4 Vo --> Is=0 Vsec --> Isec=In | | Prot. Prim. 230V:32mA/T 115V:64mA/T |
|--------------|------------|---|---------|---|
| Prim. 230V | Prim. 115V | Vsec | Isec | Prot. Sec. mA/F |
| E3814015 | E3814115 | 2x4,5V | 2x444mA | 2x500mA |
| E3814001 | E3814101 | 2x6V | 2x333mA | 2x400mA |
| E3814003 | E3814103 | 2x7,5V | 2x266mA | 2x315mA |
| E3814005 | E3814105 | 2x9V | 2x222mA | 2x250mA |
| E3814007 | E3814107 | 2x12V | 2x166mA | 2x200mA |
| E3814009 | E3814109 | 2x15V | 2x133mA | 2x160mA |
| E3814011 | E3814111 | 2x18V | 2x111mA | 2x125mA |
| E3814013 | E3814113 | 2x24V | 2x83mA | 2x100mA |

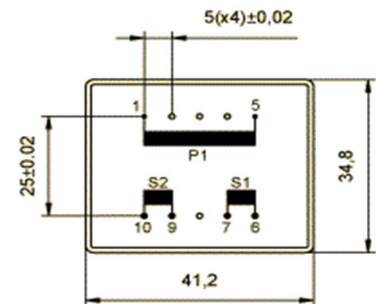

CENTER TAPPED, 4VA. Ta⁴⁰B

| HR REFERENCE | | Vo/Vsec=1,4 Vo --> Is=0 Vsec --> Isec=In | | Prot. Prim. 230V:32mA/T 115V:64mA/T |
|--------------|------------|---|---------|---|
| Prim. 230V | Prim. 115V | Vsec | Isec | Prot. Sec. mA/F |
| E3814035 | E3814135 | 2x4,5V | 2x444mA | 2x500mA |
| E3814021 | E3814121 | 2x6V | 2x333mA | 2x400mA |
| E3814023 | E3814123 | 2x7,5V | 2x266mA | 2x315mA |
| E3814025 | E3814125 | 2x9V | 2x222mA | 2x250mA |
| E3814027 | E3814127 | 2x12V | 2x166mA | 2x200mA |
| E3814029 | E3814129 | 2x15V | 2x133mA | 2x160mA |
| E3814031 | E3814131 | 2x18V | 2x111mA | 2x125mA |
| E3814033 | E3814133 | 2x24V | 2x83mA | 2x100mA |

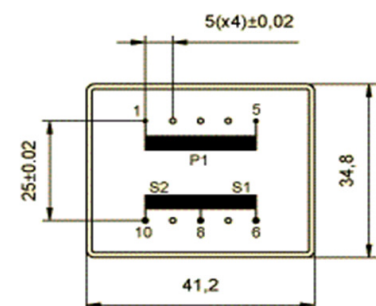

These models are non VDE approved. Even so, they meet all requirements of EN61558-2-4, EN61558-2-6



E3814 (EI 38/13,6)

3,5VA - Ta70°B

weight - 150gr.

www.efiter.com



ENCAPSULATED TRANSFORMERS

According EN61558, EN60590, EN60472, UL506, UL1585, UL5085 · External protection

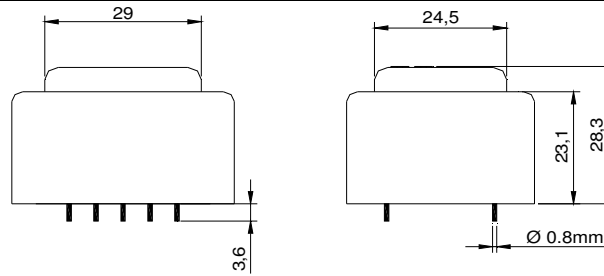

SINGLE SECONDARY, 3,5VA. Ta°70B

| HR REFERENCE | | Vo/Vsec=1,4 Vo --> Is=0 Vsec --> Isec=In | | Prot. Prim. 230V: 32mA/T 115V: 64mA/T |
|--------------|------------|---|-------|---|
| Prim. 230V | Prim. 115V | Vsec | Isec | Prot. Sec. mA/F |
| E3814064 | E3814164 | 4,5V | 777mA | 800mA |
| E3814050 | E3814150 | 6V | 583mA | 630mA |
| E3814052 | E3814152 | 7,5V | 466mA | 500mA |
| E3814054 | E3814154 | 9V | 388mA | 400mA |
| E3814056 | E3814156 | 12V | 291mA | 315mA |
| E3814058 | E3814158 | 15V | 233mA | 250mA |
| E3814060 | E3814160 | 18V | 194mA | 200mA |
| E3814062 | E3814162 | 24V | 145mA | 160mA |

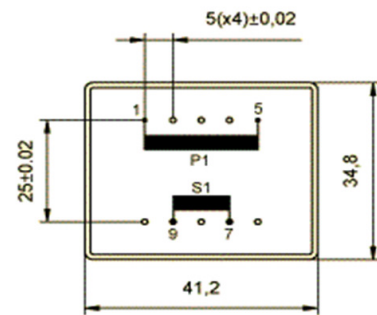

DUAL SECONDARY, 3,5VA. Ta°70B

| HR REFERENCE | | Vo/Vsec=1,4 Vo --> Is=0 Vsec --> Isec=In | | Prot. Prim. 230V:32mA/T 115V:64mA/T |
|--------------|------------|---|---------|---|
| Prim. 230V | Prim. 115V | Vsec | Isec | Prot. Sec. mA/F |
| E3814065 | E3814165 | 2x4,5V | 2x388mA | 2x400mA |
| E3814051 | E3814151 | 2x6V | 2x291mA | 2x315mA |
| E3814053 | E3814153 | 2x7,5V | 2x233mA | 2x250mA |
| E3814055 | E3814155 | 2x9V | 2x194mA | 2x200mA |
| E3814057 | E3814157 | 2x12V | 2x145mA | 2x160mA |
| E3814059 | E3814159 | 2x15V | 2x116mA | 2x125mA |
| E3814061 | E3814161 | 2x18V | 2x97mA | 2x110mA |
| E3814063 | E3814163 | 2x24V | 2x72mA | 2x80mA |

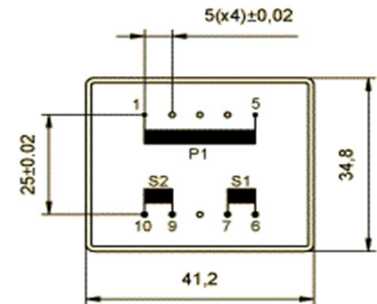

CENTER TAPPED, 3,5VA. Ta°70B

| HR REFERENCE | | Vo/Vsec=1,4 Vo --> Is=0 Vsec --> Isec=In | | Prot. Prim. 230V:32mA/T 115V:64mA/T |
|--------------|------------|---|---------|---|
| Prim. 230V | Prim. 115V | Vsec | Isec | Prot. Sec. mA/F |
| E3814085 | E3814185 | 2x4,5V | 2x388mA | 2x400mA |
| E3814071 | E3814171 | 2x6V | 2x291mA | 2x315mA |
| E3814073 | E3814173 | 2x7,5V | 2x233mA | 2x250mA |
| E3814075 | E3814175 | 2x9V | 2x194mA | 2x200mA |
| E3814077 | E3814177 | 2x12V | 2x145mA | 2x160mA |
| E3814079 | E3814179 | 2x15V | 2x116mA | 2x125mA |
| E3814081 | E3814181 | 2x18V | 2x97mA | 2x110mA |
| E3814083 | E3814183 | 2x24V | 2x72mA | 2x80mA |

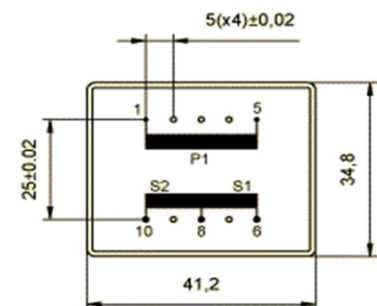

These models are non VDE approved. Even so, they meet all requirements of EN61558-2-4, EN61558-2-6



E4215 (EI 42/14,8)

6VA - Ta40°C

weight - 205gr.

www.efiter.com



ENCAPSULATED TRANSFORMERS

According EN61558, EN60590, EN60472, UL506, UL1585, UL5085 · External protection

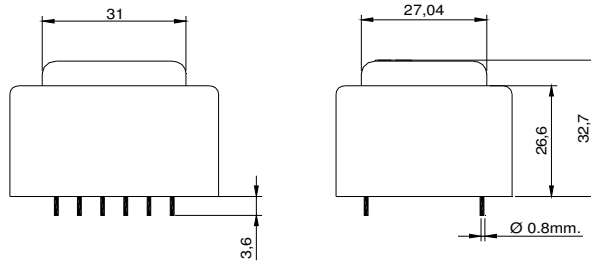

SINGLE SECONDARY, 6VA. Ta⁴⁰B

| HR REFERENCE | | Vo/Vsec=1,3 Vo --> Is=0 Vsec --> Isec=In | | Prot. Prim. 230V: 50mA/T 115V: 100mA/T |
|--------------|------------|---|--------|--|
| Prim. 230V | Prim. 115V | Vsec | Isec | Prot. Sec. mA/F |
| E4215014 | E4215114 | 4,5V | 1333mA | 1600mA |
| E4215000 | E4215100 | 6V | 1000mA | 1250mA |
| E4215002 | E4215102 | 7,5V | 800mA | 1000mA |
| E4215004 | E4215104 | 9V | 666mA | 800mA |
| E4215006 | E4215106 | 12V | 500mA | 630mA |
| E4215008 | E4215108 | 15V | 400mA | 500mA |
| E4215010 | E4215110 | 18V | 333mA | 400mA |
| E4215012 | E4215112 | 24V | 250mA | 315mA |

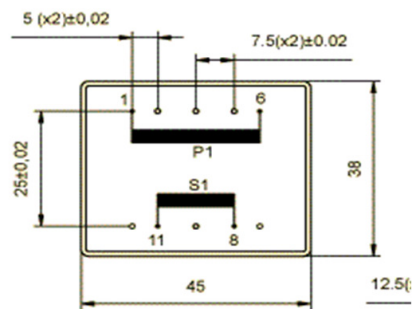

DUAL SECONDARY, 6VA. Ta⁴⁰B

| HR REFERENCE | | Vo/Vsec=1,3 Vo --> Is=0 Vsec --> Isec=In | | Prot. Prim. 230V: 50mA/T 115V: 100mA/T |
|--------------|------------|---|---------|--|
| Prim. 230V | Prim. 115V | Vsec | Isec | Prot. Sec. mA/F |
| E4215015 | E4215115 | 2x4,5V | 2x666mA | 2x800mA |
| E4215001 | E4215101 | 2x6V | 2x500mA | 2x630mA |
| E4215003 | E4215103 | 2x7,5V | 2x400mA | 2x500mA |
| E4215005 | E4215105 | 2x9V | 2x333mA | 2x400mA |
| E4215007 | E4215107 | 2x12V | 2x250mA | 2x315mA |
| E4215009 | E4215109 | 2x15V | 2x200mA | 2x250mA |
| E4215011 | E4215111 | 2x18V | 2x166mA | 2x200mA |
| E4215013 | E4215113 | 2x24V | 2x125mA | 2x160mA |

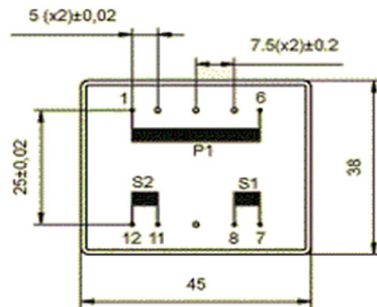

CENTER TAPPED, 6VA. Ta⁴⁰B

| HR REFERENCE | | Vo/Vsec=1,3 Vo --> Is=0 Vsec --> Isec=In | | Prot. Prim. 230V: 50mA/T 115V: 100mA/T |
|--------------|------------|---|---------|--|
| Prim. 230V | Prim. 115V | Vsec | Isec | Prot. Sec. mA/F |
| E4215035 | E4215135 | 2x4,5V | 2x666mA | 2x800mA |
| E4215021 | E4215121 | 2x6V | 2x500mA | 2x630mA |
| E4215023 | E4215123 | 2x7,5V | 2x400mA | 2x500mA |
| E4215025 | E4215125 | 2x9V | 2x333mA | 2x400mA |
| E4215027 | E4215127 | 2x12V | 2x250mA | 2x315mA |
| E4215029 | E4215129 | 2x15V | 2x200mA | 2x250mA |
| E4215031 | E4215131 | 2x18V | 2x166mA | 2x200mA |
| E4215033 | E4215133 | 2x24V | 2x125mA | 2x160mA |

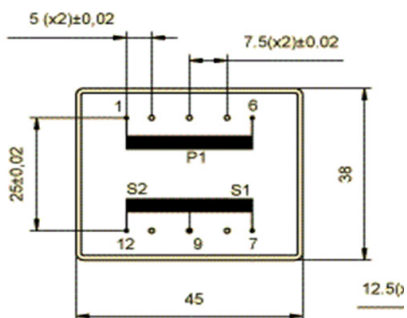

These models are non VDE approved. Even so, they meet all requirements of EN61558-2-4, EN61558-2-6



E4215 (EI 42/14,8)

5VA - Ta70°B

weight - 205gr.



www.efiter.com

ENCAPSULATED TRANSFORMERS

According EN61558, EN60590, EN60472, UL506, UL1585, UL5085 · External protection

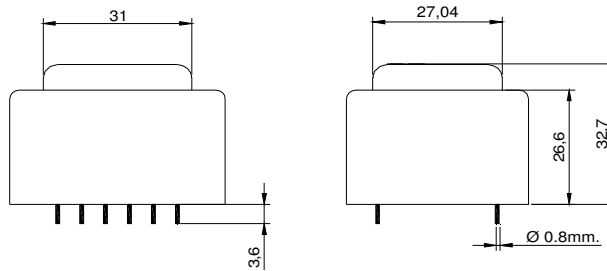

SINGLE SECONDARY, 5VA. Ta70B

| HR REFERENCE | | Vo/Vsec=1,3 Vo --> Is=0 Vsec --> Isec=In | | Prot. Prim. 230V: 40mA/T 115V: 80mA/T |
|--------------|------------|---|--------|---|
| Prim. 230V | Prim. 115V | Vsec | Isec | Prot. Sec. mA/F |
| E4215064 | E4215164 | 4,5V | 1111mA | 1250mA |
| E4215050 | E4215150 | 6V | 833mA | 1000mA |
| E4215052 | E4215152 | 7,5V | 666mA | 800mA |
| E4215054 | E4215154 | 9V | 555mA | 630mA |
| E4215056 | E4215156 | 12V | 416mA | 500mA |
| E4215058 | E4215158 | 15V | 333mA | 400mA |
| E4215060 | E4215160 | 18V | 277mA | 320mA |
| E4215062 | E4215162 | 24V | 208mA | 250mA |

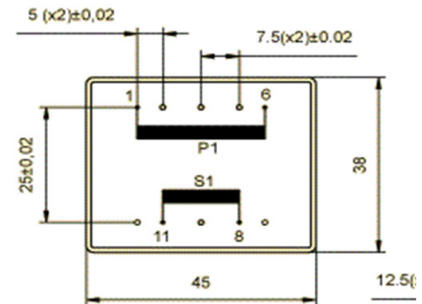

DUAL SECONDARY, 5VA. Ta70B

| HR REFERENCE | | Vo/Vsec=1,3 Vo --> Is=0 Vsec --> Isec=In | | Prot. Prim. 230V: 40mA/T 115V: 80mA/T |
|--------------|------------|---|---------|---|
| Prim. 230V | Prim. 115V | Vsec | Isec | Prot. Sec. mA/F |
| E4215065 | E4215165 | 2x4,5V | 2x555mA | 2x630mA |
| E4215051 | E4215151 | 2x6V | 2x416mA | 2x500mA |
| E4215053 | E4215153 | 2x7,5V | 2x333mA | 2x400mA |
| E4215055 | E4215155 | 2x9V | 2x277mA | 2x315mA |
| E4215057 | E4215157 | 2x12V | 2x208mA | 2x250mA |
| E4215059 | E4215159 | 2x15V | 2x166mA | 2x200mA |
| E4215061 | E4215161 | 2x18V | 2x138mA | 2x160mA |
| E4215063 | E4215163 | 2x24V | 2x104mA | 2x125mA |

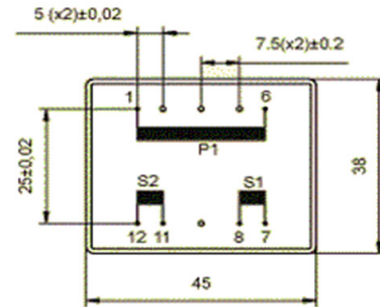

CENTER TAPPED, 5VA. Ta70B

| HR REFERENCE | | Vo/Vsec=1,3 Vo --> Is=0 Vsec --> Isec=In | | Prot. Prim. 230V: 40mA/T 115V: 80mA/T |
|--------------|------------|---|---------|---|
| Prim. 230V | Prim. 115V | Vsec | Isec | Prot. Sec. mA/F |
| E4215085 | E4215185 | 2x4,5V | 2x555mA | 2x630mA |
| E4215071 | E4215171 | 2x6V | 2x416mA | 2x500mA |
| E4215073 | E4215173 | 2x7,5V | 2x333mA | 2x400mA |
| E4215075 | E4215175 | 2x9V | 2x277mA | 2x315mA |
| E4215077 | E4215177 | 2x12V | 2x208mA | 2x250mA |
| E4215079 | E4215179 | 2x15V | 2x166mA | 2x200mA |
| E4215081 | E4215181 | 2x18V | 2x138mA | 2x160mA |
| E4215083 | E4215183 | 2x24V | 2x104mA | 2x125mA |

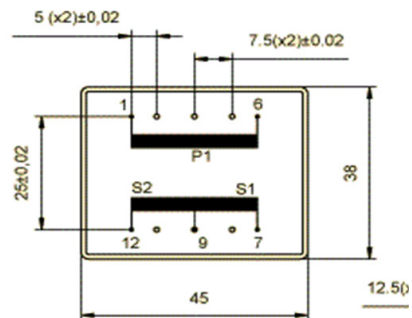

These models are non VDE approved. Even so, they meet all requirements of EN61558-2-4, EN61558-2-6



E4817 (EI 48/16,8)

10VA - Ta40°B

weight - 290gr.

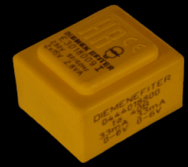

www.efiter.com

ENCAPSULATED TRANSFORMERS

According EN61558, EN60590, EN60472, UL506, UL1585, UL5085 · External protection

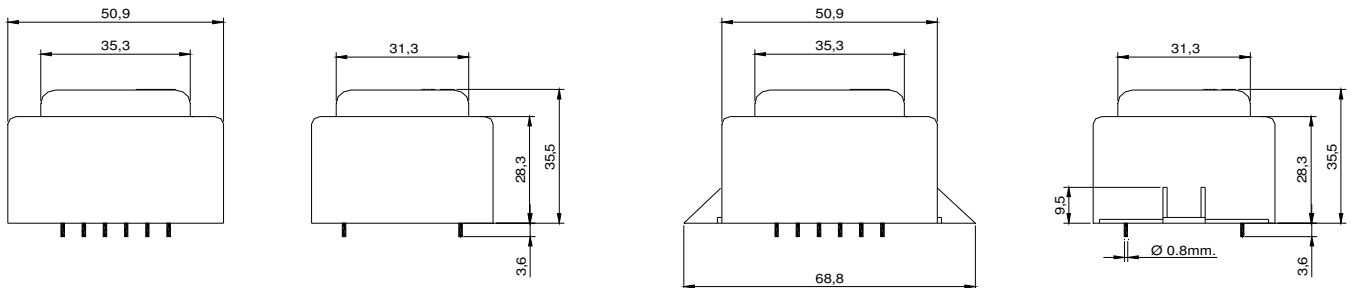

SINGLE SECONDARY, 10VA. Ta°40B

| HR REFERENCE | | HR REFERENCE with fixing holes | | Vo/Vsec=1,3 Vo --> Is=0 Vsec --> Isec=In | | Prot. Prim. 230V: 63mA/T 115V: 125mA/T |
|--------------|------------|--------------------------------|------------|---|--------|--|
| Prim. 230V | Prim. 115V | Prim. 230V | Prim. 115V | Vsec | Isec | Prot. Sec. mA/F |
| E4817014 | E4817114 | E4817514 | E4817614 | 4,5V | 2222mA | 2500mA |
| E4817000 | E4817100 | E4817500 | E4817600 | 6V | 1666mA | 2000mA |
| E4817002 | E4817102 | E4817502 | E4817602 | 7,5V | 1333mA | 1600mA |
| E4817004 | E4817104 | E4817504 | E4817604 | 9V | 1111mA | 1250mA |
| E4817006 | E4817106 | E4817506 | E4817606 | 12V | 833mA | 1000mA |
| E4817008 | E4817108 | E4817508 | E4817608 | 15V | 666mA | 800mA |
| E4817010 | E4817110 | E4817510 | E4817610 | 18V | 555mA | 630mA |
| E4817012 | E4817112 | E4817512 | E4817612 | 24V | 416mA | 500mA |

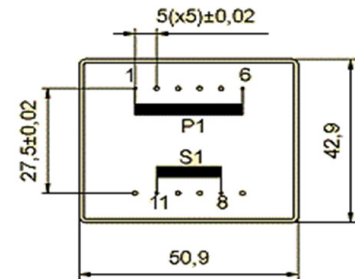

DUAL SECONDARY, 10VA. Ta°40B

| HR REFERENCE | | HR REFERENCE with fixing holes | | Vo/Vsec=1,3 Vo --> Is=0 Vsec --> Isec=In | | Prot. Prim. 230V: 63mA/T 115V: 125mA/T |
|--------------|------------|--------------------------------|------------|---|----------|--|
| Prim. 230V | Prim. 115V | Prim. 230V | Prim. 115V | Vsec | Isec | Prot. Sec. mA/F |
| E4817015 | E4817115 | E4817515 | E4817615 | 2x4,5V | 2x1111mA | 2x1250mA |
| E4817001 | E4817101 | E4817501 | E4817601 | 2x6V | 2x833mA | 2x1000mA |
| E4817003 | E4817103 | E4817503 | E4817603 | 2x7,5V | 2x666mA | 2x800mA |
| E4817005 | E4817105 | E4817505 | E4817605 | 2x9V | 2x555mA | 2x630mA |
| E4817007 | E4817107 | E4817507 | E4817607 | 2x12V | 2x416mA | 2x500mA |
| E4817009 | E4817109 | E4817509 | E4817609 | 2x15V | 2x333mA | 2x400mA |
| E4817011 | E4817111 | E4817511 | E4817611 | 2x18V | 2x277mA | 2x315mA |
| E4817013 | E4817113 | E4817513 | E4817613 | 2x24V | 2x208mA | 2x250mA |

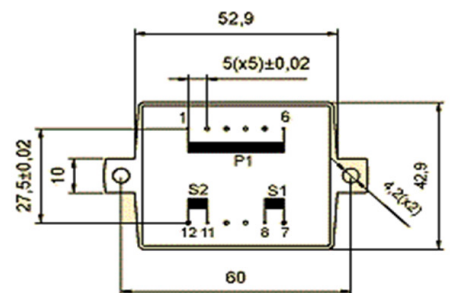

CENTER TAPPED, 10VA. Ta°40B

| HR REFERENCE | | HR REFERENCE with fixing holes | | Vo/Vsec=1,3 Vo --> Is=0 Vsec --> Isec=In | | Prot. Prim. 230V: 63mA/T 115V: 125mA/T |
|--------------|------------|--------------------------------|------------|---|----------|--|
| Prim. 230V | Prim. 115V | Prim. 230V | Prim. 115V | Vsec | Isec | Prot. Sec. mA/F |
| E4817035 | E4817135 | E4817535 | E4817635 | 2x4,5V | 2x1111mA | 2x1250mA |
| E4817021 | E4817121 | E4817521 | E4817621 | 2x6V | 2x833mA | 2x1000mA |
| E4817023 | E4817123 | E4817523 | E4817623 | 2x7,5V | 2x666mA | 2x800mA |
| E4817025 | E4817125 | E4817525 | E4817625 | 2x9V | 2x555mA | 2x630mA |
| E4817027 | E4817127 | E4817527 | E4817627 | 2x12V | 2x416mA | 2x500mA |
| E4817029 | E4817129 | E4817529 | E4817629 | 2x15V | 2x333mA | 2x400mA |
| E4817031 | E4817131 | E4817531 | E4817631 | 2x18V | 2x277mA | 2x315mA |
| E4817033 | E4817133 | E4817533 | E4817633 | 2x24V | 2x208mA | 2x250mA |

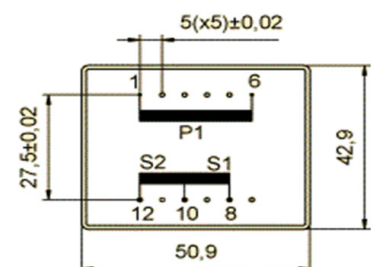

These models are non VDE approved. Even so, they meet all requirements of EN61558-2-4, EN61558-2-6



E4817 (EI 48/16,8)

8VA - Ta70°B

weight - 290gr.

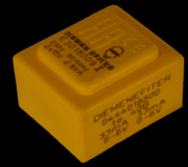

www.efiter.com

ENCAPSULATED TRANSFORMERS

According EN61558, EN60590, EN60472, UL506, UL1585, UL5085 · External protection

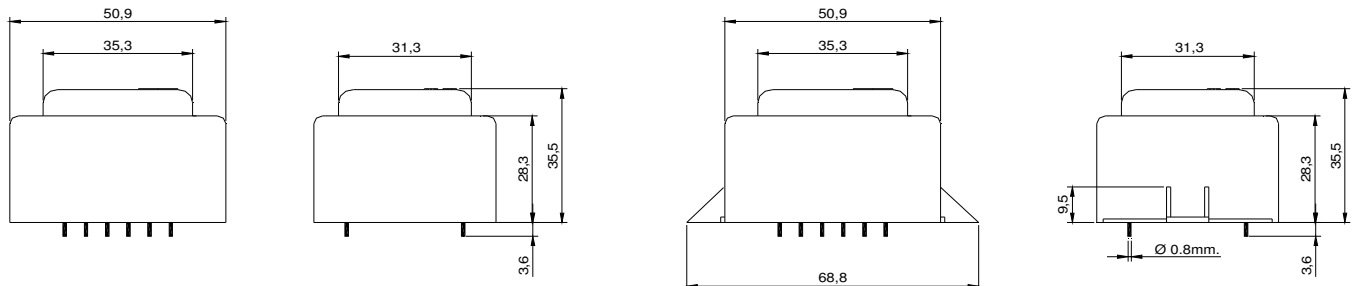

SINGLE SECONDARY, 8VA. Ta70B

| HR REFERENCE | | HR REFERENCE with fixing holes | | Vo/Vsec=1,3 Vo --> Is=0 Vsec --> Isec=In | | Prot. Prim. 230V: 50mA/T 115V: 100mA/T |
|--------------|------------|--------------------------------|------------|---|--------|--|
| Prim. 230V | Prim. 115V | Prim. 230V | Prim. 115V | Vsec | Isec | Prot. Sec. mA/F |
| E4817064 | E4817164* | E4817564 | E4817664* | 4,5V | 1777mA | 2500mA |
| E4817050 | E4817150* | E4817550 | E4817650* | 6V | 1333mA | 2000mA |
| E4817052 | E4817152* | E4817552 | E4817652* | 7,5V | 1066mA | 1600mA |
| E4817054 | E4817154* | E4817554 | E4817654* | 9V | 888mA | 1250mA |
| E4817056 | E4817156* | E4817556 | E4817656* | 12V | 666mA | 1000mA |
| E4817058 | E4817158* | E4817558 | E4817658* | 15V | 533mA | 800mA |
| E4817060 | E4817160* | E4817560 | E4817660* | 18V | 444mA | 630mA |
| E4817062 | E4817162* | E4817562 | E4817662* | 24V | 333mA | 500mA |

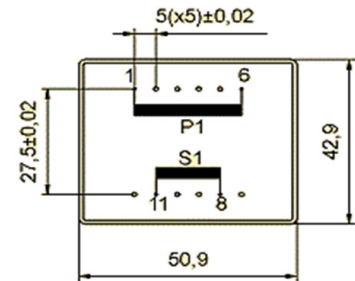

DUAL SECONDARY, 8VA. Ta70B

| HR REFERENCE | | HR REFERENCE with fixing holes | | Vo/Vsec=1,3 Vo --> Is=0 Vsec --> Isec=In | | Prot. Prim. 230V: 50mA/T 115V: 100mA/T |
|--------------|------------|--------------------------------|------------|---|---------|--|
| Prim. 230V | Prim. 115V | Prim. 230V | Prim. 115V | Vsec | Isec | Prot. Sec. mA/F |
| E4817065 | E4817165* | E4817565 | E4817665* | 2x4,5V | 2x888mA | 2x1000mA |
| E4817051 | E4817151* | E4817551 | E4817651* | 2x6V | 2x666mA | 2x800mA |
| E4817053 | E4817153* | E4817553 | E4817653* | 2x7,5V | 2x533mA | 2x630mA |
| E4817055 | E4817155* | E4817555 | E4817655* | 2x9V | 2x444mA | 2x500mA |
| E4817057 | E4817157* | E4817557 | E4817657* | 2x12V | 2x333mA | 2x400mA |
| E4817059 | E4817159* | E4817559 | E4817659* | 2x15V | 2x266mA | 2x315mA |
| E4817061 | E4817161* | E4817561 | E4817661* | 2x18V | 2x222mA | 2x250mA |
| E4817063* | E4817163* | E4817563* | E4817663* | 2x24V | 2x166mA | 2x200mA |

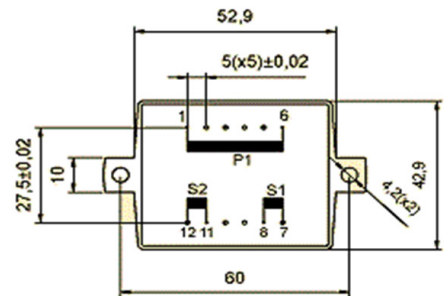

CENTER TAPPED, 8VA. Ta70B

| HR REFERENCE | | HR REFERENCE with fixing holes | | Vo/Vsec=1,3 Vo --> Is=0 Vsec --> Isec=In | | Prot. Prim. 230V: 50mA/T 115V: 100mA/T |
|--------------|------------|--------------------------------|------------|---|---------|--|
| Prim. 230V | Prim. 115V | Prim. 230V | Prim. 115V | Vsec | Isec | Prot. Sec. mA/F |
| E4817085 | E4817185* | E4817585 | E4817685* | 2x4,5V | 2x888mA | 2x1000mA |
| E4817071 | E4817171* | E4817571 | E4817671* | 2x6V | 2x666mA | 2x800mA |
| E4817073 | E4817173* | E4817573 | E4817673* | 2x7,5V | 2x533mA | 2x630mA |
| E4817075 | E4817175* | E4817575 | E4817675* | 2x9V | 2x444mA | 2x500mA |
| E4817077 | E4817177* | E4817577 | E4817677* | 2x12V | 2x333mA | 2x400mA |
| E4817079 | E4817179* | E4817579 | E4817679* | 2x15V | 2x266mA | 2x315mA |
| E4817081 | E4817181* | E4817581 | E4817681* | 2x18V | 2x222mA | 2x250mA |
| E4817083* | E4817183* | E4817583* | E4817683* | 2x24V | 2x166mA | 2x200mA |

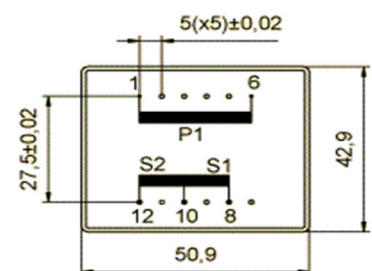

* these models are non VDE approved. Even so, they meet all requirements of EN61558-2-4, EN60590-2-4



E4821 (EI 48/20,5)

12VA - Ta40°B

weight - 345gr.

www.efiter.com

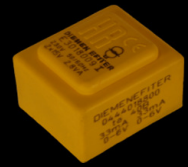

ENCAPSULATED TRANSFORMERS

According EN61558, EN60590, EN60472, UL506, UL1585, UL5085 · External protection

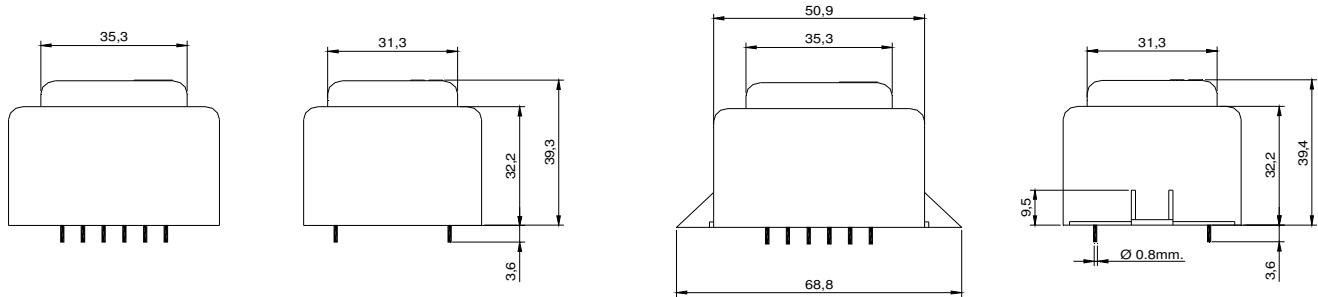

SINGLE SECONDARY, 12VA. Ta°40B

| HR REFERENCE | | HR REFERENCE with fixing holes | | Vo/Vsec=1,25 Vo-->Is=0 Vsec --> Isec=In | | Prot. Prim. 230V: 80mA/T 115V: 160mA/T |
|--------------|------------|--------------------------------|------------|--|--------|--|
| Prim. 230V | Prim. 115V | Prim. 230V | Prim. 115V | Vsec | Isec | Prot. Sec. mA/F |
| E4821014 | E4821114* | E4821514 | E4821614* | 4,5V | 2666mA | 2500mA |
| E4821000 | E4821100* | E4821500 | E4821600* | 6V | 2000mA | 2000mA |
| E4821002 | E4821102* | E4821502 | E4821602* | 7,5V | 1600mA | 1600mA |
| E4821004 | E4821104* | E4821504 | E4821604* | 9V | 1333mA | 1250mA |
| E4821006 | E4821106* | E4821506 | E4821606* | 12V | 1000mA | 1000mA |
| E4821008 | E4821108* | E4821508 | E4821608* | 15V | 800mA | 800mA |
| E4821010 | E4821110* | E4821510 | E4821610* | 18V | 666mA | 630mA |
| E4821012 | E4821112* | E4821512 | E4821612* | 24V | 500mA | 500mA |

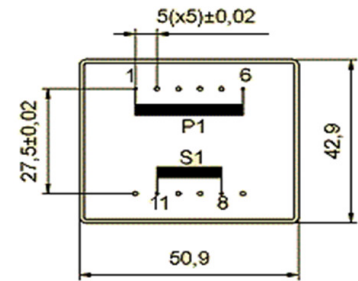

DUAL SECONDARY, 12VA. Ta°40B

| HR REFERENCE | | HR REFERENCE with fixing holes | | Vo/Vsec=1,25 Vo-->Is=0 Vsec --> Isec=In | | Prot. Prim. 230V: 80mA/T 115V: 160mA/T |
|--------------|------------|--------------------------------|------------|--|----------|--|
| Prim. 230V | Prim. 115V | Prim. 230V | Prim. 115V | Vsec | Isec | Prot. Sec. mA/F |
| E4821015 | E4821115* | E4821515 | E4821615* | 2x4,5V | 2x1333mA | 2x1600mA |
| E4821001 | E4821101* | E4821501 | E4821601* | 2x6V | 2x1000mA | 2x1250mA |
| E4821003 | E4821103* | E4821503 | E4821603* | 2x7,5V | 2x800mA | 2x1000mA |
| E4821005 | E4821105* | E4821505 | E4821605* | 2x9V | 2x666mA | 2x800mA |
| E4821007 | E4821107* | E4821507 | E4821607* | 2x12V | 2x500mA | 2x630mA |
| E4821009 | E4821109* | E4821509 | E4821609* | 2x15V | 2x400mA | 2x500mA |
| E4821011 | E4821111* | E4821511 | E4821611* | 2x18V | 2x333mA | 2x400mA |
| E4821013* | E4821113* | E4821513* | E4821613* | 2x24V | 2x250mA | 2x315mA |

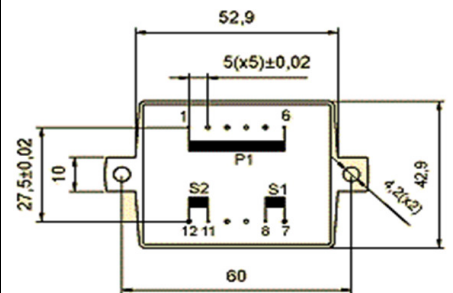

CENTER TAPPED, 12VA. Ta°40B

| HR REFERENCE | | HR REFERENCE with fixing holes | | Vo/Vsec=1,25 Vo-->Is=0 Vsec --> Isec=In | | Prot. Prim. 230V: 80mA/T 115V: 160mA/T |
|--------------|------------|--------------------------------|------------|--|----------|--|
| Prim. 230V | Prim. 115V | Prim. 230V | Prim. 115V | Vsec | Isec | Prot. Sec. mA/F |
| E4821035 | E4821135* | E4821535 | E4821635* | 2x4,5V | 2x1333mA | 2x1600mA |
| E4821021 | E4821121* | E4821521 | E4821621* | 2x6V | 2x1000mA | 2x1250mA |
| E4821023 | E4821123* | E4821523 | E4821623* | 2x7,5V | 2x800mA | 2x1000mA |
| E4821025 | E4821125* | E4821525 | E4821625* | 2x9V | 2x666mA | 2x800mA |
| E4821027 | E4821127* | E4821527 | E4821627* | 2x12V | 2x500mA | 2x630mA |
| E4821029 | E4821129* | E4821529 | E4821629* | 2x15V | 2x400mA | 2x500mA |
| E4821031 | E4821131* | E4821531 | E4821631* | 2x18V | 2x333mA | 2x400mA |
| E4821033* | E4821133* | E4821533* | E4821633* | 2x24V | 2x250mA | 2x315mA |

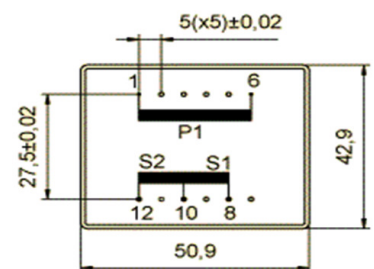

* these models are non VDE approved. Even so, they meet all requirements of EN61558-2-4, EN61558-2-6



E4821 (EI 48/20,5)

10VA - Ta70°B

weight - 345gr.

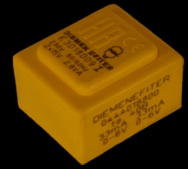

www.efiter.com

ENCAPSULATED TRANSFORMERS

According EN61558, EN60590, EN60472, UL506, UL1585, UL5085 · External protection

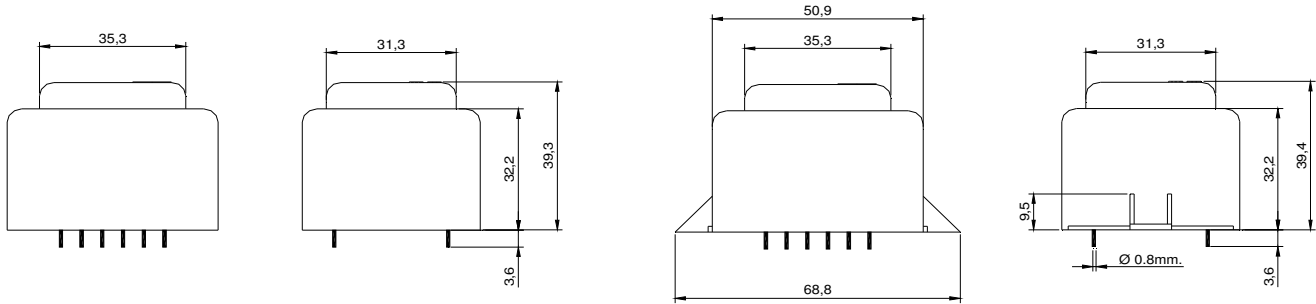

SINGLE SECONDARY, 10VA. Ta⁷⁰B

| HR REFERENCE | | HR REFERENCE with fixing holes | | Vo/Vsec=1,25 Vo-->Is=0 Vsec --> Isec=In | | Prot. Prim. 230V: 63mA/T 115V: 125mA/T |
|--------------|------------|--------------------------------|------------|--|--------|--|
| Prim. 230V | Prim. 115V | Prim. 230V | Prim. 115V | Vsec | Isec | Prot. Sec. mA/F |
| E4821064 | E4821164 | E4821564 | E4821664 | 4,5V | 2222mA | 2500mA |
| E4821050 | E4821150 | E4821550 | E4821650 | 6V | 1666mA | 2000mA |
| E4821052 | E4821152 | E4821552 | E4821652 | 7,5V | 1333mA | 1600mA |
| E4821054 | E4821154 | E4821554 | E4821654 | 9V | 1111mA | 1250mA |
| E4821056 | E4821156 | E4821556 | E4821656 | 12V | 833mA | 1000mA |
| E4821058 | E4821158 | E4821558 | E4821658 | 15V | 666mA | 800mA |
| E4821060 | E4821160 | E4821560 | E4821660 | 18V | 555mA | 630mA |
| E4821062 | E4821162 | E4821562 | E4821662 | 24V | 416mA | 500mA |

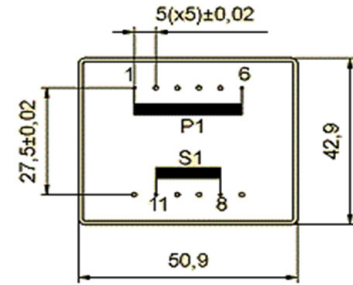

DUAL SECONDARY, 10VA. Ta⁷⁰B

| HR REFERENCE | | HR REFERENCE with fixing holes | | Vo/Vsec=1,25 Vo-->Is=0 Vsec --> Isec=In | | Prot. Prim. 230V: 63mA/T 115V: 125mA/T |
|--------------|------------|--------------------------------|------------|--|----------|--|
| Prim. 230V | Prim. 115V | Prim. 230V | Prim. 115V | Vsec | Isec | Prot. Sec. mA/F |
| E4821065 | E4821165 | E4821565 | E4821665 | 2x4,5V | 2x1111mA | 2x1250mA |
| E4821051 | E4821151 | E4821551 | E4821651 | 2x6V | 2x833mA | 2x1000mA |
| E4821053 | E4821153 | E4821553 | E4821653 | 2x7,5V | 2x666mA | 2x800mA |
| E4821055 | E4821155 | E4821555 | E4821655 | 2x9V | 2x555mA | 2x630mA |
| E4821007 | E4821157 | E4821557 | E4821657 | 2x12V | 2x416mA | 2x500mA |
| E4821009 | E4821159 | E4821559 | E4821659 | 2x15V | 2x333mA | 2x400mA |
| E4821061 | E4821161 | E4821561 | E4821661 | 2x18V | 2x277mA | 2x315mA |
| E4821063 | E4821163 | E4821563 | E4821663 | 2x24V | 2x208mA | 2x250mA |

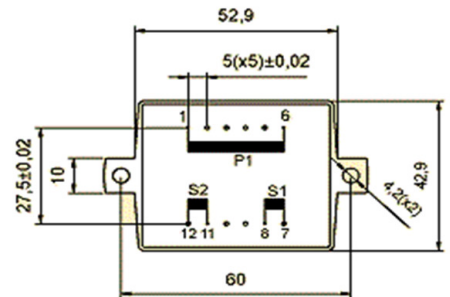

CENTER TAPPED, 10VA. Ta⁷⁰B

| HR REFERENCE | | HR REFERENCE with fixing holes | | Vo/Vsec=1,25 Vo-->Is=0 Vsec --> Isec=In | | Prot. Prim. 230V: 63mA/T 115V: 125mA/T |
|--------------|------------|--------------------------------|------------|--|----------|--|
| Prim. 230V | Prim. 115V | Prim. 230V | Prim. 115V | Vsec | Isec | Prot. Sec. mA/F |
| E4821085 | E4821185 | E4821585 | E4821685 | 2x4,5V | 2x1111mA | 2x1250mA |
| E4821071 | E4821171 | E4821571 | E4821671 | 2x6V | 2x833mA | 2x1000mA |
| E4821073 | E4821173 | E4821573 | E4821673 | 2x7,5V | 2x666mA | 2x800mA |
| E4821075 | E4821175 | E4821575 | E4821675 | 2x9V | 2x555mA | 2x630mA |
| E4821077 | E4821177 | E4821577 | E4821677 | 2x12V | 2x416mA | 2x500mA |
| E4821079 | E4821179 | E4821579 | E4821679 | 2x15V | 2x333mA | 2x400mA |
| E4821081 | E4821181 | E4821581 | E4821681 | 2x18V | 2x277mA | 2x315mA |
| E4821083 | E4821183 | E4821583 | E4821683 | 2x24V | 2x208mA | 2x250mA |

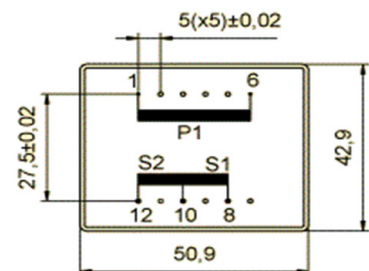

These models are non VDE approved. Even so, they meet all requirements of EN61558-2-4, EN61558-2-6



E5419 (EI 54/18,8)

16VA - Ta40°B

weight - 420gr.

www.efiter.com



ENCAPSULATED TRANSFORMERS

According EN61558, EN60590, EN60472, UL506, UL1585, UL5085 - External protection

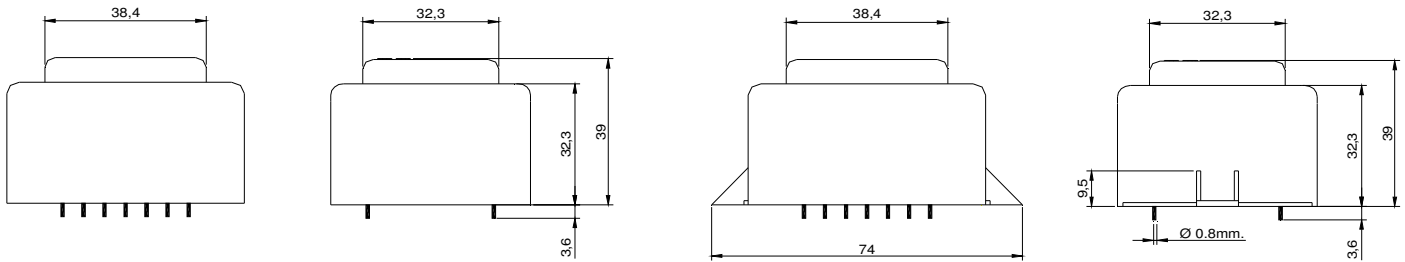

SINGLE SECONDARY, 16VA. Ta°40B

| HR REFERENCE | | HR REFERENCE with fixing holes | | Vo/Vsec=1,25 Vo-->Is=0 Vsec --> Isec=In | | Prot. Prim. 230V: 100mA/T 115V: 200mA/T |
|--------------|------------|--------------------------------|------------|--|--------|---|
| Prim. 230V | Prim. 115V | Prim. 230V | Prim. 115V | Vsec | Isec | Prot. Sec. mA/F |
| E5419014 | E5419114* | E5419514 | E5419614* | 4,5V | 3555mA | 4000mA |
| E5419000 | E5419100* | E5419500 | E5419600* | 6V | 2666mA | 3150mA |
| E5419002 | E5419102* | E5419502 | E5419602* | 7,5V | 2133mA | 2500mA |
| E5419004 | E5419104* | E5419504 | E5419604* | 9V | 1777mA | 2000mA |
| E5419006 | E5419106* | E5419506 | E5419606* | 12V | 1333mA | 1600mA |
| E5419008 | E5419108* | E5419508 | E5419608* | 15V | 1066mA | 1250mA |
| E5419010 | E5419110* | E5419510 | E5419610* | 18V | 888mA | 1000mA |
| E5419012 | E5419112* | E5419512 | E5419612* | 24V | 666mA | 800mA |

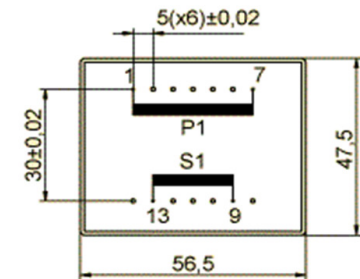

DUAL SECONDARY, 16VA. Ta°40B

| HR REFERENCE | | HR REFERENCE with fixing holes | | Vo/Vsec=1,25 Vo-->Is=0 Vsec --> Isec=In | | Prot. Prim. 230V: 100mA/T 115V: 200mA/T |
|--------------|------------|--------------------------------|------------|--|----------|---|
| Prim. 230V | Prim. 115V | Prim. 230V | Prim. 115V | Vsec | Isec | Prot. Sec. mA/F |
| E5419015 | E5419115* | E5419515 | E5419615* | 2x4,5V | 2x1777mA | 2x2000mA |
| E5419001 | E5419101* | E5419501 | E5419601* | 2x6V | 2x1333mA | 2x1600mA |
| E5419003 | E5419103* | E5419503 | E5419603* | 2x7,5V | 2x1066mA | 2x1250mA |
| E5419005 | E5419105* | E5419505 | E5419605* | 2x9V | 2x888mA | 2x1000mA |
| E5419007 | E5419107* | E5419507 | E5419607* | 2x12V | 2x666mA | 2x800mA |
| E5419009 | E5419109* | E5419509 | E5419609* | 2x15V | 2x533mA | 2x630mA |
| E5419011 | E5419111* | E5419511 | E5419611* | 2x18V | 2x444mA | 2x500mA |
| E5419013* | E5419113* | E5419513* | E5419613* | 2x24V | 2x333mA | 2x400mA |

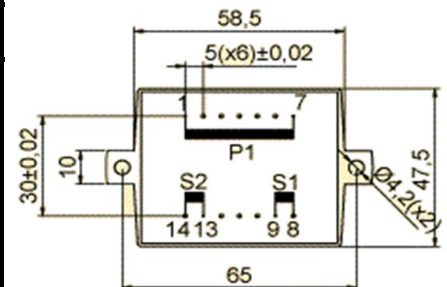

CENTER TAPPED, 16VA. Ta°40B

| HR REFERENCE | | HR REFERENCE with fixing holes | | Vo/Vsec=1,25 Vo-->Is=0 Vsec --> Isec=In | | Prot. Prim. 230V: 100mA/T 115V: 200mA/T |
|--------------|------------|--------------------------------|------------|--|----------|---|
| Prim. 230V | Prim. 115V | Prim. 230V | Prim. 115V | Vsec | Isec | Prot. Sec. mA/F |
| E5419035 | E5419135* | E5419535 | E5419635* | 2x4,5V | 2x1777mA | 2x2000mA |
| E5419021 | E5419121* | E5419521 | E5419621* | 2x6V | 2x1333mA | 2x1600mA |
| E5419023 | E5419123* | E5419523 | E5419623* | 2x7,5V | 2x1066mA | 2x1250mA |
| E5419025 | E5419125* | E5419525 | E5419625* | 2x9V | 2x888mA | 2x1000mA |
| E5419027 | E5419127* | E5419527 | E5419627* | 2x12V | 2x666mA | 2x800mA |
| E5419029 | E5419129* | E5419529 | E5419629* | 2x15V | 2x533mA | 2x630mA |
| E5419031 | E5419131* | E5419531 | E5419631* | 2x18V | 2x444mA | 2x500mA |
| E5419033* | E5419133* | E5419533* | E5419633* | 2x24V | 2x333mA | 2x400mA |

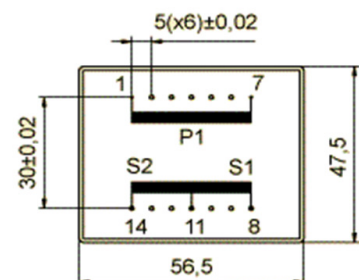

* these models are non VDE approved. Even so, they meet all requirements of EN61558-2-4, EN61558-2-6



E5419 (EI 54/18,8)

13VA - Ta70°B

weight - 420gr.



www.efiter.com

ENCAPSULATED TRANSFORMERS

According EN61558, EN60590, EN60472, UL506, UL1585, UL5085 - External protection

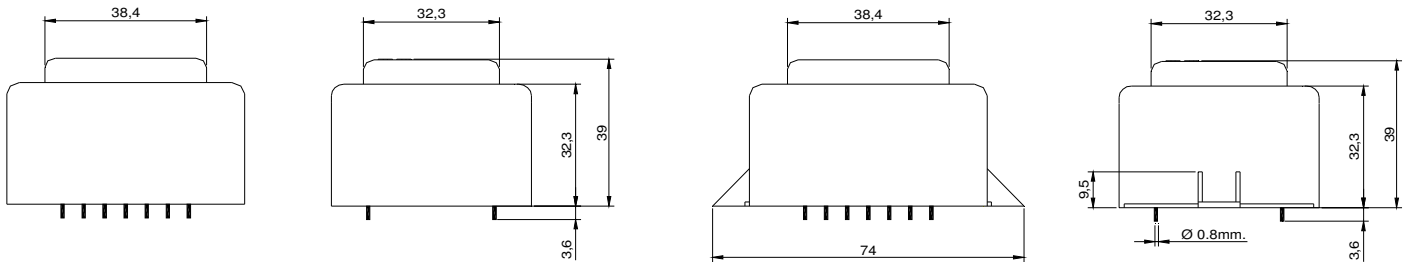

SINGLE SECONDARY, 13VA. Ta70°B

| HR REFERENCE | | HR REFERENCE with fixing holes | | Vo/Vsec=1,25 Vo-->Is=0 Vsec --> Isec=In | | Prot. Prim. 230V: 80mA/T 115V: 160mA/T |
|--------------|------------|--------------------------------|------------|--|--------|--|
| Prim. 230V | Prim. 115V | Prim. 230V | Prim. 115V | Vsec | Isec | Prot. Sec. mA/F |
| E5419014 | E5419114 | E5419514 | E5419614 | 4,5V | 2888mA | 3150mA |
| E5419000 | E5419100 | E5419500 | E5419600 | 6V | 2166mA | 2500mA |
| E5419002 | E5419102 | E5419502 | E5419602 | 7,5V | 1733mA | 2000mA |
| E5419004 | E5419104 | E5419504 | E5419604 | 9V | 1444mA | 1600mA |
| E5419006 | E5419106 | E5419506 | E5419606 | 12V | 1083mA | 1250mA |
| E5419008 | E5419108 | E5419508 | E5419608 | 15V | 866mA | 1000mA |
| E5419010 | E5419110 | E5419510 | E5419610 | 18V | 722mA | 800mA |
| E5419012 | E5419112 | E5419512 | E5419612 | 24V | 541mA | 630mA |

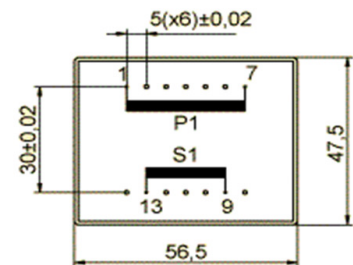

DUAL SECONDARY, 13VA. Ta70°B

| HR REFERENCE | | HR REFERENCE with fixing holes | | Vo/Vsec=1,25 Vo-->Is=0 Vsec --> Isec=In | | Prot. Prim. 230V: 80mA/T 115V: 160mA/T |
|--------------|------------|--------------------------------|------------|--|----------|--|
| Prim. 230V | Prim. 115V | Prim. 230V | Prim. 115V | Vsec | Isec | Prot. Sec. mA/F |
| E5419015 | E5419115 | E5419515 | E5419615 | 2x4,5V | 2x1444mA | 2x1600mA |
| E5419001 | E5419101 | E5419501 | E5419601 | 2x6V | 2x1083mA | 2x1250mA |
| E5419003 | E5419103 | E5419503 | E5419603 | 2x7,5V | 2x866mA | 2x1000mA |
| E5419005 | E5419105 | E5419505 | E5419605 | 2x9V | 2x722mA | 2x800mA |
| E5419007 | E5419107 | E5419507 | E5419607 | 2x12V | 2x541mA | 2x630mA |
| E5419009 | E5419109 | E5419509 | E5419609 | 2x15V | 2x433mA | 2x500mA |
| E5419011 | E5419111 | E5419511 | E5419611 | 2x18V | 2x361mA | 2x400mA |
| E5419013 | E5419113 | E5419513 | E5419613 | 2x24V | 2x270mA | 2x315mA |

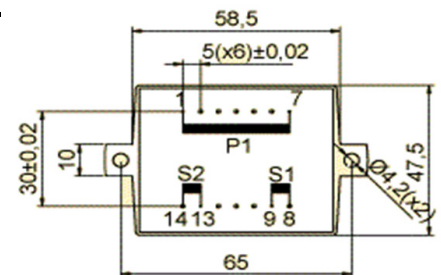

CENTER TAPPED, 13VA. Ta70°B

| HR REFERENCE | | HR REFERENCE with fixing holes | | Vo/Vsec=1,25 Vo-->Is=0 Vsec --> Isec=In | | Prot. Prim. 230V: 80mA/T 115V: 160mA/T |
|--------------|------------|--------------------------------|------------|--|----------|--|
| Prim. 230V | Prim. 115V | Prim. 230V | Prim. 115V | Vsec | Isec | Prot. Sec. mA/F |
| E5419035 | E5419135 | E5419535 | E5419635 | 2x4,5V | 2x1444mA | 2x1600mA |
| E5419021 | E5419121 | E5419521 | E5419621 | 2x6V | 2x1083mA | 2x1250mA |
| E5419023 | E5419123 | E5419523 | E5419623 | 2x7,5V | 2x866mA | 2x1000mA |
| E5419025 | E5419125 | E5419525 | E5419625 | 2x9V | 2x722mA | 2x800mA |
| E5419027 | E5419127 | E5419527 | E5419627 | 2x12V | 2x541mA | 2x630mA |
| E5419029 | E5419129 | E5419529 | E5419629 | 2x15V | 2x433mA | 2x500mA |
| E5419031 | E5419131 | E5419531 | E5419631 | 2x18V | 2x361mA | 2x400mA |
| E5419033 | E5419133 | E5419533 | E5419633 | 2x24V | 2x270mA | 2x315mA |

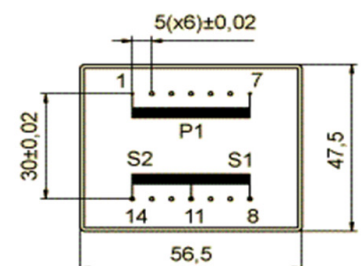

These models are non VDE approved. Even so, they meet all requirements of EN61558-2-4, EN61558-2-6



E6021 (EI 60/21)

25VA - Ta40°B

weight - 570gr.

www.efiter.com



ENCAPSULATED TRANSFORMERS

According EN61558, EN60590, EN60472, UL506, UL1585, UL5085 · External protection

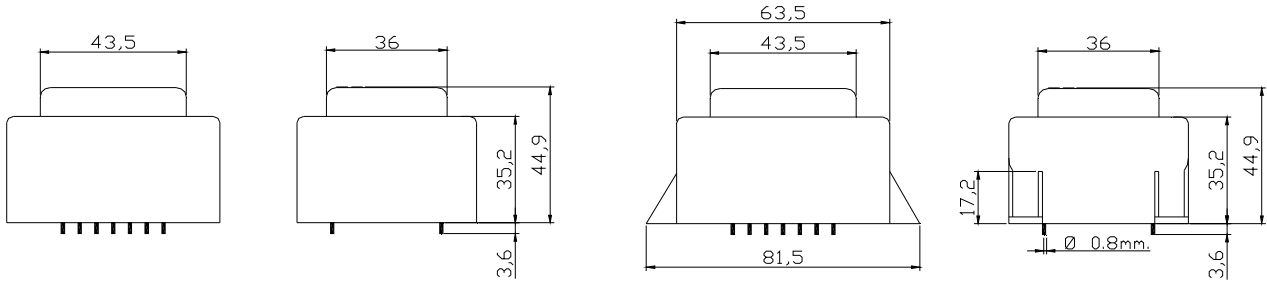

SINGLE SECONDARY, 25VA. Ta°40B

| HR REFERENCE | | HR REFERENCE with fixing holes | | Vo/Vsec=1,2 Vo-->Is=0 Vsec --> Isec=In | | Prot. Prim. 230V: 160mA/T 115V: 315mA/T |
|--------------|------------|--------------------------------|------------|---|--------|---|
| Prim. 230V | Prim. 115V | Prim. 230V | Prim. 115V | Vsec | Isec | Prot. Sec. mA/F |
| E6021014 | E6021114 | E6021514 | E6021614 | 4,5V | 5555mA | 6000mA |
| E6021000 | E6021100 | E6021500 | E6021600 | 6V | 4166mA | 5000mA |
| E6021002 | E6021102 | E6021502 | E6021602 | 7,5V | 3333mA | 4000mA |
| E6021004 | E6021104 | E6021504 | E6021604 | 9V | 2777mA | 3150mA |
| E6021006 | E6021106 | E6021506 | E6021606 | 12V | 2083mA | 2500mA |
| E6021008 | E6021108 | E6021508 | E6021608 | 15V | 1666mA | 2000mA |
| E6021010 | E6021110 | E6021510 | E6021610 | 18V | 1388mA | 1600mA |
| E6021012 | E6021112 | E6021512 | E6021612 | 24V | 1041mA | 1250mA |

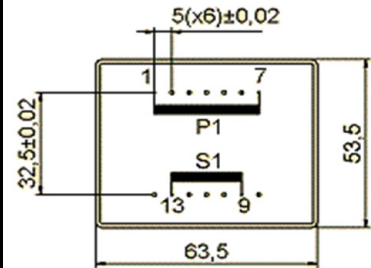

DUAL SECONDARY, 25VA. Ta°40B

| HR REFERENCE | | HR REFERENCE with fixing holes | | Vo/Vsec=1,2 Vo-->Is=0 Vsec --> Isec=In | | Prot. Prim. 230V: 160mA/T 115V: 315mA/T |
|--------------|------------|--------------------------------|------------|---|----------|---|
| Prim. 230V | Prim. 115V | Prim. 230V | Prim. 115V | Vsec | Isec | Prot. Sec. mA/F |
| E6021015 | E6021115 | E6021515 | E6021615 | 2x4,5V | 2x2777mA | 2x3150mA |
| E6021001 | E6021101 | E6021501 | E6021601 | 2x6V | 2x2083mA | 2x2500mA |
| E6021003 | E6021103 | E6021503 | E6021603 | 2x7,5V | 2x1666mA | 2x2000mA |
| E6021005 | E6021105 | E6021505 | E6021605 | 2x9V | 2x1388mA | 2x1600mA |
| E6021007 | E6021107 | E6021507 | E6021607 | 2x12V | 2x1041mA | 2x1250mA |
| E6021009 | E6021109 | E6021509 | E6021609 | 2x15V | 2x833mA | 2x1000mA |
| E6021011 | E6021111 | E6021511 | E6021611 | 2x18V | 2x694mA | 2x800mA |
| E6021013 | E6021113 | E6021513 | E6021613 | 2x24V | 2x520mA | 2x630mA |

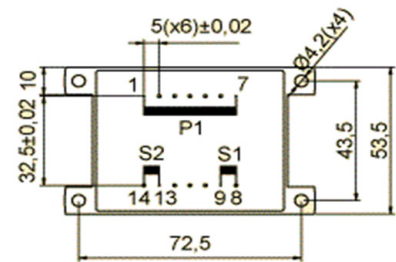

CENTER TAPPED, 25VA. Ta°40B

| HR REFERENCE | | HR REFERENCE with fixing holes | | Vo/Vsec=1,2 Vo-->Is=0 Vsec --> Isec=In | | Prot. Prim. 230V: 160mA/T 115V: 315mA/T |
|--------------|------------|--------------------------------|------------|---|----------|---|
| Prim. 230V | Prim. 115V | Prim. 230V | Prim. 115V | Vsec | Isec | Prot. Sec. mA/F |
| E6021035 | E6021135 | E6021535 | E6021635 | 2x4,5V | 2x2777mA | 2x3150mA |
| E6021021 | E6021121 | E6021521 | E6021621 | 2x6V | 2x2083mA | 2x2500mA |
| E6021023 | E6021123 | E6021523 | E6021623 | 2x7,5V | 2x1666mA | 2x2000mA |
| E6021025 | E6021125 | E6021525 | E6021625 | 2x9V | 2x1388mA | 2x1600mA |
| E6021027 | E6021127 | E6021527 | E6021627 | 2x12V | 2x1041mA | 2x1250mA |
| E6021029 | E6021129 | E6021529 | E6021629 | 2x15V | 2x833mA | 2x1000mA |
| E6021031 | E6021131 | E6021531 | E6021631 | 2x18V | 2x694mA | 2x800mA |
| E6021033 | E6021133 | E6021533 | E6021633 | 2x24V | 2x520mA | 2x630mA |

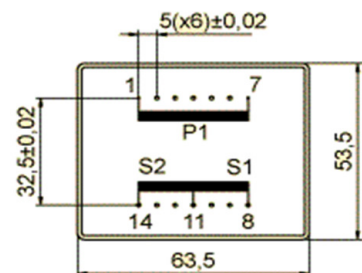

These models are non VDE approved. Even so, they meet all requirements of EN61558-2-4, EN61558-2-6



E6021 (EI 60/21)

20VA - Ta70°B

weight - 570gr.

www.efiter.com



ENCAPSULATED TRANSFORMERS

According EN61558, EN60590, EN60472, UL506, UL1585, UL5085 · External protection

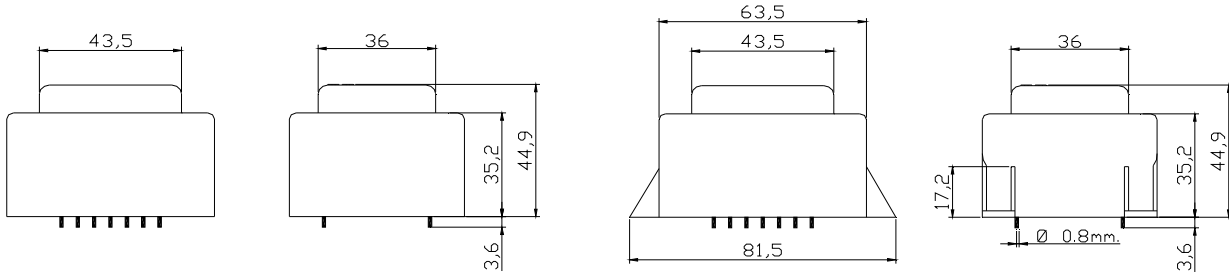

SINGLE SECONDARY, 20VA. Ta°70B

| HR REFERENCE | | HR REFERENCE with fixing holes | | Vo/Vsec=1,2 Vo-->Is=0 Vsec --> Isec=In | | Prot. Prim. 230V: 125mA/T 115V: 250mA/T |
|--------------|------------|--------------------------------|------------|---|--------|---|
| Prim. 230V | Prim. 115V | Prim. 230V | Prim. 115V | Vsec | Isec | Prot. Sec. mA/F |
| E6021064 | E6021164* | E6021564 | E6021664* | 4,5V | 4444mA | 5000mA |
| E6021050 | E6021150* | E6021550 | E6021650* | 6V | 3333mA | 4000mA |
| E6021052 | E6021152* | E6021552 | E6021652* | 7,5V | 2666mA | 3150mA |
| E6021054 | E6021154* | E6021554 | E6021654* | 9V | 2222mA | 2500mA |
| E6021056 | E6021156* | E6021556 | E6021656* | 12V | 1666mA | 2000mA |
| E6021058 | E6021158* | E6021558 | E6021658* | 15V | 1333mA | 1600mA |
| E6021060 | E6021160 | E6021560 | E6021660* | 18V | 1111mA | 1250mA |
| E6021062 | E6021162* | E6021562 | E6021662* | 24V | 833mA | 1000mA |

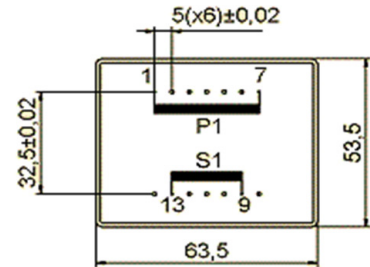

DUAL SECONDARY, 20VA. Ta°70B

| HR REFERENCE | | HR REFERENCE with fixing holes | | Vo/Vsec=1,2 Vo-->Is=0 Vsec --> Isec=In | | Prot. Prim. 230V: 125mA/T 115V: 250mA/T |
|--------------|------------|--------------------------------|------------|---|----------|---|
| Prim. 230V | Prim. 115V | Prim. 230V | Prim. 115V | Vsec | Isec | Prot. Sec. mA/F |
| E6021065 | E6021165* | E6021565 | E6021665* | 2x4,5V | 2x2222mA | 2x2500mA |
| E6021051 | E6021151* | E6021551 | E6021651* | 2x6V | 2x1666mA | 2x2000mA |
| E6021053 | E6021153* | E6021553 | E6021653* | 2x7,5V | 2x1333mA | 2x1600mA |
| E6021055 | E6021155* | E6021555 | E6021655* | 2x9V | 2x1111mA | 2x1250mA |
| E6021057 | E6021157* | E6021557 | E6021657* | 2x12V | 2x833mA | 2x1000mA |
| E6021059 | E6021159* | E6021559 | E6021659* | 2x15V | 2x666mA | 2x800mA |
| E6021061 | E6021161* | E6021561 | E6021661* | 2x18V | 2x555mA | 2x630mA |
| E6021063* | E6021163* | E6021563* | E6021663* | 2x24V | 2x416mA | 2x500mA |

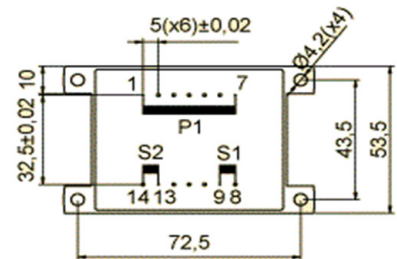

CENTER TAPPED, 20VA. Ta°70B

| HR REFERENCE | | HR REFERENCE with fixing holes | | Vo/Vsec=1,2 Vo-->Is=0 Vsec --> Isec=In | | Prot. Prim. 230V: 125mA/T 115V: 250mA/T |
|--------------|------------|--------------------------------|------------|---|----------|---|
| Prim. 230V | Prim. 115V | Prim. 230V | Prim. 115V | Vsec | Isec | Prot. Sec. mA/F |
| E6021085 | E6021185* | E6021585 | E6021685* | 2x4,5V | 2x2222mA | 2x2500mA |
| E6021071 | E6021171* | E6021571 | E6021671* | 2x6V | 2x1666mA | 2x2000mA |
| E6021073 | E6021173* | E6021573 | E6021673 | 2x7,5V | 2x1333mA | 2x1600mA |
| E6021075 | E6021175* | E6021575 | E6021675* | 2x9V | 2x1111mA | 2x1250mA |
| E6021077 | E6021177* | E6021577 | E6021677* | 2x12V | 2x833mA | 2x1000mA |
| E6021079 | E6021179* | E6021579 | E6021679* | 2x15V | 2x666mA | 2x800mA |
| E6021081 | E6021181* | E6021581 | E6021681* | 2x18V | 2x555mA | 2x630mA |
| E6021083* | E6021183* | E6021583* | E6021683* | 2x24V | 2x416mA | 2x500mA |

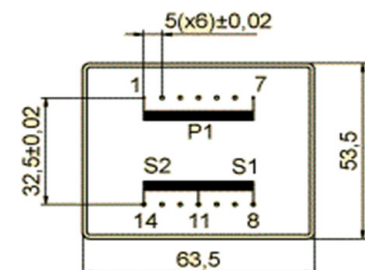

* these models are non VDE approved. Even so, they meet all requirements of EN61558-2-4, EN61558-2-6



E6026 (EI 60/25,5)

30VA - Ta40°B

weight - 675gr.

www.efiter.com



ENCAPSULATED TRANSFORMERS

According EN61558, EN60590, EN60472, UL506, UL1585, UL5085 · External protection

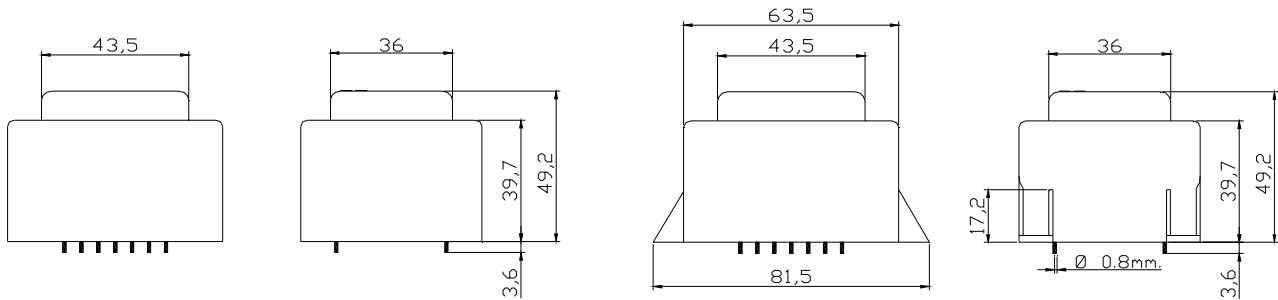

SINGLE SECONDARY, 30VA. Ta°40B

| HR REFERENCE | | HR REFERENCE with fixing holes | | Vo/Vsec=1,2 Vo-->Is=0 Vsec --> Isec=In | | Prot. Prim. 230V: 200mA/T 115V: 400mA/T |
|--------------|------------|--------------------------------|------------|---|--------|---|
| Prim. 230V | Prim. 115V | Prim. 230V | Prim. 115V | Vsec | Isec | Prot. Sec. mA/F |
| E6026014 | E6026114 | E6026514 | E6026614 | 4,5V | 6666mA | 8000mA |
| E6026000 | E6026100 | E6026500 | E6026600 | 6V | 5000mA | 6000mA |
| E6026002 | E6026102 | E6026502 | E6026602 | 7,5V | 4000mA | 5000mA |
| E6026004 | E6026104 | E6026504 | E6026604 | 9V | 3333mA | 3150mA |
| E6026006 | E6026106 | E6026506 | E6026606 | 12V | 2500mA | 3000mA |
| E6026008 | E6026108 | E6026508 | E6026608 | 15V | 2000mA | 2500mA |
| E6026010 | E6026110 | E6026510 | E6026610 | 18V | 1666mA | 2000mA |
| E6026012 | E6026112 | E6026512 | E6026612 | 24V | 1250mA | 1600mA |

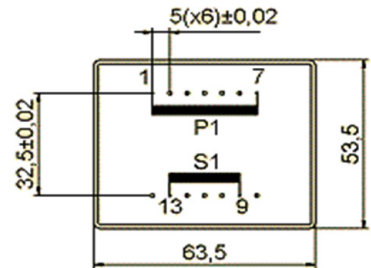

DUAL SECONDARY, 30VA. Ta°40B

| HR REFERENCE | | HR REFERENCE with fixing holes | | Vo/Vsec=1,2 Vo-->Is=0 Vsec --> Isec=In | | Prot. Prim. 230V: 200mA/T 115V: 400mA/T |
|--------------|------------|--------------------------------|------------|---|----------|---|
| Prim. 230V | Prim. 115V | Prim. 230V | Prim. 115V | Vsec | Isec | Prot. Sec. mA/F |
| E6026015 | E6026115 | E6026515 | E6026615 | 2x4,5V | 2x3333mA | 2x4000mA |
| E6026001 | E6026101 | E6026501 | E6026601 | 2x6V | 2x2500mA | 2x3150mA |
| E6026003 | E6026103 | E6026503 | E6026603 | 2x7,5V | 2x2000mA | 2x2500mA |
| E6026005 | E6026105 | E6026505 | E6026605 | 2x9V | 2x1666mA | 2x2000mA |
| E6026007 | E6026107 | E6026507 | E6026607 | 2x12V | 2x1250mA | 2x1600mA |
| E6026009 | E6026109 | E6026509 | E6026609 | 2x15V | 2x1000mA | 2x1250mA |
| E6026011 | E6026111 | E6026511 | E6026611 | 2x18V | 2x833mA | 2x1000mA |
| E6026013 | E6026113 | E6026513 | E6026613 | 2x24V | 2x625mA | 2x800mA |

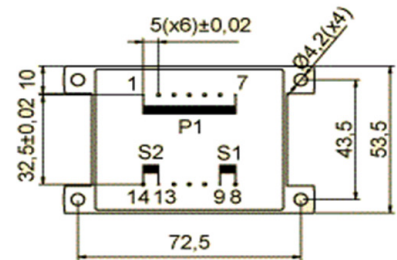

CENTER TAPPED, 30VA. Ta°40B

| HR REFERENCE | | HR REFERENCE with fixing holes | | Vo/Vsec=1,2 Vo-->Is=0 Vsec --> Isec=In | | Prot. Prim. 230V: 200mA/T 115V: 400mA/T |
|--------------|------------|--------------------------------|------------|---|----------|---|
| Prim. 230V | Prim. 115V | Prim. 230V | Prim. 115V | Vsec | Isec | Prot. Sec. mA/F |
| E6026035 | E6026135 | E6026535 | E6026635 | 2x4,5V | 2x3333mA | 2x4000mA |
| E6026021 | E6026121 | E6026521 | E6026621 | 2x6V | 2x2500mA | 2x3150mA |
| E6026023 | E6026123 | E6026523 | E6026623 | 2x7,5V | 2x2000mA | 2x2500mA |
| E6026025 | E6026125 | E6026525 | E6026625 | 2x9V | 2x1666mA | 2x2000mA |
| E6026027 | E6026127 | E6026527 | E6026627 | 2x12V | 2x1250mA | 2x1600mA |
| E6026029 | E6026129 | E6026529 | E6026629 | 2x15V | 2x1000mA | 2x1250mA |
| E6026031 | E6026131 | E6026531 | E6026631 | 2x18V | 2x833mA | 2x1000mA |
| E6026033 | E6026133 | E6026533 | E6026633 | 2x24V | 2x625mA | 2x800mA |

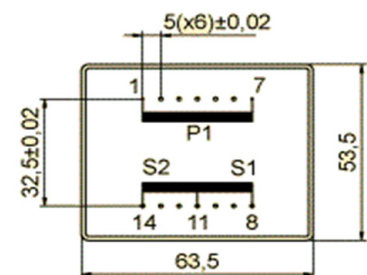

These models are non VDE approved. Even so, they meet all requirements of EN61558-2-4, EN61558-2-6



E6026 (EI 60/25,5)

24VA - Ta40°B

weight - 675gr.

www.efiter.com



ENCAPSULATED TRANSFORMERS

According EN61558, EN60590, EN60472, UL506, UL1585, UL5085 · External protection

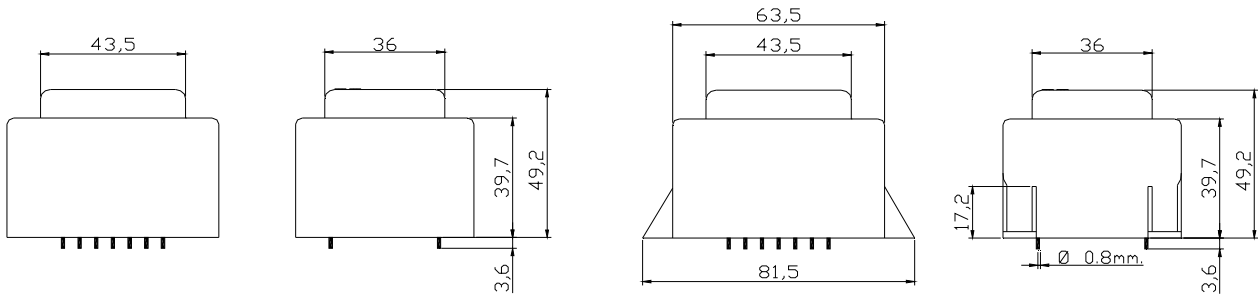

SINGLE SECONDARY, 24VA. Ta°70B

| HR REFERENCE | | HR REFERENCE with fixing holes | | Vo/Vsec=1,2 Vo-->Is=0 Vsec --> Isec=In | | Prot. Prim. 230V: 200mA/T 115V: 400mA/T |
|--------------|------------|--------------------------------|------------|---|--------|---|
| Prim. 230V | Prim. 115V | Prim. 230V | Prim. 115V | Vsec | Isec | Prot. Sec. mA/F |
| E6026064 | E6026164 | E6026564 | E6026664 | 4,5V | 5333mA | 6000mA |
| E6026050 | E6026150 | E6026550 | E6026650 | 6V | 4000mA | 5000mA |
| E6026052 | E6026152 | E6026552 | E6026652 | 7,5V | 3200mA | 4000mA |
| E6026054 | E6026154 | E6026554 | E6026654 | 9V | 2666mA | 3150mA |
| E6026056 | E6026156 | E6026556 | E6026656 | 12V | 2000mA | 2500mA |
| E6026058 | E6026158 | E6026558 | E6026658 | 15V | 1600mA | 2000mA |
| E6026060 | E6026160 | E6026560 | E6026660 | 18V | 1333mA | 1600mA |
| E6026062 | E6026162 | E6026562 | E6026662 | 24V | 1000mA | 1250mA |

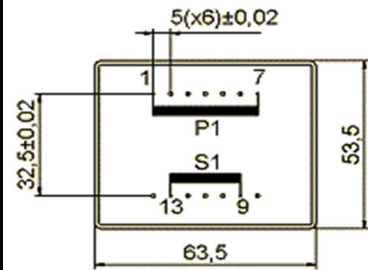

DUAL SECONDARY, 24VA. Ta°70B

| HR REFERENCE | | HR REFERENCE with fixing holes | | Vo/Vsec=1,2 Vo-->Is=0 Vsec --> Isec=In | | Prot. Prim. 230V: 200mA/T 115V: 400mA/T |
|--------------|------------|--------------------------------|------------|---|----------|---|
| Prim. 230V | Prim. 115V | Prim. 230V | Prim. 115V | Vsec | Isec | Prot. Sec. mA/F |
| E6026065 | E6026165 | E6026565 | E6026665 | 2x4,5V | 2x2666mA | 2x3150mA |
| E6026051 | E6026151 | E6026551 | E6026651 | 2x6V | 2x2000mA | 2x2500mA |
| E6026053 | E6026153 | E6026553 | E6026653 | 2x7,5V | 2x1600mA | 2x2000mA |
| E6026055 | E6026155 | E6026555 | E6026655 | 2x9V | 2x1333mA | 2x1600mA |
| E6026057 | E6026157 | E6026557 | E6026657 | 2x12V | 2x1000mA | 2x1250mA |
| E6026059 | E6026159 | E6026559 | E6026659 | 2x15V | 2x800mA | 2x1000mA |
| E6026061 | E6026161 | E6026561 | E6026661 | 2x18V | 2x666mA | 2x800mA |
| E6026063 | E6026163 | E6026563 | E6026663 | 2x24V | 2x500mA | 2x630mA |

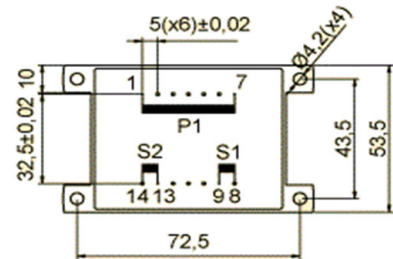

CENTER TAPPED, 24VA. Ta°70B

| HR REFERENCE | | HR REFERENCE with fixing holes | | Vo/Vsec=1,2 Vo-->Is=0 Vsec --> Isec=In | | Prot. Prim. 230V: 200mA/T 115V: 400mA/T |
|--------------|------------|--------------------------------|------------|---|----------|---|
| Prim. 230V | Prim. 115V | Prim. 230V | Prim. 115V | Vsec | Isec | Prot. Sec. mA/F |
| E6026085 | E6026185 | E6026585 | E6026685 | 2x4,5V | 2x2666mA | 2x3150mA |
| E6026071 | E6026171 | E6026571 | E6026671 | 2x6V | 2x2000mA | 2x2500mA |
| E6026073 | E6026173 | E6026573 | E6026673 | 2x7,5V | 2x1600mA | 2x2000mA |
| E6026075 | E6026175 | E6026575 | E6026675 | 2x9V | 2x1333mA | 2x1600mA |
| E6026077 | E6026177 | E6026577 | E6026677 | 2x12V | 2x1000mA | 2x1250mA |
| E6026079 | E6026179 | E6026579 | E6026679 | 2x15V | 2x800mA | 2x1000mA |
| E6026081 | E6026181 | E6026581 | E6026681 | 2x18V | 2x666mA | 2x800mA |
| E6026083 | E6026183 | E6026583 | E6026683 | 2x24V | 2x500mA | 2x630mA |

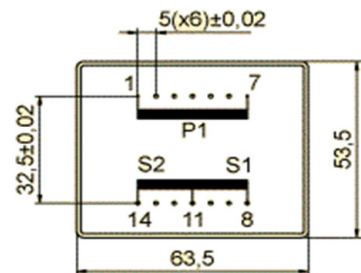

These models are non VDE approved. Even so, they meet all requirements of EN61558-2-4, EN61558-2-6



E6031 (EI 60/30,5)

35VA - Ta40°B

weight - 775gr.

www.efiter.com

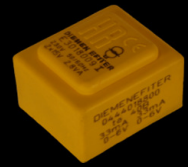

ENCAPSULATED TRANSFORMERS

According EN61558, EN60590, EN60472, UL506, UL1585, UL5085 · External protection

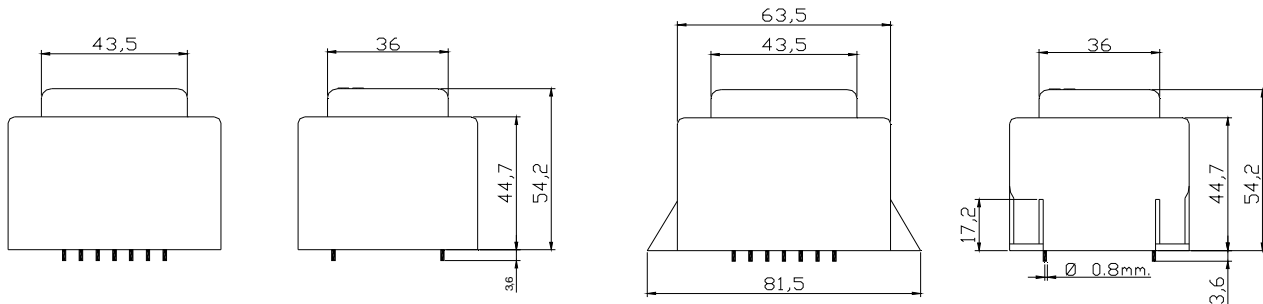

SINGLE SECONDARY, 35VA. Ta°40B

| HR REFERENCE | | HR REFERENCE with fixing holes | | Vo/Vsec=1,2 Vo-->Is=0 Vsec --> Isec=In | | Prot. Prim. 230V: 200mA/T 115V: 400mA/T |
|--------------|------------|--------------------------------|------------|---|--------|---|
| Prim. 230V | Prim. 115V | Prim. 230V | Prim. 115V | Vsec | Isec | Prot. Sec. mA/F |
| E6031014 | E6031114 | E6031514 | E6031614 | 4,5V | 7777mA | 8000mA |
| E6031000 | E6031100 | E6031500 | E6031600 | 6V | 5833mA | 6000mA |
| E6031002 | E6031102 | E6031502 | E6031602 | 7,5V | 4666mA | 5000mA |
| E6031004 | E6031104 | E6031504 | E6031604 | 9V | 3888mA | 4000mA |
| E6031006 | E6031106 | E6031506 | E6031606 | 12V | 2916mA | 3000mA |
| E6031008 | E6031108 | E6031508 | E6031608 | 15V | 2333mA | 2500mA |
| E6031010 | E6031110 | E6031510 | E6031610 | 18V | 1944mA | 2000mA |
| E6031012 | E6031112 | E6031512 | E6031612 | 24V | 1458mA | 1600mA |

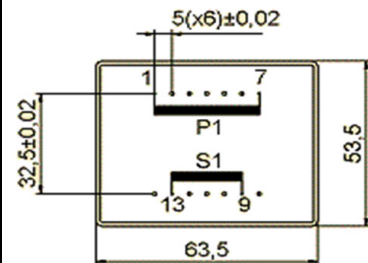

DUAL SECONDARY, 35VA. Ta°40B

| HR REFERENCE | | HR REFERENCE with fixing holes | | Vo/Vsec=1,2 Vo-->Is=0 Vsec --> Isec=In | | Prot. Prim. 230V: 200mA/T 115V: 400mA/T |
|--------------|------------|--------------------------------|------------|---|----------|---|
| Prim. 230V | Prim. 115V | Prim. 230V | Prim. 115V | Vsec | Isec | Prot. Sec. mA/F |
| E6031015 | E6031115 | E6031515 | E6031615 | 2x4,5V | 2x3888mA | 2x4000mA |
| E6031001 | E6031101 | E6031501 | E6031601 | 2x6V | 2x2916mA | 2x3150mA |
| E6031003 | E6031103 | E6031503 | E6031603 | 2x7,5V | 2x2333mA | 2x2500mA |
| E6031005 | E6031105 | E6031505 | E6031605 | 2x9V | 2x1944mA | 2x2000mA |
| E6031007 | E6031107 | E6031507 | E6031607 | 2x12V | 2x1458mA | 2x1600mA |
| E6031009 | E6031109 | E6031509 | E6031609 | 2x15V | 2x1166mA | 2x1250mA |
| E6031011 | E6031111 | E6031511 | E6031611 | 2x18V | 2x972mA | 2x1000mA |
| E6031013 | E6031113 | E6031513 | E6031613 | 2x24V | 2x729mA | 2x800mA |

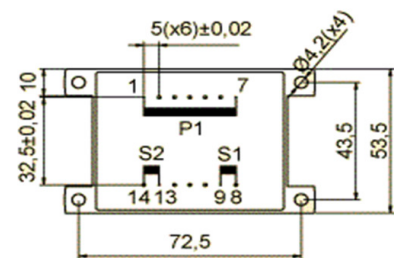

CENTER TAPPED, 35VA. Ta°40B

| HR REFERENCE | | HR REFERENCE with fixing holes | | Vo/Vsec=1,2 Vo-->Is=0 Vsec --> Isec=In | | Prot. Prim. 230V: 200mA/T 115V: 400mA/T |
|--------------|------------|--------------------------------|------------|---|----------|---|
| Prim. 230V | Prim. 115V | Prim. 230V | Prim. 115V | Vsec | Isec | Prot. Sec. mA/F |
| E6031035 | E6031135 | E6031535 | E6031635 | 2x4,5V | 2x3888mA | 2x4000mA |
| E6031021 | E6031121 | E6031521 | E6031621 | 2x6V | 2x2916mA | 2x3150mA |
| E6031023 | E6031123 | E6031523 | E6031623 | 2x7,5V | 2x2333mA | 2x2500mA |
| E6031025 | E6031125 | E6031525 | E6031625 | 2x9V | 2x1944mA | 2x2000mA |
| E6031027 | E6031127 | E6031527 | E6031627 | 2x12V | 2x1458mA | 2x1600mA |
| E6031029 | E6031129 | E6031529 | E6031629 | 2x15V | 2x1166mA | 2x1250mA |
| E6031031 | E6031131 | E6031531 | E6031631 | 2x18V | 2x972mA | 2x1000mA |
| E6031033 | E6031133 | E6031533 | E6031633 | 2x24V | 2x729mA | 2x800mA |

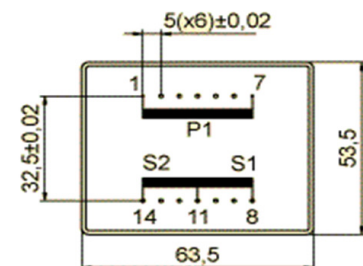

These models are non VDE approved. Even so, they meet all requirements of EN61558-2-4, EN61558-2-6



E6031 (EI 60/30,5)

30VA - Ta70°B

weight - 775gr.



www.efiter.com

ENCAPSULATED TRANSFORMERS

According EN61558, EN60590, EN60472, UL506, UL1585, UL5085 · External protection

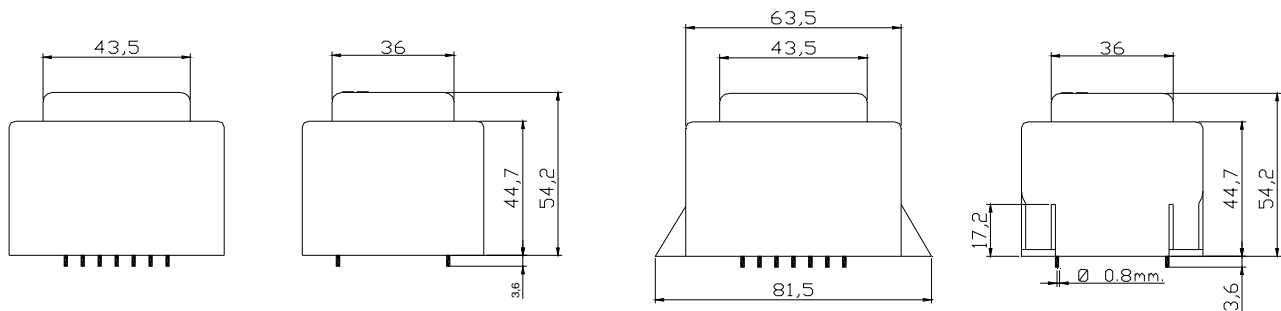

SINGLE SECONDARY, 30VA. Ta70B

| HR REFERENCE | | HR REFERENCE with fixing holes | | Vo/Vsec=1,2 Vo-->Is=0 Vsec --> Isec=In | | Prot. Prim. 230V: 200mA/T 115V: 400mA/T |
|--------------|------------|--------------------------------|------------|---|--------|---|
| Prim. 230V | Prim. 115V | Prim. 230V | Prim. 115V | Vsec | Isec | Prot. Sec. mA/F |
| E6031014 | E6031114 | E6031514 | E6031614 | 4,5V | 6666mA | 8000mA |
| E6031000 | E6031100 | E6031500 | E6031600 | 6V | 5000mA | 6000mA |
| E6031002 | E6031102 | E6031502 | E6031602 | 7,5V | 4000mA | 5000mA |
| E6031004 | E6031104 | E6031504 | E6031604 | 9V | 3333mA | 3150mA |
| E6031006 | E6031106 | E6031506 | E6031606 | 12V | 2500mA | 3000mA |
| E6031008 | E6031108 | E6031508 | E6031608 | 15V | 2000mA | 2500mA |
| E6031010 | E6031110 | E6031510 | E6031610 | 18V | 1666mA | 2000mA |
| E6031012 | E6031112 | E6031512 | E6031612 | 24V | 1250mA | 1600mA |

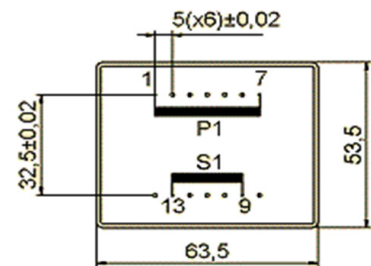

DUAL SECONDARY, 30VA. Ta70B

| HR REFERENCE | | HR REFERENCE with fixing holes | | Vo/Vsec=1,2 Vo-->Is=0 Vsec --> Isec=In | | Prot. Prim. 230V: 200mA/T 115V: 400mA/T |
|--------------|------------|--------------------------------|------------|---|----------|---|
| Prim. 230V | Prim. 115V | Prim. 230V | Prim. 115V | Vsec | Isec | Prot. Sec. mA/F |
| E6031015 | E6031115 | E6031515 | E6031615 | 2x4,5V | 2x3333mA | 2x4000mA |
| E6031001 | E6031101 | E6031501 | E6031601 | 2x6V | 2x2500mA | 2x3150mA |
| E6031003 | E6031103 | E6031503 | E6031603 | 2x7,5V | 2x2000mA | 2x2500mA |
| E6031005 | E6031105 | E6031505 | E6031605 | 2x9V | 2x1666mA | 2x2000mA |
| E6031007 | E6031107 | E6031507 | E6031607 | 2x12V | 2x1250mA | 2x1600mA |
| E6031009 | E6031109 | E6031509 | E6031609 | 2x15V | 2x1000mA | 2x1250mA |
| E6031011 | E6031111 | E6031511 | E6031611 | 2x18V | 2x833mA | 2x1000mA |
| E6031013 | E6031113 | E6031513 | E6031613 | 2x24V | 2x625mA | 2x800mA |

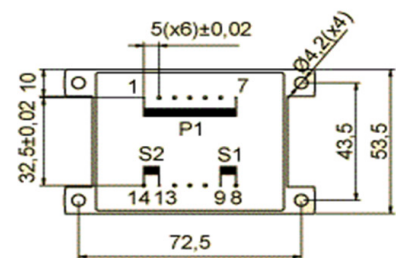

CENTER TAPPED, 30VA. Ta70B

| HR REFERENCE | | HR REFERENCE with fixing holes | | Vo/Vsec=1,2 Vo-->Is=0 Vsec --> Isec=In | | Prot. Prim. 230V: 200mA/T 115V: 400mA/T |
|--------------|------------|--------------------------------|------------|---|----------|---|
| Prim. 230V | Prim. 115V | Prim. 230V | Prim. 115V | Vsec | Isec | Prot. Sec. mA/F |
| E6031035 | E6031135 | E6031535 | E6031635 | 2x4,5V | 2x3333mA | 2x4000mA |
| E6031021 | E6031121 | E6031521 | E6031621 | 2x6V | 2x2500mA | 2x3150mA |
| E6031023 | E6031123 | E6031523 | E6031623 | 2x7,5V | 2x2000mA | 2x2500mA |
| E6031025 | E6031125 | E6031525 | E6031625 | 2x9V | 2x1666mA | 2x2000mA |
| E6031027 | E6031127 | E6031527 | E6031627 | 2x12V | 2x1250mA | 2x1600mA |
| E6031029 | E6031129 | E6031529 | E6031629 | 2x15V | 2x1000mA | 2x1250mA |
| E6031031 | E6031131 | E6031531 | E6031631 | 2x18V | 2x833mA | 2x1000mA |
| E6031033 | E6031133 | E6031533 | E6031633 | 2x24V | 2x625mA | 2x800mA |

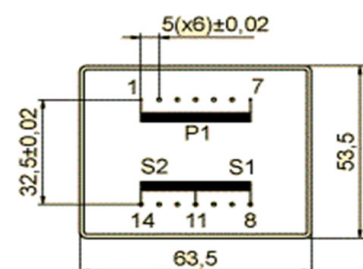

These models are non VDE approved. Even so, they meet all requirements of EN61558-2-4, EN61558-2-6



U3006 (UI 30/5,5)

3VA - Ta40°C

2,4VA - Ta70°C

weight - 130gr.

www.efiter.com



ENCAPSULATED TRANSFORMERS

According EN61558, EN60590, EN60472, UL506, UL1585, UL5085 · Short circuit proof

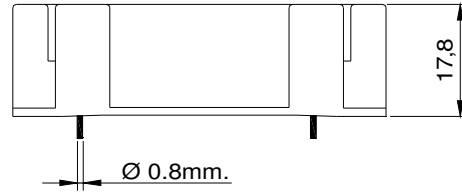
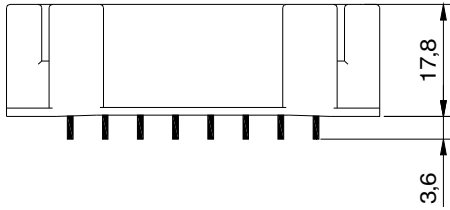

3VA. Ta40°C

| HR REFERENCE | | Vo/Vsec=1,7 Vo --> Is=0 Vsec --> Isec=In | | Protection |
|--------------|----------|---|---------|---------------------|
| U30060xx | U30065xx | Vsec | Isec | |
| U3006007 | U3006507 | 2x4,5V | 2x333mA | Short circuit proof |
| U3006000 | U3006500 | 2x6V | 2x250mA | |
| U3006001 | U3006501 | 2x7,5V | 2x200mA | |
| U3006002 | U3006502 | 2x9V | 2x166mA | |
| U3006003 | U3006503 | 2x12V | 2x125mA | |
| U3006004 | U3006504 | 2x15V | 2x100mA | |
| U3006005 | U3006505 | 2x18V | 2x83mA | |
| U3006006 | U3006506 | 2x24V | 2x62mA | |

U30xx0xx

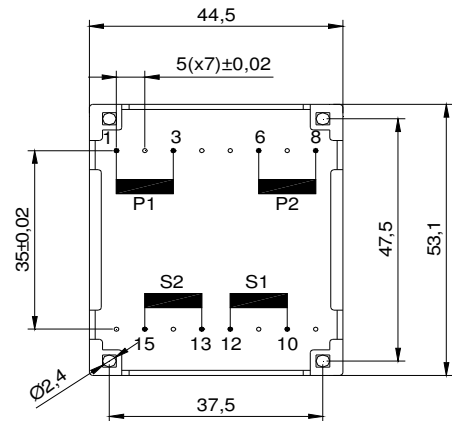

2,4VA. Ta70°C

| HR REFERENCE | | Vo/Vsec=1,7 Vo --> Is=0 Vsec --> Isec=In | | Protection |
|--------------|----------|---|---------|---------------------|
| U30060xx | U30065xx | Vsec | Isec | |
| U3006057 | U3006557 | 2x4,5V | 2x266mA | Short circuit proof |
| U3006050 | U3006550 | 2x6V | 2x200mA | |
| U3006051 | U3006551 | 2x7,5V | 2x160mA | |
| U3006052 | U3006552 | 2x9V | 2x133mA | |
| U3006053 | U3006553 | 2x12V | 2x100mA | |
| U3006054 | U3006554 | 2x15V | 2x80mA | |
| U3006055 | U3006555 | 2x18V | 2x66mA | |
| U3006056 | U3006556 | 2x24V | 2x50mA | |

U30xx5xx

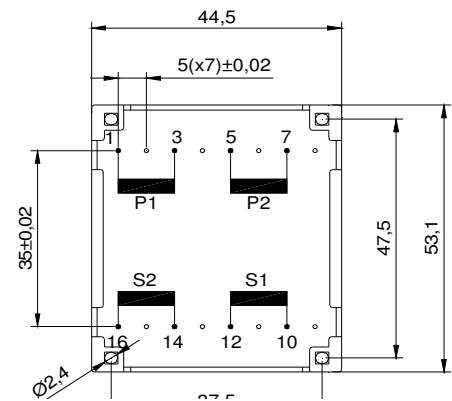

Primary connections

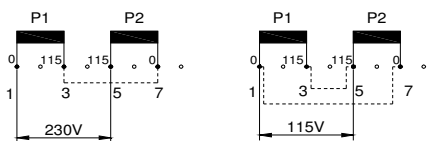
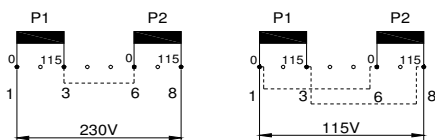

Secondary connections

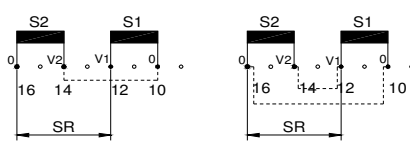
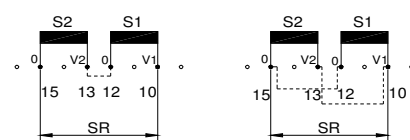

U30060xx

U30065xx

$$V_{sr} = V_1 + V_2$$

$$I_{sr} = I_1$$

$$V_{sr} = V_1$$

$$I_{sr} = I_1 + I_2$$

These models are non VDE approved. Even so, they meet all requirements of EN61558-2-4, EN61558-2-6



U3008 (UI 30/7,5)

4VA - Ta40°B

3,2VA - Ta70°B

weight - 160gr.



ENCAPSULATED TRANSFORMERS

www.efiter.com

According EN61558, EN60590, EN60472, UL506, UL1585, UL5085 · External protection

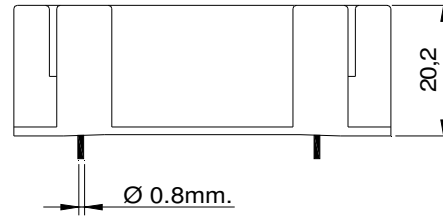
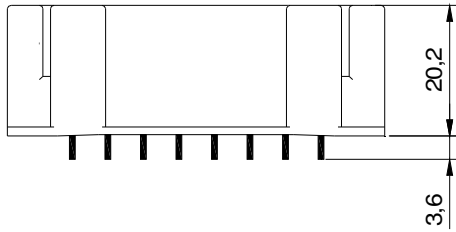

4VA. Ta°40B

| HR REFERENCE | | Vo/Vsec=1,5 Vo --> Is=0 Vsec --> Isec=In | | Prot. Prim. 230V: 32mA/T 115V: 63mA/T |
|--------------|----------|---|---------|---|
| U30080xx | U30085xx | Vsec | Isec | Prot. Sec. mA/F |
| U3008007 | U3008507 | 2x4,5V | 2x444mA | 2x500mA |
| U3008000 | U3008500 | 2x6V | 2x333mA | 2x400mA |
| U3008001 | U3008501 | 2x7,5V | 2x266mA | 2x315mA |
| U3008002 | U3008502 | 2x9V | 2x222mA | 2x250mA |
| U3008003 | U3008503 | 2x12V | 2x166mA | 2x200mA |
| U3008004 | U3008504 | 2x15V | 2x133mA | 2x160mA |
| U3008005 | U3008505 | 2x18V | 2x111mA | 2x125mA |
| U3008006 | U3008506 | 2x24V | 2x83mA | 2x100mA |

U30xx0xx

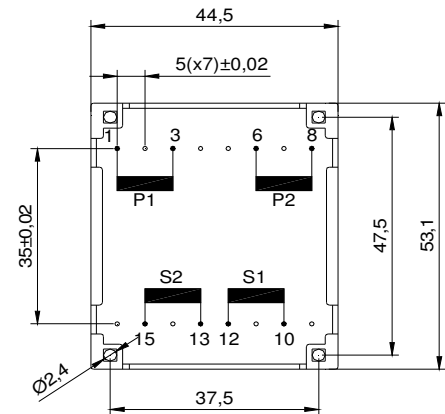

3,2VA. Ta°70B

| HR REFERENCE | | Vo/Vsec=1,5 Vo --> Is=0 Vsec --> Isec=In | | Prot. Prim. 230V: 32mA/T 115V: 63mA/T |
|--------------|----------|---|---------|---|
| U30080xx | U30085xx | Vsec | Isec | Prot. Sec. mA/F |
| U3008057 | U3008557 | 2x4,5V | 2x355mA | 2x400mA |
| U3008050 | U3008550 | 2x6V | 2x266mA | 2x315mA |
| U3008051 | U3008551 | 2x7,5V | 2x213mA | 2x250mA |
| U3008052 | U3008552 | 2x9V | 2x177mA | 2x200mA |
| U3008053 | U3008553 | 2x12V | 2x133mA | 2x160mA |
| U3008054 | U3008554 | 2x15V | 2x106mA | 2x125mA |
| U3008055 | U3008555 | 2x18V | 2x88mA | 2x100mA |
| U3008056 | U3008556 | 2x24V | 2x66mA | 2x80mA |

U30xx5xx

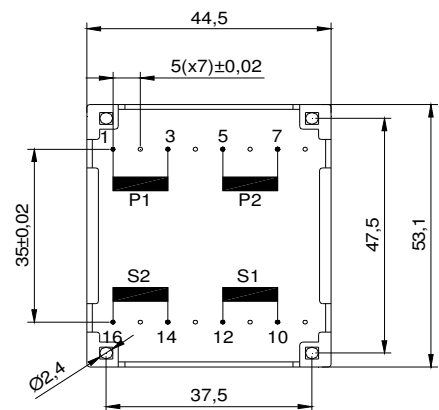

Primary connections

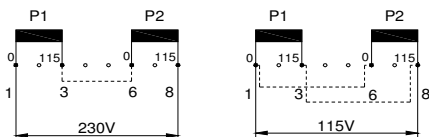

Secondary connections

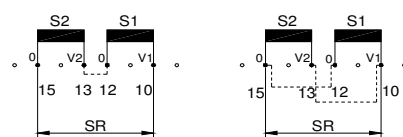

U30080xx

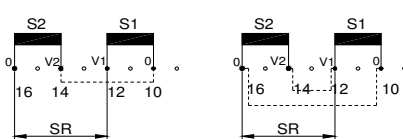
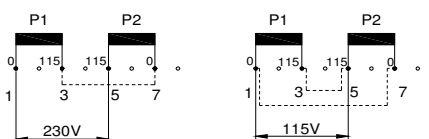

U30085xx

$$V_{sr}=V1+V2$$

$$I_{sr}=I1$$

$$V_{sr}=V1$$

$$I_{sr}=I1+I2$$

These models are non VDE approved. Even so, they meet all requirements of EN61558-2-4, EN61558-2-6



U3010 (UI 30/10,5)

6VA - Ta40°B

5VA - Ta70°B

weight - 190gr.



ENCAPSULATED TRANSFORMERS

www.efiter.com

According EN61558, EN60590, EN60472, UL506, UL1585, UL5085 · External protection

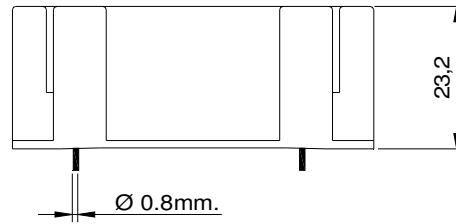
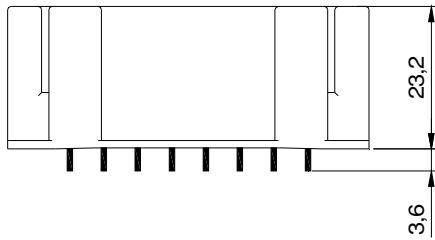

6VA. Ta40B

| HR REFERENCE | | Vo/Vsec=1,4 Vo --> Is=0 Vsec --> Isec=In | | Prot. Prim. 230V: 50mA/T 115V: 100mA/T |
|--------------|----------|---|---------|--|
| U30100xx | U30105xx | Vsec | Isec | Prot. Sec. mA/F |
| U3010007 | U3010507 | 2x4,5V | 2x666mA | 2x800mA |
| U3010000 | U3010500 | 2x6V | 2x500mA | 2x630mA |
| U3010001 | U3010501 | 2x7,5V | 2x400mA | 2x500mA |
| U3010002 | U3010502 | 2x9V | 2x333mA | 2x2400mA |
| U3010003 | U3010503 | 2x12V | 2x250mA | 2x315mA |
| U3010004 | U3010504 | 2x15V | 2x200mA | 2x250mA |
| U3010005 | U3010505 | 2x18V | 2x166mA | 2x200mA |
| U3010006 | U3010506 | 2x24V | 2x125mA | 2x160mA |

U30xx0xx

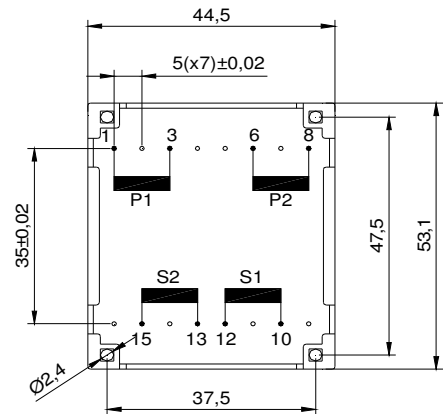

5VA. Ta70B

| HR REFERENCE | | Vo/Vsec=1,4 Vo --> Is=0 Vsec --> Isec=In | | Prot. Prim. 230V: 50mA/T 115V: 100mA/T |
|--------------|----------|---|---------|--|
| U30100xx | U30105xx | Vsec | Isec | Prot. Sec. mA/F |
| U3010057 | U3010557 | 2x4,5V | 2x555mA | 2x630mA |
| U3010050 | U3010550 | 2x6V | 2x416mA | 2x500mA |
| U3010051 | U3010551 | 2x7,5V | 2x333mA | 2x400mA |
| U3010052 | U3010552 | 2x9V | 2x277mA | 2x315mA |
| U3010053 | U3010553 | 2x12V | 2x208mA | 2x250mA |
| U3010054 | U3010554 | 2x15V | 2x166mA | 2x200mA |
| U3010055 | U3010555 | 2x18V | 2x138mA | 2x160mA |
| U3010056 | U3010556 | 2x24V | 2x104mA | 2x125mA |

U30xx5xx

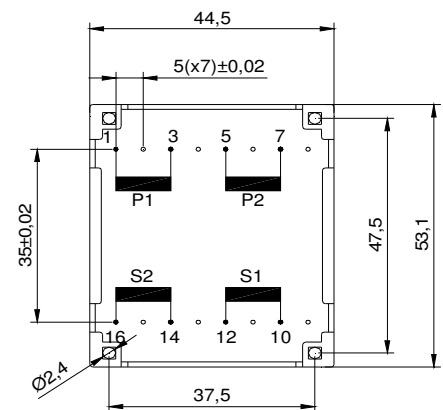

Primary connections

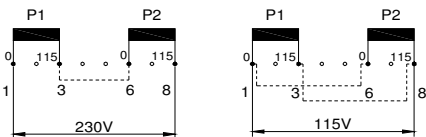

Secondary connections

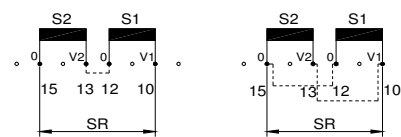

U30100xx

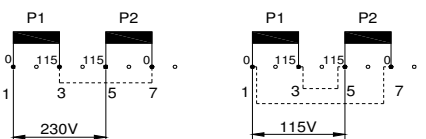

U30105xx

$$V_{sr} = V_1 + V_2$$

$$I_{sr} = I_1$$

$$V_{sr} = V_1$$

$$I_{sr} = I_1 + I_2$$

These models are non VDE approved. Even so, they meet all requirements of EN61558-2-4, EN61558-2-6



U3017 (UI 30/16,5)

10VA - Ta40°C

8VA - Ta70°C

weight - 270gr.



ENCAPSULATED TRANSFORMERS

www.efiter.com

According EN61558, EN60590, EN60472, UL506, UL1585, UL5085 · External protection

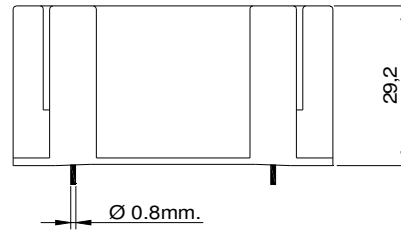
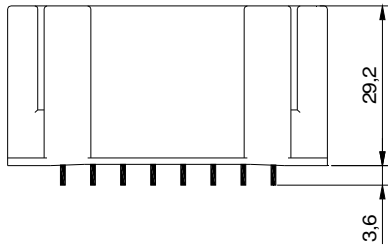

10VA. Ta40°C

| HR REFERENCE | | Vo/Vsec=1,45 Vo --> Is=0 Vsec --> Isec=In | | Prot. Prim. 230V: 63mA/T 115V: 125mA/T |
|--------------|----------|--|----------|--|
| U30170xx | U30175xx | Vsec | Isec | Prot. Sec. mA/F |
| U3017007 | U3017507 | 2x4,5V | 2x1111mA | 2x1250mA |
| U3017000 | U3017500 | 2x6V | 2x833mA | 2x1000mA |
| U3017001 | U3017501 | 2x7,5V | 2x666mA | 2x800mA |
| U3017002 | U3017502 | 2x9V | 2x555mA | 2x630mA |
| U3017003 | U3017503 | 2x12V | 2x416mA | 2x500mA |
| U3017004 | U3017504 | 2x15V | 2x333mA | 2x400mA |
| U3017005 | U3017505 | 2x18V | 2x277mA | 2x315mA |
| U3017006 | U3017506 | 2x24V | 2x208mA | 2x250mA |

U30xx0xx

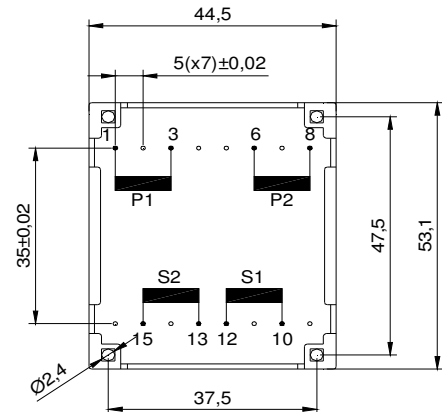

8VA. Ta70°C

| HR REFERENCE | | Vo/Vsec=1,45 Vo --> Is=0 Vsec --> Isec=In | | Prot. Prim. 230V: 63mA/T 115V: 125mA/T |
|--------------|----------|--|---------|--|
| U30170xx | U30175xx | Vsec | Isec | Prot. Sec. mA/F |
| U3017057 | U3017557 | 2x4,5V | 2x888mA | 2x1000mA |
| U3017050 | U3017550 | 2x6V | 2x666mA | 2x800mA |
| U3017051 | U3017551 | 2x7,5V | 2x533mA | 2x630mA |
| U3017052 | U3017552 | 2x9V | 2x444mA | 2x500mA |
| U3017053 | U3017553 | 2x12V | 2x333mA | 2x400mA |
| U3017054 | U3017554 | 2x15V | 2x266mA | 2x315mA |
| U3017055 | U3017555 | 2x18V | 2x222mA | 2x250mA |
| U3017056 | U3017556 | 2x24V | 2x166mA | 2x200mA |

U30xx5xx

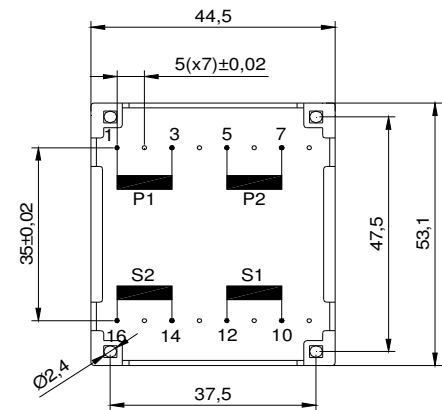

Primary connections

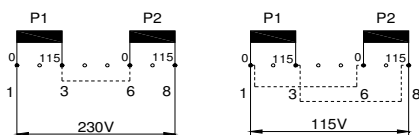

Secondary connections

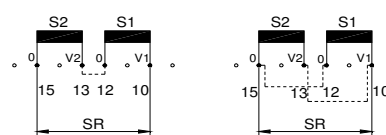

U30170xx

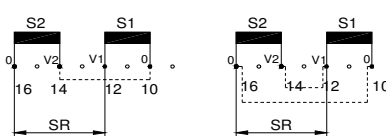
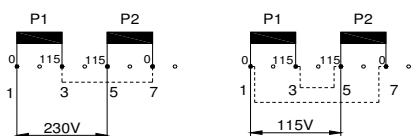

U30175xx

Vsr=V1+V2
Isr=I1

Vsr=V1
Isr=I1+I2

These models are non VDE approved. Even so, they meet all requirements of EN61558-2-4, EN61558-2-6



U3908 (UI 39/8)

10VA - Ta40°C

8VA - Ta70°C

weight - 290gr.



ENCAPSULATED TRANSFORMERS

www.efiter.com

According EN61558, EN60590, EN60472, UL506, UL1585, UL5085 · External protection

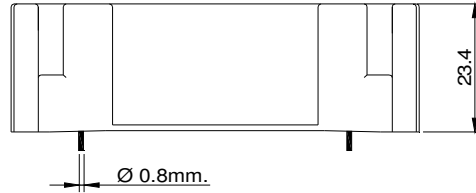
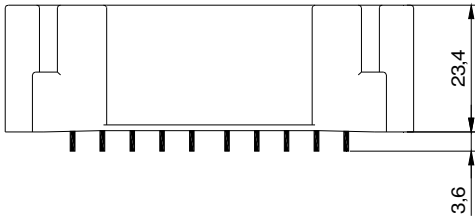

10VA. Ta40°C

| HR REFERENCE | | Vo/Vsec=1,45 Vo --> Is=0 Vsec --> Isec=In | | Prot. Prim. 230V: 63mA/T 115V: 125mA/T |
|--------------|----------|--|----------|--|
| U39080xx | U39085xx | Vsec | Isec | Prot. Sec. mA/F |
| U3908007 | U3908507 | 2x4,5V | 2x1111mA | 2x1250mA |
| U3908000 | U3908500 | 2x6V | 2x833mA | 2x1000mA |
| U3908001 | U3908501 | 2x7,5V | 2x666mA | 2x800mA |
| U3908002 | U3908502 | 2x9V | 2x555mA | 2x630mA |
| U3908003 | U3908503 | 2x12V | 2x416mA | 2x500mA |
| U3908004 | U3908504 | 2x15V | 2x333mA | 2x400mA |
| U3908005 | U3908505 | 2x18V | 2x277mA | 2x315mA |
| U3908006 | U3908506 | 2x24V | 2x208mA | 2x250mA |

U39xx0xx

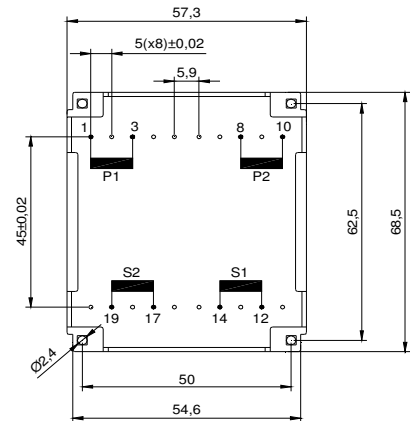

8VA. Ta70°C

| HR REFERENCE | | Vo/Vsec=1,45 Vo --> Is=0 Vsec --> Isec=In | | Prot. Prim. 230V: 63mA/T 115V: 125mA/T |
|--------------|----------|--|---------|--|
| U39080xx | U39085xx | Vsec | Isec | Prot. Sec. mA/F |
| U3908057 | U3908557 | 2x4,5V | 2x888mA | 2x1000mA |
| U3908050 | U3908550 | 2x6V | 2x666mA | 2x800mA |
| U3908051 | U3908551 | 2x7,5V | 2x533mA | 2x630mA |
| U3908052 | U3908552 | 2x9V | 2x444mA | 2x500mA |
| U3908053 | U3908553 | 2x12V | 2x333mA | 2x400mA |
| U3908054 | U3908554 | 2x15V | 2x266mA | 2x315mA |
| U3908055 | U3908555 | 2x18V | 2x222mA | 2x250mA |
| U3908056 | U3908556 | 2x24V | 2x166mA | 2x200mA |

U39xx5xx

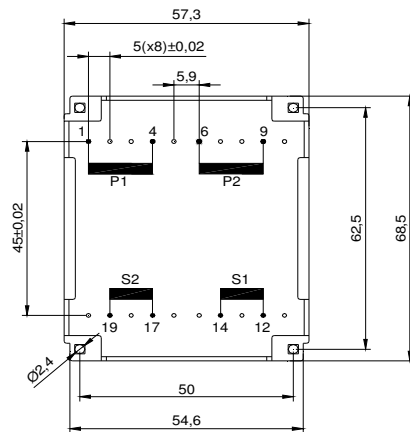

Primary connections

Secondary connections

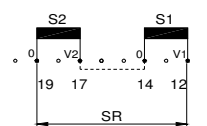
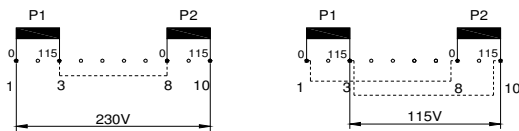

U39080xx

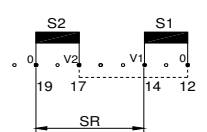
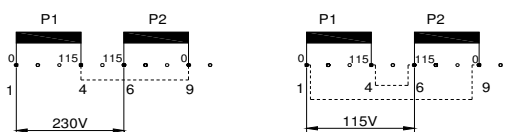

U39085xx

$$V_{sr} = V_1 + V_2$$

$$I_{sr} = I_1$$

$$V_{sr} = V_1$$

$$I_{sr} = I_1 + I_2$$

These models are non VDE approved. Even so, they meet all requirements of EN61558-2-4, EN61558-2-6



U3911 (UI 39/10,2)

14VA - Ta40°C

11VA - Ta70°C

weight - 345gr.



ENCAPSULATED TRANSFORMERS

www.efiter.com

According EN61558, EN60590, EN60472, UL506, UL1585, UL5085 · External protection

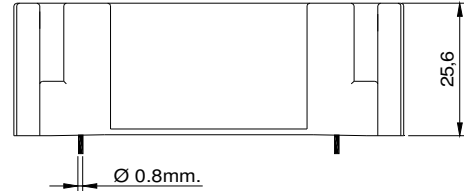
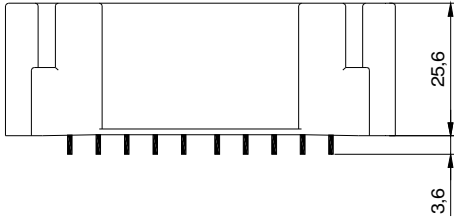

14VA. Ta^o40B

| HR REFERENCE | | Vo/Vsec=1,5 Vo --> Is=0 Vsec --> Isec=In | | Prot. Prim. 230V: 80mA/T 115V: 160mA/T |
|--------------|----------|---|----------|--|
| U39110xx | U39115xx | Vsec | Isec | Prot. Sec. mA/F |
| U3911007 | U3911507 | 2x4,5V | 2x1555mA | 2x1600mA |
| U3911000 | U3911500 | 2x6V | 2x1166mA | 2x1250mA |
| U3911001 | U3911501 | 2x7,5V | 2x933mA | 2x1000mA |
| U3911002 | U3911502 | 2x9V | 2x777mA | 2x800mA |
| U3911003 | U3911503 | 2x12V | 2x583mA | 2x630mA |
| U3911004 | U3911504 | 2x15V | 2x466mA | 2x500mA |
| U3911005 | U3911505 | 2x18V | 2x388mA | 2x400mA |
| U3911006 | U3911506 | 2x24V | 2x291mA | 2x315mA |

U39xx0xx

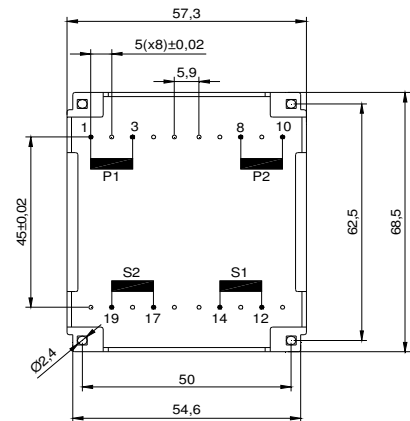

11VA. Ta^o70B

| HR REFERENCE | | Vo/Vsec=1,5 Vo --> Is=0 Vsec --> Isec=In | | Prot. Prim. 230V: 80mA/T 115V: 160mA/T |
|--------------|----------|---|----------|--|
| U39110xx | U39115xx | Vsec | Isec | Prot. Sec. mA/F |
| U3911057 | U3911557 | 2x4,5V | 2x1222mA | 2x1500mA |
| U3911050 | U3911550 | 2x6V | 2x916mA | 2x1000mA |
| U3911051 | U3911551 | 2x7,5V | 2x733mA | 2x800mA |
| U3911052 | U3911552 | 2x9V | 2x611mA | 2x630mA |
| U3911053 | U3911553 | 2x12V | 2x458mA | 2x500mA |
| U3911054 | U3911554 | 2x15V | 2x366mA | 2x400mA |
| U3911055 | U3911555 | 2x18V | 2x305mA | 2x315mA |
| U3911056 | U3911556 | 2x24V | 2x229mA | 2x250mA |

U39xx5xx

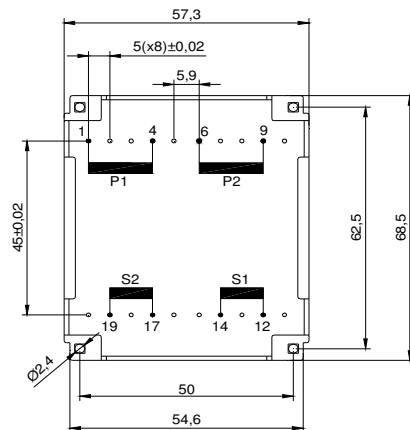

Primary connections

Secondary connections

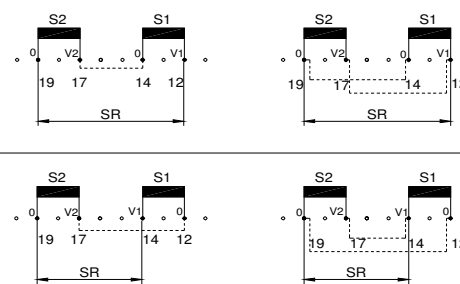
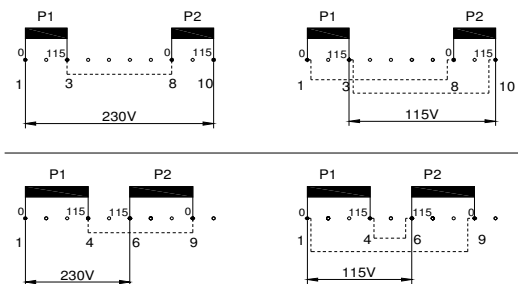

U39110xx

U39115xx

$$V_{sr} = V_1 + V_2$$

$$I_{sr} = I_1$$

$$V_{sr} = V_1$$

$$I_{sr} = I_1 + I_2$$

These models are non VDE approved. Even so, they meet all requirements of EN61558-2-4, EN61558-2-6



U3914 (UI 39/13,5)

18VA - Ta40°C

15VA - Ta70°C

weight - 415gr.



ENCAPSULATED TRANSFORMERS

www.efiter.com

According EN61558, EN60590, EN60472, UL506, UL1585, UL5085 · External protection

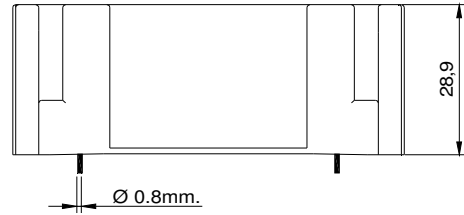
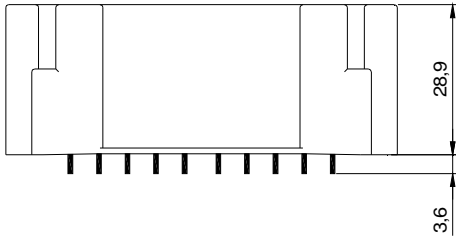

18VA. Ta40°C

| HR REFERENCE | | Vo/Vsec=1,35 Vo --> Is=0 Vsec --> Isc=In | | Prot. Prim. 230V: 100mA/T 115V: 200mA/T |
|--------------|----------|---|----------|---|
| U39140xx | U39145xx | Vsec | Isec | Prot. Sec. mA/F |
| U3914007 | U3914507 | 2x4,5V | 2x2000mA | 2x2500mA |
| U3914000 | U3914500 | 2x6V | 2x1500mA | 2x2000mA |
| U3914001 | U3914501 | 2x7,5V | 2x1200mA | 2x1500mA |
| U3914002 | U3914502 | 2x9V | 2x1000mA | 2x1250mA |
| U3914003 | U3914503 | 2x12V | 2x750mA | 2x800mA |
| U3914004 | U3914504 | 2x15V | 2x600mA | 2x630mA |
| U3914005 | U3914505 | 2x18V | 2x500mA | 2x630mA |
| U3914006 | U3914506 | 2x24V | 2x375mA | 2x400mA |

U39xx0xx

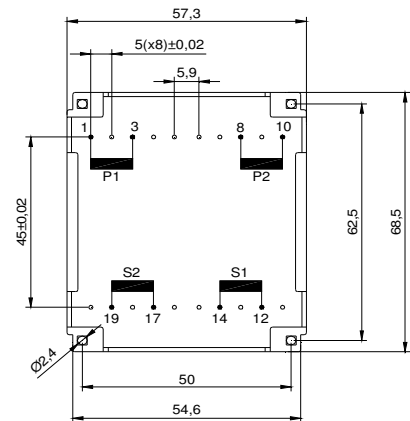

15VA. Ta70°C

| HR REFERENCE | | Vo/Vsec=1,35 Vo --> Is=0 Vsec --> Isc=In | | Prot. Prim. 230V: 100mA/T 115V: 200mA/T |
|--------------|----------|---|----------|---|
| U39140xx | U39145xx | Vsec | Isec | Prot. Sec. mA/F |
| U3914057 | U3914557 | 2x4,5V | 2x1666mA | 2x2000mA |
| U3914050 | U3914550 | 2x6V | 2x1250mA | 2x1500mA |
| U3914051 | U3914551 | 2x7,5V | 2x1000mA | 2x1250mA |
| U3914052 | U3914552 | 2x9V | 2x833mA | 2x1000mA |
| U3914053 | U3914553 | 2x12V | 2x625mA | 2x800mA |
| U3914054 | U3914554 | 2x15V | 2x500mA | 2x630mA |
| U3914055 | U3914555 | 2x18V | 2x416mA | 2x500mA |
| U3914056 | U3914556 | 2x24V | 2x312mA | 2x400mA |

U39xx5xx

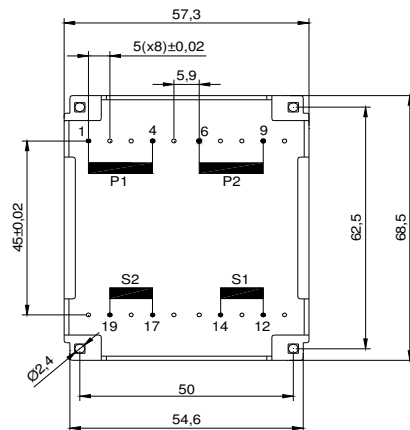

Primary connections

Secondary connections

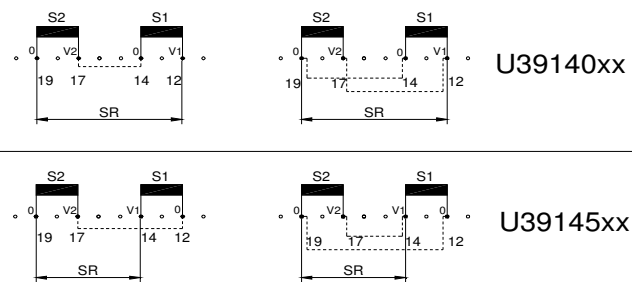
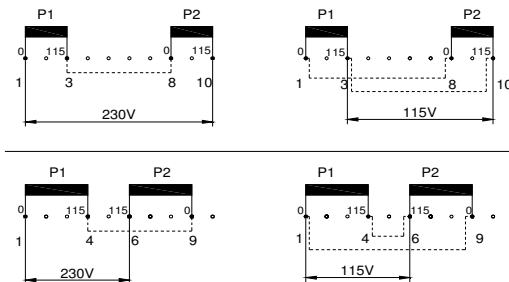

Vsr=V1+V2
Isr=I1

Vsr=V1
Isr=I1+I2

These models are non VDE approved. Even so, they meet all requirements of EN61558-2-4, EN61558-2-6



U3917 (UI 39/17)

24VA - Ta40°C

20VA - Ta70°C

weight - 490gr.



ENCAPSULATED TRANSFORMERS

www.efiter.com

According EN61558, EN60590, EN60472, UL506, UL1585, UL5085 · External protection

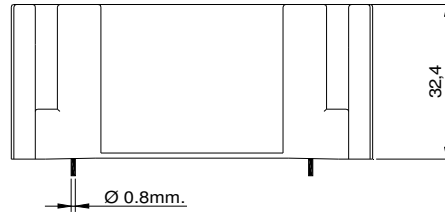
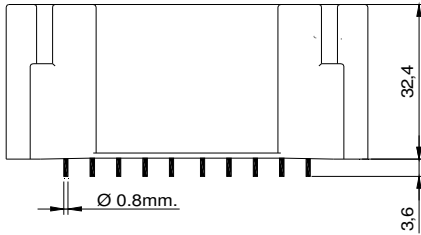

24VA. Ta^o40B

| HR REFERENCE | | Vo/Vsec=1,3 Vo --> Is=0 Vsec --> Isec=In | | Prot. Prim. 230V: 125mA/T 115V: 250mA/T |
|--------------|----------|---|----------|---|
| U39140xx | U39145xx | Vsec | Isec | Prot. Sec. mA/F |
| U3917007 | U3917507 | 2x4,5V | 2x2666mA | 2x3150mA |
| U3917000 | U3917500 | 2x6V | 2x2000mA | 2x2500mA |
| U3917001 | U3917501 | 2x7,5V | 2x1600mA | 2x2000mA |
| U3917002 | U3917502 | 2x9V | 2x1333mA | 2x1600mA |
| U3917003 | U3917503 | 2x12V | 2x1000mA | 2x1250mA |
| U3917004 | U3917504 | 2x15V | 2x800mA | 2x1000mA |
| U3917005 | U3917505 | 2x18V | 2x666mA | 2x800mA |
| U3917006 | U3917506 | 2x24V | 2x500mA | 2x630mA |

U39xx0xx

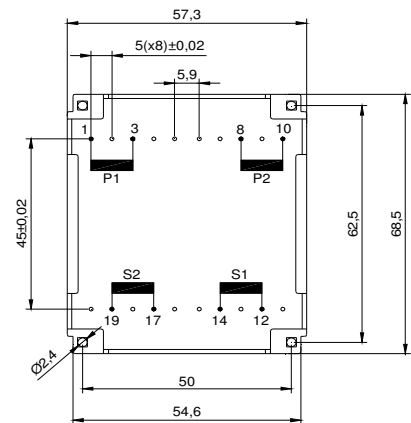

20VA. Ta^o70B

| HR REFERENCE | | Vo/Vsec=1,3 Vo --> Is=0 Vsec --> Isec=In | | Prot. Prim. 230V: 125mA/T 115V: 250mA/T |
|--------------|----------|---|----------|---|
| U39140xx | U39145xx | Vsec | Isec | Prot. Sec. mA/F |
| U3917057 | U3917557 | 2x4,5V | 2x2222mA | 2x2500mA |
| U3917050 | U3917550 | 2x6V | 2x1666mA | 2x2000mA |
| U3917051 | U3917551 | 2x7,5V | 2x1333mA | 2x1600mA |
| U3917052 | U3917552 | 2x9V | 2x1111mA | 2x1250mA |
| U3917053 | U3917553 | 2x12V | 2x833mA | 2x1000mA |
| U3917054 | U3917554 | 2x15V | 2x666mA | 2x800mA |
| U3917055 | U3917555 | 2x18V | 2x555mA | 2x630mA |
| U3917056 | U3917556 | 2x24V | 2x416mA | 2x500mA |

U39xx5xx

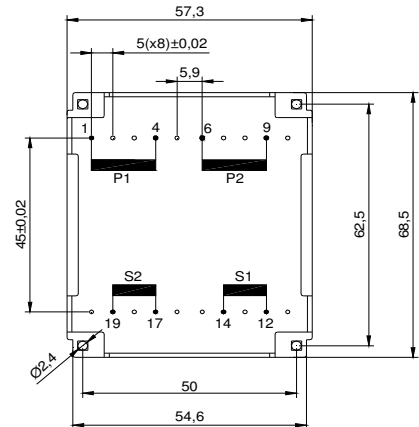

Primary connections

Secondary connections

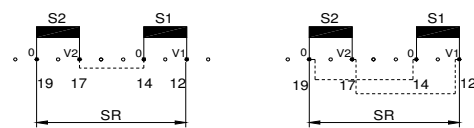
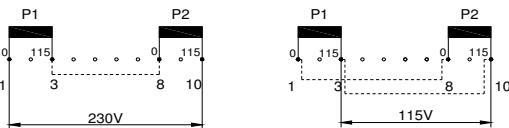

U39170xx

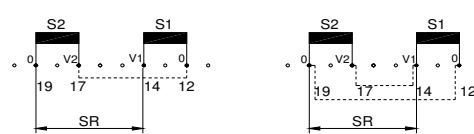
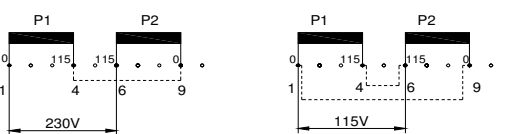

U39175xx

Vsr=V1+V2
Isr=I1

Vsr=V1
Isr=I1+I2

These models are non VDE approved. Even so, they meet all requirements of EN61558-2-4, EN61558-2-6



U3921 (UI 39/21)

30VA - Ta40°B
24VA - Ta70°B

weight - 545gr.



ENCAPSULATED TRANSFORMERS

www.efiter.com

According EN61558, EN60590, EN60472, UL506, UL1585, UL5085 · External protection

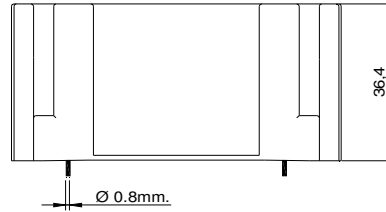
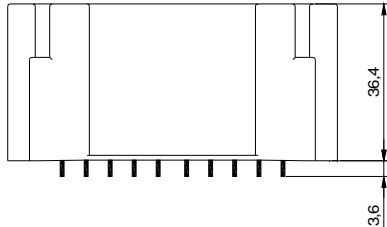

30VA. Ta°40B

| HR REFERENCE | | Vo/Vsec=1,2 Vo --> Is=0 Vsec --> Isc=In | | Prot. Prim. 230V: 160mA/T 115V: 315mA/T |
|--------------|----------|--|----------|---|
| U39140xx | U39145xx | Vsec | Isec | Prot. Sec. mA/F |
| U3921007 | U3921507 | 2x4,5V | 2x3333mA | 2x4000mA |
| U3921000 | U3921500 | 2x6V | 2x2500mA | 2x3150mA |
| U3921001 | U3921501 | 2x7,5V | 2x2000mA | 2x2500mA |
| U3921002 | U3921502 | 2x9V | 2x1666mA | 2x2000mA |
| U3921003 | U3921503 | 2x12V | 2x1250mA | 2x1600mA |
| U3921004 | U3921504 | 2x15V | 2x1000mA | 2x1250mA |
| U3921005 | U3921505 | 2x18V | 2x833mA | 2x1000mA |
| U3921006 | U3921506 | 2x24V | 2x625mA | 2x800mA |

U39xx0xx

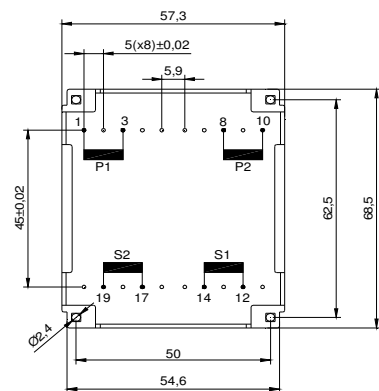

24VA. Ta°70B

| HR REFERENCE | | Vo/Vsec=1,2 Vo --> Is=0 Vsec --> Isc=In | | Prot. Prim. 230V: 160mA/T 115V: 315mA/T |
|--------------|----------|--|----------|---|
| U39140xx | U39145xx | Vsec | Isec | Prot. Sec. mA/F |
| U3921057 | U3921557 | 2x4,5V | 2x2666mA | 2x3150mA |
| U3921050 | U3921550 | 2x6V | 2x2000mA | 2x2500mA |
| U3921051 | U3921551 | 2x7,5V | 2x1600mA | 2x2000mA |
| U3921052 | U3921552 | 2x9V | 2x1333mA | 2x1600mA |
| U3921053 | U3921553 | 2x12V | 2x1000mA | 2x1250mA |
| U3921054 | U3921554 | 2x15V | 2x800mA | 2x1000mA |
| U3921055 | U3921555 | 2x18V | 2x666mA | 2x800mA |
| U3921056 | U3921556 | 2x24V | 2x500mA | 2x630mA |

U39xx5xx

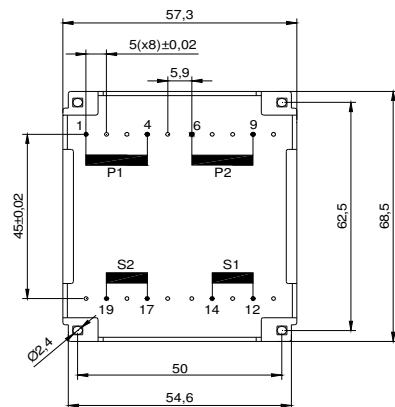

Primary connections

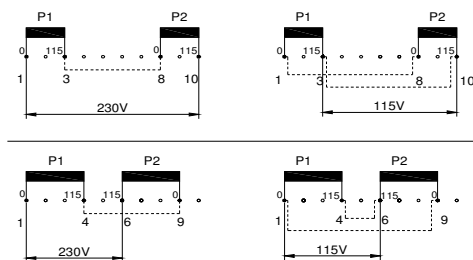

Secondary connections

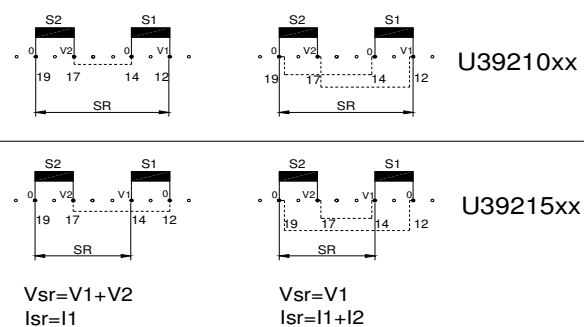

These models are non VDE approved. Even so, they meet all requirements of EN61558-2-4, EN61558-2-6